



Type :

Project :

Catalog # :

LH5 - STANDARD NEW CONSTRUCTION HOUSING

5" LINE VOLTAGE HOUSINGS

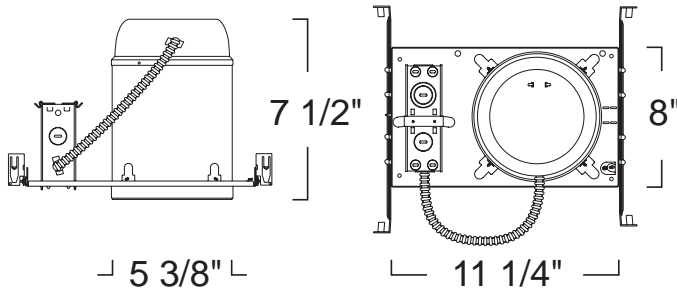

Standard: 75W PAR30/R30, 50W R20/PAR20, 75W A19
IC: 75W PAR30/R30, 50W R20/PAR20, 40W A19

FEATURE(S):



SPECIFICATION

Ceiling cut-out: 5 3/4"

120V R30/PAR30/A19 MED E26

Application: General purpose recessed downlight housing for medium to high ceilings for residential and light commercial applications. A variety of trims, compatible styles and finishes are available to achieve the proper décor and illumination.

Housing: Pre-wired housing adjusts up to a 1 1/2" ceiling thickness. Integral thermal protector to guard against improper lamping and installation. Housing provides an adjustable socket plate which allows for use of different lamp types. Trim is secured with torsion wing springs/standard coil springs or serrated clips.

Mounting: Housing suitable for new construction installations only, supplied with (2) 24" adjustable hanger bars with 90 degrees repositioning ability. Hanger bars equipped with nail-less install 3/4" serrated barbed studs and with captive nails, for faster and easier mounting in wood joists. Set-screws lock into position and prevent shifting after installation. Earthquake structural cable compatible for drop panel ceiling or any other mounting that requires direct support from structural ceilings.

Socket: Standard porcelain medium screw base socket with high temperature leads.

Junction Box: 16 gauge pre-wired galvanized steel Junction Box, 32 cubic-inch for a maximum of (8) #12 AWG wires. Furnished with (7) 3/4" and (4) Romex knock-outs. Strain clamps to install or remove covers for easy access and ground wire. Equipped with safety standard fitting for flex-conduit.

Insulation Contact: Non IC rated housing must be kept 3" from insulation. IC rated housing rated for direct contact with low to medium density loosefill blown and rolled insulation. For use with high density loose fill blown insulation, reduce rated lamp wattage accordingly (roughly %15-%20).

Airflow: Airtight option is designed to restrict air flow from room into plenums in compliance to the WSEC - Washington State Energy Code, (Less than 2.0 CFM -Cubic Feet per Minute). Complies to Title24 air flow requirements (Air-tight).

Safety Labels: UL/CUL listed for through-branch wiring (8) No.12 AWG 90°C and suitable for damp locations. NYC approved: Calendar #41937.

Label: U.L. Listed, E.T.L. Listed

COMPATIBILITY

 LR502 BAFFLE W/ CLEAR REFLECTOR	 LR503 METAL BAFFLE W/ BRACKETS	 LR521 REFLECTOR (CONE)
 LR531 ALBALITE SHOWER TRIM	 LR540 FROSTED SHOWER DOME	 LR541 SELF FLANGED REFLECTOR
 LR543 METAL BAFFLE	 LR569 ADJUSTABLE GIMBAL	 LR573 ADJUSTABLE EYEBALL
 LR576 ADJUSTABLE REGRESSED GIMBAL	 LR577 ADJUSTABLE GIMBAL W/ BAFFLE	 LR578 ADJUSTABLE SNOOT SPOT W/ BAFFLE
 LR581 GIMBAL	 LR588 ADJUSTABLE SPOT W/ BAFFLE	 LRD578 5" ADJUSTABLE REGRESSED L.E.D. GIMBAL RETROFIT

Please see website for more compatible items.

Note: Wattage limitations on compatible items must be met.

ORDERING

ORDERING EXAMPLE : LH5

LH5	RATING	WATTAGE	VOLTAGE
LH5	Blank: Standard ICA :IC-Airtight	Blank:75W	Blank:120V