

LHLD6 - 6" IC L.E.D. HOUSING

6" L.E.D. HOUSINGS

PROJECT INFORMATION

Type :

Project :

Catalog # :

FEATURE(S):

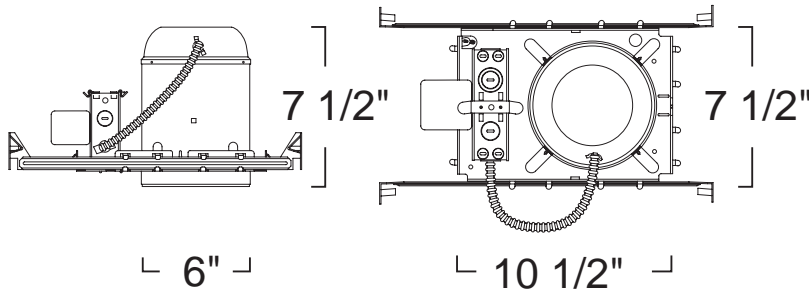

SPECIFICATION

Ceiling cut-out: 6 1/2"

L.E.D. 15W Max

Housing: Pre-wired housing adjusts up to a 1 1/2" ceiling thickness. Integral thermal protector to guard against improper lamping and installation. Housing provides an adjustable socket plate which allows for use of different lamp types. Trim is secured with torsion wing springs/standard coil springs.

Mounting: Housing suitable for new construction installations only, supplied with (2) 24" adjustable hanger bars with 90 degrees repositioning ability. Hanger bars equipped with nail-less install 3/4" serrated barbed studs and with captive nails, for faster and easier secure mounting in wood joists. Set-screws lock into position and prevent shifting after installation. Earthquake structural cable compatible for drop panel ceiling or any other mounting that requires direct support from structural ceilings.

Power Connection: LED heat sinked lamp module is replaceable via on board quick disconnect terminal. No tools required.

Driver: Electronic Direct Current U.L. Listed driver mounted away from LED Array for cool operation and end-of-life modularity. Comes stand with 120VAC input, available with optional 120V/277V universal voltage input.

Incandescent dimming option (-DIN) works with standard Incandescent dimmers.
Factory qualified for use with Wattstopper Brand Dimmer: DCD267, smoothly dims down to 0.1%.

Low Voltage dimming option (-DLV) works with standard Electronic Low Voltage Dimmers.
Factory qualified for use with LUTRON Brand Dimmers: SELV-300P, DVELV-300P, MAELV-600, NELV-450 along with 3-Way versions. (-DLV) Dimming Option also compatible with Grafik Eye Dimming Interface ELVI-1000, smoothly dims down as low as 10% of initial light output with flicker-free operation.

Junction Box: 16 gauge pre-wired galvanized steel Junction Box, 32 cubic-inch for a maximum of (8) #12 AWG wires. Furnished with (7) 3/4" and (4) Romex knock-outs. Strain clamps to install or remove covers for easy access and ground wire. Equipped with safety standard fitting for flex-conduit.

Insulation Contact: Energy Efficient L.E.D. housing comes standard with IC rating for direct contact with loosefill blown and rolled insulation.

Safety Labels: ETL/CETL listed. Suitable for damp locations. NYC approved: Calendar #41937.

COMPATIBILITY

 LRLD621 DEEP L.E.D. REFLECTOR	 LRLD642 L.E.D. DECOFROST DOME	 LRLD649 REGRESSED DECO CONE
 LRLD677 OPEN HEAT SINK GIMBAL L.E.D.	 LRLD678 CONCEALED L.E.D. HEAT SINK GIMBAL L.E.D.	 LRLD693 DEEP L.E.D. BAFFLE

Note: Wattage limitations on compatible items must be met.

ORDERING

ORDERING EXAMPLE : LHLD615C70-DIN

LHLD6	WATTAGE
LHLD6	10C50 :10W
	15C70 :15W
	10C50-DLV :10W Low Voltage Dimming
	15C70-DLV :15W Low Voltage Dimming
	10C50UE :10W (120V/277V)
	15C70UE :15W (120V/277V)
	15C70-DHL :15W Hi-Lume Dimming
	15C70-DIN :2-Wire Incandescent Dimming