

LHALD612 - 6" ARCHITECTURAL LED FRAME-KIT (1200/1600 LUMEN) 6" ARCHITECTURAL DOWNLIGHT

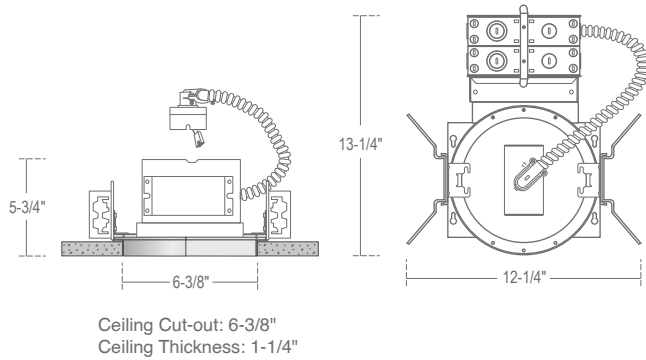

SPECIFICATION

12W LED

Application: Architectural-grade recessed LED downlight housing for medium to high ceilings in commercial and architectural spaces.

Housing Frame: 16 gauge galvanized plaster ring with black powder coat finish, friction or V-Spring clips secure trim to housing.

Mounting: Housing suitable for new construction installations only, Bat-Wing bar hanger brackets adjust vertically 3 1/4" for multiple ceiling types and accepts 1/2" EMT. 26" C-Channel Strut for T-bar ceilings and 27" adjustable linear hanger bars for plaster ceilings or wood/metal joists. Heavy duty 16-gauge, die-formed galvanized steel. Bar hangers optional.

Driver: 120V/277V AC 50/60Hz Electronic Direct Current Class 2 driver integrally mounted on large access Junction Box. Power Factor > 0.90. Operating Temperature: -10°C to +80°C. Accessible from above or below ceiling. Consult Factory for dimming options and compatible dimmers.

Emergency Options: Emergency LED Battery Back-up available, remotely mounted adjacent to housing by installer. When AC power fails, the device immediately switches to the emergency mode, operating the LEDs for a minimum of 90 minutes. Remote test switch and plate cover included. Optional Generator Transfer Device switches the driver to auxiliary generator power during the loss of normal AC power, (recommended for applications requiring individual circuit switching).

Junction Box: 16 gauge pre-wired galvanized steel double Junction Box, 64 cubic-inch for a maximum of (8) #12 AWG wires. Furnished with (10) 3/4", (2) 1" and (8) Romex knock-outs. Strain clamps to install or remove covers for easy access and ground wire. Equipped with safety standard die-cast aluminum fitting for flex-conduit.

Insulation Contact: Non-IC rated housing must be kept 3" from insulation.







Dimming: 0-10V dimming option (-D10) works with most 0-10V dimmers. Factory qualified for use with Leviton IP710-DLX and Lutron NTFTV-WH. The Lutron Hi-Lume 1% dimming option (-DHL) works with compatible Lutron dimmers: NovaT NTF-10-277, Skylark SF-12P277 & Verti VTF-6A.

Warranty: Covered by a 5 Year Warranty to be free of defects in materials and craftsmanship. Recommended for applications where ambient temperatures do not exceed 35°C, installations exceeding this temperature will result in reduced LED lamp life and a voided warranty.

Caution: LITON recommends use of surge protectors on the power entering LED Housings. Surge damage is not covered by warranty.



COMPATIBILITY

 LRALD6 6" ARCHITECTURAL LED TRIM (1200LM/1600LM)	 LRCLD6 6" SHALLOW LED TRIM (1200/1900 LUMEN)	 LRALD6021 6" ARCHITECTURAL LED GLASS DECO OPEN (1200LM/1600LM)
 LRALD6031 6" ARCHITECTURAL LED GLASS DECO FULL (1200LM/1600LM)	 LRALD6321 6" DROP GLASS LED TRIM (1200LM/1600LM)	 C260-J ADJUSTABLE C-CHANNEL HANGER BAR SET
C260 C-CHANNEL HANGER BAR SET		

Note: Wattage limitations on compatible items must be met.

Benefit:

- Only consumes 12W!
- Super-efficient lumen package delivers over 100 Lumens per Watt (LPW).
- Uses less than 75W to deliver over 35 FC to a 16' x 12' room with a 9' ceiling.
- Achieves less than 0.4W/Sq. Ft (LPD)
- All standard dimming options including incandescent, 0-10V and ELV are available.

FEATURE:



ORDERING EXAMPLE : LHALD612C035UE-D10P1/C260

LHALD612	DRIVER TYPE	OPTION	HANGER BAR
LHALD612	C035UE :120V/277V Non-Dimming	Blank :None	/C260 :C-Channel Hanger Bar Set
	C035UE-D10 :120V/277V 0-10V Dimming	-EM2 :Emergency (10W)	/C260-J :Adjustable C-Channel Hanger Bar Set
	C035UE-DHL :Hi-Lume Dimming (120V/277V)	-GTD :Generator Transfer Device	
	C035UE-DUN :120V/277 (2-WIRE,ELV,0-10V)		
	C035-347-D10 :347V 0-10V 10% Dimming		
	C035UE-D10P1 :0-10V 1% Dimming		