

LHX4LV - LOW VOLTAGE HOUSING

LOW VOLTAGE

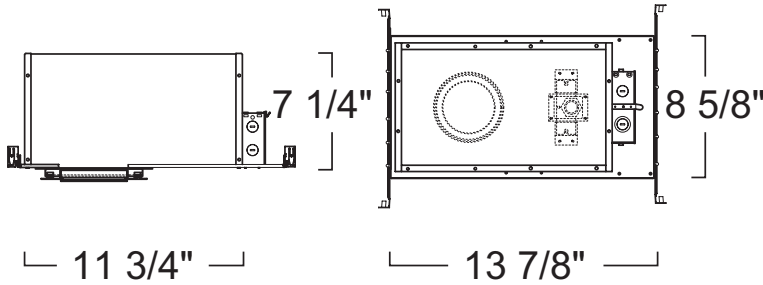

SPECIFICATION

Application: Architectural-grade recessed "Trimless" downlight for low to medium height ceilings for residential commercial installations. Trimless design provides a clean unobstructed "zero-sight" line ceiling. Die-Cast aluminum plaster frame disc installed on housing for easy installation. A variety of trims compatible styles and finishes are available to achieve the proper décor and illumination.

Housing: Pre-wired housing with Die-Cast adjustment plate with pre-set ceiling thickness for easy installation in 1/2", 5/8", 3/4" and 1 inch ceilings. Integral thermal protector to guard against improper lamping and installation. Housing provides an adjustable socket plate which allows for use of different lamp types. Trim is secured with QuickLok mounting mechanism for an easy scratch free installation.

Mounting: Housing suitable for new construction installations only, supplied with (2) 24" adjustable hanger bars with 90 degrees repositioning ability. Hanger bars equipped with nail-less install 3/4" serrated barbed studs and with captive nails, for faster and easier secure mounting in wood joists. Set-screws lock into position and prevent shifting after installation. Earthquake structural cable compatible for drop panel ceiling or any other mounting that requires direct support from structural ceilings.

Transformer: Class 2 Noise-Free Electronic transformer installed adjacent to Junction Box, bottom and top accessible. Dimmable with dimmers designed for Electronic Low Voltage Loads. Thermally protected rated for 90° C.

Socket: 2-pin porcelain socket with aluminum heat sink plate. Lamp clips to trim to ensure proper and consistent positioning.

Junction Box: 16 gauge pre-wired galvanized steel Junction Box, 32 cubic-inch for a maximum of (8) #12 AWG wires. Furnished with 3/4", 1" and Romex knock-outs. Strain clamps to install or remove covers for easy access and ground wire. Equipped with safety standard fitting for flex-conduit.

Insulation Contact: Non IC rated housing must be kept 3" from insulation. IC rated housing rated for direct contact with low to medium density loosefill blown and rolled insulation. For use with high density loose fill blown insulation, reduce rated lamp wattage accordingly (roughly %15-%20).

Safety Labels: ETL/CETL listed. Suitable for damp locations. NYC approved: Calendar #41937.

Light Source: Available in 12V 50W Bi-Pin MR16, 12V 50W Bi-Pin MR16 (Insulation Contact, Airtight), 12V 75W Bi-Pin MR16, 12V 75W Bi-Pin MR16 (277V and Electronic).

Label: cETL Listed

Assembled in USA

COMPATIBILITY

 LRX473 ADJUSTABLE ACCENT	 C260 C-CHANNEL HANGER BAR SET	 LRX475 FIXED WALL WASH
 LRX421 REFLECTOR CONE	 L270 LINEAR HANGER BAR SET	 LRX419 PINHOLE
 LRX422 FROSTED LENS	 LRX420 SLOT	 LRX475 FIXED WALL WASH

Note: Wattage limitations on compatible items must be met.

2016:6-14

FEATURE:



ORDERING EXAMPLE : LHX4LVICA

LHX4LV	LIGHT SOURCE
LHX4LV	Blank : 12V 50W Bi-Pin MR16
	75 : 12V 75W Bi-Pin MR16
	75-27 : 12V 75W Bi-Pin MR16 (277V , Electronic)
	ICA : 12V 50W Bi-Pin MR16 (Insulation Contact, Airtight)

ID#: 2162