

LHXLD4 - 3.5" PHANTOM LED TRIMLESS HOUSING LED PHANTOM

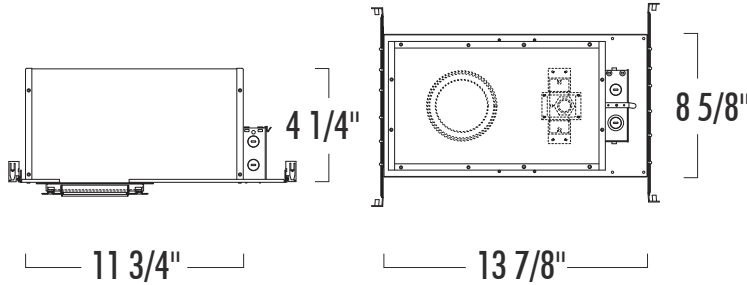

19W
ENERGY USED
IN WATTAGE



SPECIFICATION

19W LED

Application: Architectural-grade recessed "Trimless" downlight for low to medium height ceilings for residential commercial installations. Trimless design provides a clean unobstructed "zero-sight" line ceiling. Die-Cast aluminum plaster frame disc installed on housing for easy installation. A variety of trims compatible styles and finishes are available to achieve the proper décor and illumination.

Housing: Pre-wired housing with Die-Cast adjustment plate with pre-set ceiling thickness for easy installation in 1/2", 5/8", 3/4" and 1 inch ceilings. Integral thermal protector to guard against improper lamping and installation. Housing provides an adjustable socket plate which allows for use of different lamp types. Trim is secured with QuickLok mounting mechanism for an easy scratch free installation.

Mounting: Housing suitable for new construction installations only, supplied with (2) 24" adjustable hanger bars with 90 degrees repositioning ability. Hanger bars equipped with nail-less install 3/4" serrated barbed studs and with captive nails, for faster and easier secure mounting in wood joists. Set-screws lock into position and prevent shifting after installation. Earthquake structural cable compatible for drop panel ceiling or any other mounting that requires direct support from structural ceilings.

Driver: Electronic Constant Current driver integrally mounted in fixture. Easily accessible from below ceiling.

Dimming: 0-10V dimming option (-D10) works with most 0-10V dimmers. Factory qualified for use with Leviton IP710-DLX and Lutron NTFTV-WH. The Lutron Hi-Lume 1% dimming option (-DHL) works with compatible Lutron dimmers: NovaT NTF-10-277, Skylark SF-12P277 & Viertel VTF-6A. **Uni-Dim™** is a universal dimming system that works with most ELV, Incandescent and 0-10V fluorescent dimmers.

Connector: Housing supplied with Thermo Plastic Quick Connector.

Junction Box: 16 gauge pre-wired galvanized steel Junction Box, 32 cubic-inch for a maximum of (8) #12 AWG wires. Furnished with 3/4", 1" and Romex knock-outs. Strain clamps to install or remove covers for easy access and ground wire. Equipped with safety standard fitting for flex-conduit.

Insulation Contact: Non IC rated housing must be kept 3" from insulation.

Safety Labels: ETL/CETL listed. Suitable for damp locations. NYC approved: Calendar #41937.

Caution: LITON recommends use of surge protectors on the power entering LED Housings. Surge damage is not covered by warranty.

COMPATIBILITY

 LRX4LH19	 LRX4LH22	 LRX4LH20
3.5" 19W LED TRIMLESS PINHOLE	3.5" 19W LED TRIMLESS FROSTED LENS	3.5" 19W LED TRIMLESS SLOT
 LRX4LH21	 LRX4LH73	
3.5" 19W LED TRIMLESS REFLECTOR CONE	3.5" 19W LED TRIMLESS ADJUSTABLE ACCENT	

Note: Wattage limitations on compatible items must be met.

Label: cETL Listed

Assembled in USA

Benefit:

- 277V input option.
- Emergency back-up option.
- Driver mounted away from LED for cooler operation.

Title 24/JA8 Compliant

- LHXLD419C70_/LRX4LH19_-T27
- LHXLD419C70_/LRX4LH19_-T30
- LHXLD419C70_/LRX4LH19_-T40
- LHXLD419C70_/LRX4LH22_-T27
- LHXLD419C70_/LRX4LH22_-T30
- LHXLD419C70_/LRX4LH22_-T40
- LHXLD419C70_/LRX4LH20_-T27
- LHXLD419C70_/LRX4LH20_-T30
- LHXLD419C70_/LRX4LH20_-T40
- LHXLD419C70_/LRX4LH21_-T27
- LHXLD419C70_/LRX4LH21_-T30
- LHXLD419C70_/LRX4LH21_-T40
- LHXLD419C70_/LRX4LH73_-T27
- LHXLD419C70_/LRX4LH73_-T30
- LHXLD419C70_/LRX4LH73_-T40
- LHXLD419C70_/LRX4LH19_-T27
- LHXLD419C70_/LRX4LH19_-T30
- LHXLD419C70_/LRX4LH19_-T40
- LHXLD419C70_/LRX4LH22_-T27
- LHXLD419C70_/LRX4LH22_-T30
- LHXLD419C70_/LRX4LH22_-T40
- LHXLD419C70_/LRX4LH20_-T27
- LHXLD419C70_/LRX4LH20_-T30
- LHXLD419C70_/LRX4LH20_-T40
- LHXLD419C70_/LRX4LH21_-T27
- LHXLD419C70_/LRX4LH21_-T30
- LHXLD419C70_/LRX4LH21_-T40
- LHXLD419C70_/LRX4LH73_-T27
- LHXLD419C70_/LRX4LH73_-T30
- LHXLD419C70_/LRX4LH73_-T40

2025.04.23

FEATURE:



ORDERING EXAMPLE : LHXLD419C70

LHXLD4	WATTAGE	CONTROL
LHXLD4	19C70 :19W	Blank :Non-Dimming (120V)
		-DIN :Incandescent/ELV Dimming
		-DHL :Lutron Hi-Lume Dimming (120V/277V)*
		UE :Non-Dimming (120V/277V)
		UE-D10 :0-10V Dimming (120V/277V)
		UE-DUN:UniDim™ 0-10V, ELV, Triac Dimming (120V/277V)
		-EM :Remote Emergency

* Not available for Remodel. Only dims in 120V.

