

## LTD73 : SATURN

LED TRACK HEAD 720LM (10W)



• For use with standard H-Style 1 circuit and 2 circuit track



• Color matched, thermo-formed synthetic driver box

• ELV Dimming standard and 40° beam spread

• Concealed heat sink, hardware and wiring

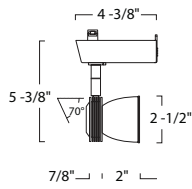

LTD7310

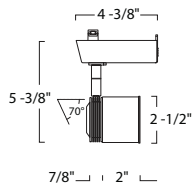

LTD7311

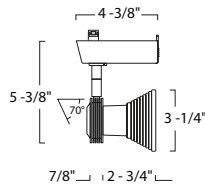

LTD7312

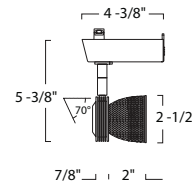

LTD7314

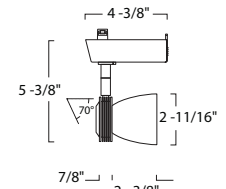

LTD7316

### ORDERING : LTD7310-12B

Fixture	Extension	Finish	Glass Color
<b>Fixture</b>	<b>Extension</b>	<b>Finish</b>	<b>Glass Color</b>
Metal Cone <b>LTD7310</b>	None <b>Blank</b>	All Black <b>B</b>	Blue <b>-BL<sup>2</sup></b>
Metal Cylinder <b>LTD7311</b>	12" Extension <b>-12</b>	All White <b>W<sup>4</sup></b>	Frosted <b>-FR<sup>2</sup></b>
Metal Deco Glass <b>LTD7312</b>	18" Extension <b>-18</b>	All Natural <b>N<sup>1,4</sup></b>	Pink <b>-PK<sup>2</sup></b>
Metal Mesh <b>LTD7314</b>	24" Extension <b>-24</b>		Snow Frost <b>-SF<sup>3</sup></b>
Small Glass <b>LTD7316</b>	36" Extension <b>-36</b>		
	48" Extension <b>-48</b>		

<sup>1</sup> Finish not available with extension.

<sup>2</sup> Only Available for LTD7312.

<sup>3</sup> Only Available for LTD7316.

<sup>4</sup> Not available for LTD7311.

### COMPATIBLE ITEMS



**LP02/LP04/LP06  
LP08/LP12**  
2', 4', 6', 8', 12'  
1 CCT Track Channel



**LPC02/LPC04/LPC06  
LPC08/LPC12**  
2', 4', 6', 8', 12'  
2 CCT Track Channel

**SPECIFICATION****Application**

---

Architecturally styled Saturn LED track head features a durable steel body and futuristic alloy heat sink. Its small, unobtrusive size make it ideal for retail, commercial and residential applications requiring stylish design and true MR16 performance.

**Mounting:**

LITON track fixtures come standard with 3-Wire H-Type track connections. Fixture is factory preset for installation on single-circuit track. J-Type and L-Type connections are available with extended lead times - consult factory..

**Lumen Maintenance:**

Minimum 35,000 hours L70 life based on ANSI TM-21 calculations from LM80 standardized test results.

**Lamp Equivalents:**

50W PAR20 FL, 50W MR16 FL

**Electrical Components**

---

**Thermal Management:**

Effective thermal dissipation facilitated by integral aluminum heat sink for maximum heat rejection to provide long LED life.

**Temperature Rating:**

Maximum temperature 85°C. Minimum temperature, -20°C.

**Driver:**

Electronic Constant Current driver integrally mounted in fixture casing.

**Color Temperature:**

LED Diodes comes standard in warm white 3,000K +/- 100K. Also available in 4,000K as special order. Consult factory, extended lead times and minimum order quantities may apply.

**Color Rendering Index (CRI):**

80 CRI

**Finishes**

---

High quality powder coat finish for maximum durability. Available in All Black, All White and All Natural.

**Control**

---

Works with most electronic low voltage dimming systems. Factory qualified for use with Lutron brand dimmers: SELV300P, VELV300P, NELV-450 as well as 3-way versions. Smoothly dims down to 10% of initial lumens with flicker-free operation.

## SPECIFICATION (Continued)

**Certifications and Listings**

---

ETL/cETL listed. Suitable for dry locations only.

**Aiming Mechanism**

---

Unobtrusive internal aiming mechanism allows maximum adjustability while rigidly maintaining desired positioning using no visible knobs, wires or screws.

**Caution**

---

Fixtures must be grounded in accordance with national, state and/or local electrical codes. Failure to do so may result in serious personal injury.

**Warranty**

---

Covered by a 3-Year Warranty to be free of defects in materials and craftsmanship. Recommended for applications where ambient temperatures do not exceed 35°C (95°F) installations exceeding this temperature will result in reduced LED lamp life and avoided warranty.