

Figure A

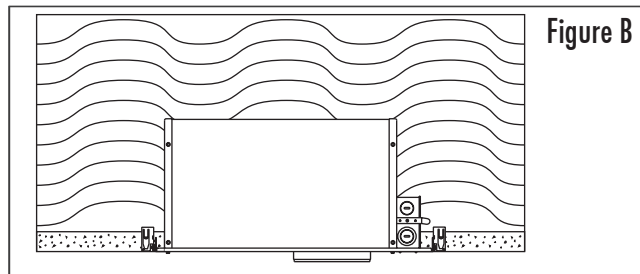

Figure B

FIXTURES IN NON-INSULATED AREAS

Non-IC fixtures are designed for installations where its parts will not come into contact with insulation. Any insulation must be located at least 3" away (FIG. A). If a blinking light is visible inside the recess during use, then a thermal problem exists due to insulation or the use of an improper Lamp or Trim.

TYPE IC FOR INSULATED CEILINGS

IC fixtures are designed for direct contact with insulating materials which are approved for this type of application (FIG. B). If a blinking light is visible inside the recess during use then a thermal problem exists due to an improper Lamp or Trim. Use airtight-rated Gaskets or Trims to comply with applicable local energy codes and save additional energy.

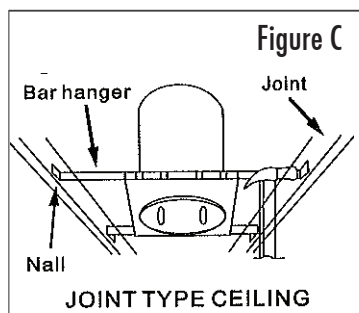

Figure C

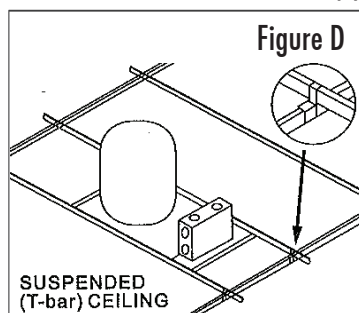

Figure D

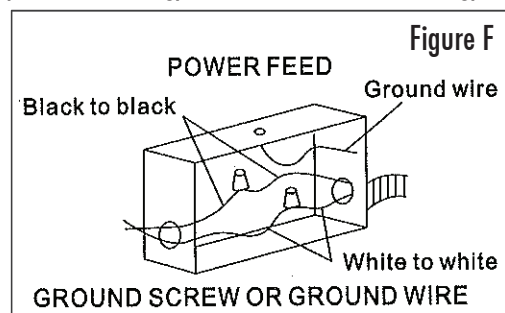

Figure F

INSTALLATION BETWEEN CEILING JOISTS

1. Extend telescoping bar hangers to fit between joists. The ends are shaped to fit along the bottom of a joist. Once positioned, hammer each captive nail and tooth tab into side of joist. If necessary, the hanger bar may be pulled apart and shortened by breaking at the score lines found on the sides of the drilled holes. If needed, the fixture may be repositioned by extracting the nails and tooth tabs.
2. Slide the fixture along the hangers to the desired position. Tighten the screw, preinstalled near the hanger, to immobilize the fixture.
3. Follow steps 1-4 below for making Electrical Connections.
4. When adding to an existing drywall ceiling, cut a hole in the appropriate location for the Housing Can protruding from bottom of fixture. Thick ceilings can be accommodated by loosening the screws that fasten the Housing Can to the fixture and lowering it as needed.
5. Install Lamp into its socket and test to verify fixture is correctly wired. Install Reflector Trim after exposed ceiling is finished. (Depending on trim design, lamp might need to be installed after trim is installed)

INSTALLATION INTO SUSPENDED CEILINGS

1. Locate center of desired Recess opening on ceiling tile and cut appropriate-sized hole.
2. Place cut Ceiling Tile back in suspended T-bar grid and remove an adjacent Tile to gain access.
3. Place fixture into position on top of cut Tile with bottom of Housing Can in hole. Adjust bar hangers to position the slots at each end over suspended T-bars. If needed, tighten the screw, preinstalled near the hanger, to immobilize the fixture and use holes in ends of bar hangers to secure them with wire.
4. Follow steps 1-4 below for making Electrical Connections.
5. Install Lamp into its socket and test to verify fixture is correctly wired. Install Reflector Trim. (Depending on trim design, lamp might need to be installed after trim is installed.)

ELECTRICAL CONNECTION INSTRUCTIONS

1. Locate Electrical Power cable for the appropriate circuit and bring to installed fixture. Wire insulation must be rated for at least 90C.
2. Remove Junction Box cover and knockout(s) as needed to meet the strain relief requirements of the local electrical code. Metal conduit/cable: Secure to J-Box with fastener hardware (not provided). Insulated cable: Insert through small holes near top corners of J-Box and push past cable grip feature on inside.
3. Make electrical connections as needed and in accordance with local code(s) or N.E.C. Use an appropriate method suitable for the size, type and number of wires at each connection. Connect the supply wires to the the Ballast/Transformer input wires and the lampholder wires to the output wires. Ground the luminaire by using the green wire provided in the J-Box.
4. When all wiring is completed, carefully push wires into Junction Box and snap its cover closed.

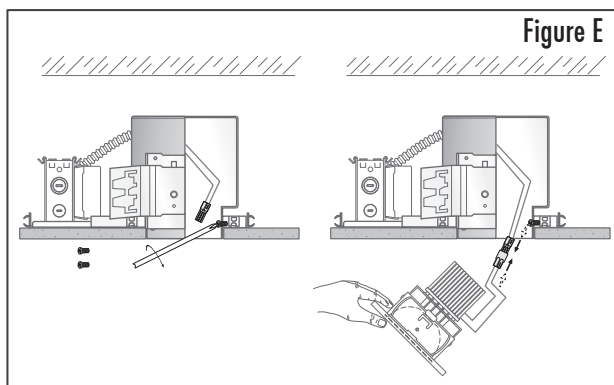
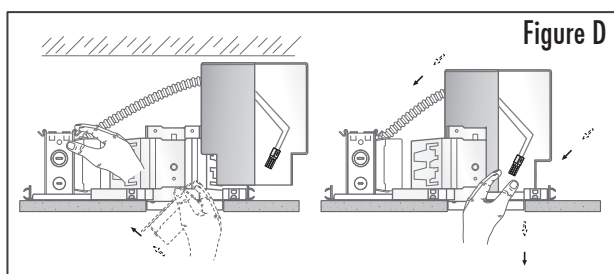
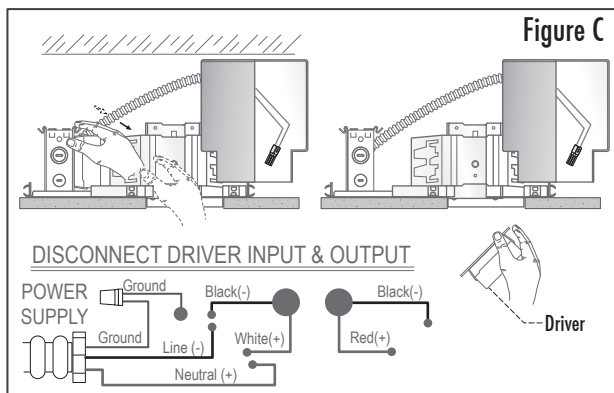
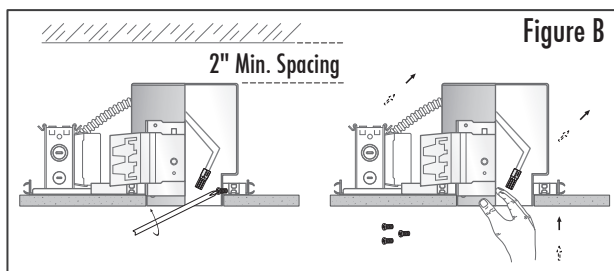
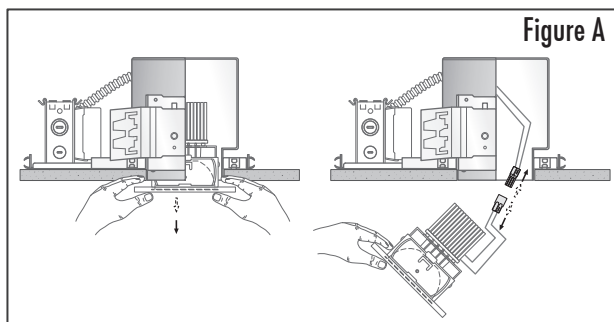

INSTALL AND USE THIS LUMINAIRE FOLLOWING YOUR LOCAL ELECTRICAL CODES AND REGULATIONS.

PREPARATION:

- 1). Read and understand instructions completely before installing this luminaire. If you are unfamiliar with electrical wiring have a qualified licensed electrician install this luminaire for you.
- 2). Before proceeding the installation, be sure that the ceiling construction follows the proper requirements. See (FIG. B) as per your reference.

CAUTION! NON-IC Luminaire, ceiling insulation must be kept a minimum of 3" away from the sides of the housing. No insulation allowed on the top. Install housing at a minimum of 1/2" away from combustible material such as wooden ceiling joists, sub-flooring or roofing.

A) REMOVE & DISCONNECT TRIM:

- 1). Pull down and disconnect Trim by quick connectors (provided), see FIG A.

B) REMOVE RECESSED HOUSING:

- 1). Unscrew Housing then pull up and push it to the side to make access to the J-Box.

NOTE: This Housing requires a Minimum of 2" between can and ceiling, see FIG B.

C) REMOVE & DISCONNECT DRIVER:

- 1). **WARNING-** Before starting the wire disconnections, disconnect the power by turning off the circuit breaker or removing the fuse at the fuse panel. Turning the power off using the light switch is not sufficient to prevent electrical shock.
- 2). This luminaire must be connected with supply wire rated at 90°C. Most dwellings built before 1985 have supply wire rated at 60°C; consult a qualified electrician before installing this luminaire.
- 3). Disconnect the Input and Output from Driver.
- 4). Replace Driver to the J-Box plate and make wire connection, follow Wiring Diagram, see FIG C.

Use twist type wire connectors (by others) suitable for the size, type and number of wires.

D) INSTALL DRIVER & RECESSED HOUSING:

- 1). After completing the wiring (be sure the wires are placed within the J-Box), replace cover plate with Driver to J-Box, see FIG D.
- 2). Pull back and insert recessed housing into the ceiling opening, see FIG D.

E) INSTALL TRIM:

- 1). Secure the recessed housing by using the screws (provided) to frame, see FIG E.
- 2). Connect trim and housing Quick Connectors (provided) and install trim into the recessed housing till trim ring is flush to ceiling surface, see FIG E and FIG A.