

THE COMPLETE LIGHTING SOLUTION | AN EEMA LIGHTING GROUP COMPANY

# LITON®

L I G H T I N G

ARCHITECTURAL LED



ARCHITECTURAL LED  
**RECESSED LIGHTING**  
ARCHITECTURAL LED RECESSED LIGHTING

## HIGH PROFILE LED LIGHTING JOBS



## LITON ARCHITECTURAL

*Trusted for performance,  
efficiency and reliability  
by lighting professionals  
everywhere.*

*See our partial list of  
successful LED  
installations below:*

### Auto Showrooms

Adventure Subaru  
BMW of Atlantic City  
Hertz Car Rentals  
Kia Dealership of Santa Rosa  
Mercedes Benz  
Pohanka Nissan  
Triumph Motorcycles

### Corporate

Boeing Bldg. 42  
Goodyear HQ  
Time Warner

### Education

Buffalo State College  
Atlanta Metropolitan College  
Buckley School Mac Science  
Chapman University  
John Tyler Community College  
John R. Briggs Elementary School  
Sandburg Middle School  
University of Notre Dame  
University of Evansville  
Variety Club Research Center

### Entertainment Venues

Ed Smith Stadium  
Hard Rock Casino  
Paradise Casino  
Universal Studios

### Healthcare

Brookfield Veterinary Hospital  
Cofax Health & Rehabilitation Center  
Elgin Community College  
Hippocrates Health Institute  
Sacred Heart Hospital  
Savage Medical  
Seven Seas Pediatric Dentistry

### Hospitality

Courtyard Inn  
Disney- Daar Guestrooms  
Elms Hotel & Spa  
Hyatt Regency  
Marriott Biscayne Bay  
Marriott Manhattan Beach  
Ritz Carlton

### Municipal / Government

Brighton City Hall  
City of Creve Couer  
City of Gothenburg Public Works  
City of Reno  
ESSE Museum  
Minot Air Force Base

### Restaurant

Baja Fresh	IHOP Restaurant
Benihana	Pinkberry
Carl's Jr.	Starbucks
Coffee Bean - Hilton	TGI Fridays
Genghis Grill	Wild Potatoe
Grill Smith Restaurants	Yo Sushi

### Retail

Bank of Tampa  
Cole Haan  
Crate & Barrel  
David Yurman  
Destinations - Dallas Int'l. Airport  
Duty Free Americas  
HMS Host Destinations Dallas  
Impressions  
Lewis Jewelers  
L'Occitane  
Macy's  
Osh Nursery  
Tiffany Jewelers  
Walmart Global  
XFINITY Store

### Worship

St. Patricks Church  
First United Methodist Church of Warren

# TABLE OF CONTENTS



General Introduction

**Liton LED Architectural**  
Page 4-5



LED Housing Introduction

**Architectural Housing**  
Page 6



LED Trim Introduction

**Architectural Trim**  
Page 7



Introducing: UniDim™

**Universal Dimming**  
Page 8-9



4" LED Downlight

**900Lm/1400Lm/2000Lm**  
Page 10



4" LED Wall Wash

**900Lm/1400Lm/2000Lm**  
Page 11



6" LED Downlight

**1400Lm/2000Lm**  
Page 12



6" LED Wall Wash

**1400Lm/2000Lm**  
Page 13



6" LED Deco Downlight

**1400Lm/2000Lm**  
Page 14



6" High Lumen LED Downlight

**3400Lm**  
Page 15



8" LED Downlight

**1400Lm/2000Lm**  
Page 16



8" LED Deco Downlight

**1400Lm/2000Lm**  
Page 17



6" Remote Phosphor

**1100Lm/2000Lm**  
Page 18-19



6" LED Adjustable

**1400Lm/2000Lm**  
Page 20-21



6", 8" & 9" LED Retrofit

**2000Lm**  
Page 22



6" Shallow Retrofit

**1200Lm**  
Page 23



# LHALD ARCHITECTURAL LED DOWNLIGHT SERIES

LITON ARCHITECTURAL LED DOWNLIGHT COLLECTION



► Designed for  
All Architectural  
Indoor Applications

- Retail
- Commercial
- Hospitality
- Industrial

- Large venues
- Small spaces
- Intimate settings
- Public spaces

# LHALD ARCHITECTURAL DOWNLIGHT SERIES

## LITON ARCHITECTURAL DOWNLIGHT INTRODUCTION



- ▶ Liton Lighting's **Award Winning Architectural LED** Luminaires are engineered to exacting standards. Using the highest quality components with very close tolerances for standard CCT variance, these LED products deliver up to 3500 lumens while maintaining strict control over color temperature and color rendering.

Designed for energy efficiency, these fixtures produce up to 80 LPW and are built to last. Rugged, specification grade housings provide a secure home for the self-flanged **one-piece aluminum reflectors**. The LEDs are deeply recessed within the trim to provide a minimum 50° of glare cut-off to insure a comfortable environment while producing an intense, well-defined beam.

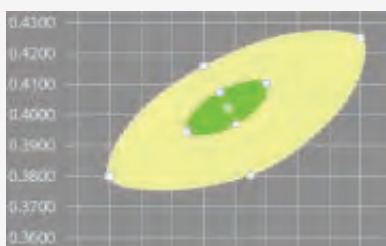

- ▶ LEDs are binned to within 3-Step MacAdam Ellipses (SDCM) to significantly reduce color temperature deviation and a 90 CRI option is available making the product perfect for high-end installations where color accuracy and rendering is of paramount importance.

Looking for the **adjustability** of an HID or incandescent fixture in an LED product? Then take a look at Liton's asymmetrical wall-wash or fully adjustable trims. Put the beam where you need it. Perfect for ever-changing retail layouts and other commercial floor plans.



- ▶ Available Architectural LED **Retrofit** trims easily convert inefficient Incandescent, CFL and HID housings into high efficacy LED luminaires without having to replace fixtures.

Liton Lighting's Architectural LED Downlights are perfect for illuminating almost any commercial space including office, retail, hospitality, healthcare and even government buildings where inefficient lighting may be planned or installed.



ALL LITON ARCHITECTURAL LED PRODUCTS ARE ASSEMBLED IN THE USA & INCLUDE A 5-YEAR LIMITED WARRANTY



# LHALD SERIES HOUSING

## ARCHITECTURAL HOUSING FEATURES

### APPLICATIONS

Architectural-grade recessed LED new construction downlight housing for medium to high ceilings in commercial and architectural spaces. Deeply recessed reflector design eliminates glare.

5-Year Limited Warranty | Assembled in the USA

120V/227V AC 50/60Hz  
Electronic Direct Current Class 2  
LED driver is mounted on J-Box  
for cool operation

0-10V or Hi-Lume  
1% Dimming is available

Roomy 64 cubic inch Double  
Junction Box with (10)  $\frac{3}{4}$ " (2)  
1" and (8) Romex Knock-outs  
allows up to (8) #12 AWG  
wires for easy wiring

Heavy duty 16 gauge die-formed  
galvanized steel construction  
throughout

Heavy duty flexible steel  
conduit features a  
quick-connect for easy  
LED trim installation

Triple Slot Bat-Wing  
Hanger Bar Brackets  
adjust vertically  $3\frac{1}{4}$ "  
to accommodate any  
ceiling thickness

Accepts optional  $\frac{1}{2}$ " EMT,  
26" C-Channel Strut  
for T-Bar Ceilings and  
27" adjustable linear hanger  
bars for plaster ceilings or  
wood/metal joists

Steel Trim Retention Ring is  
powder coated to insure long  
lasting durability

Emergency Battery Back up option

Universal frame-in kit  
design supports all  
compatible trims  
regardless of lumen  
package, wattage  
or options.



• Durable Steel Retention Ring



• Quick Connect Flex Conduit



• Deeply recessed LED Module



• Triple Slot Hanger Bar Brackets



• 64 Cubic-Inch Double J-box

ALL LITON ARCHITECTURAL LED PRODUCTS ARE ASSEMBLED IN THE USA & INCLUDE A 5-YEAR LIMITED WARRANTY

# LRALD SERIES TRIM

## ARCHITECTURAL TRIM FEATURES

### 3-Step MacAdam Ellipse

The lighting industry has adopted the MacAdam ellipse and SDCM (Standard Deviation of Color Matching) measurement of color consistency. A MacAdam ellipse defines a color variation around a specific color point, example 3000K. The typical human eye is unable to perceive the color difference between a color point and the perimeter of a MacAdam ellipse around the color point.

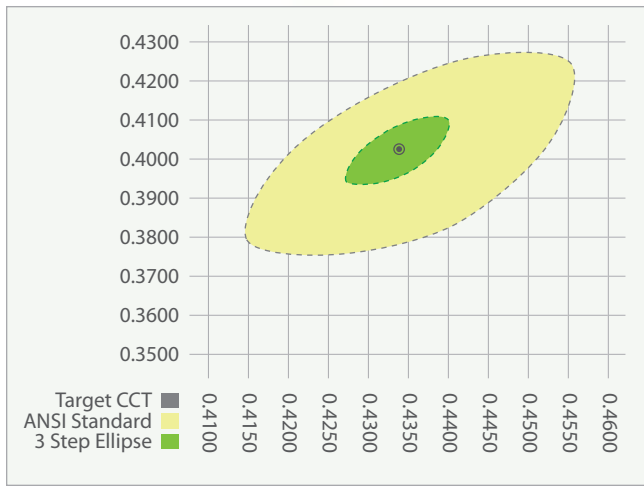

5-Year Limited Warranty | Assembled in the USA

This color variation is often called an SDCM or 1 step. Color consistency of 7 SDCM, the ANSI Standard, is typical for products sold to the lighting market and complies with Energy Star requirements. 3SDCM, or 3-step color control is a more precise color targeting. The typical observer is unable to perceive a color difference between LED light sources with 3SDCM of the same color (CCT).

3SDCM is preferred in high-end architectural lighting. It provides uniform color throughout the lighted space. This consistency is especially important when multiple light sources are close together such as in wall wash applications.

Large integral heat sink cools LED and maintains long LED life

LED is available in 13 watt, 19 watt, 25 watt and 40 watt (25-watt versions are Energy Star qualified)

Deeply recessed LED Module provides over 50° of visual cutoff for glare-free comfort

One Piece Self-flanged trim allows hassle free installation

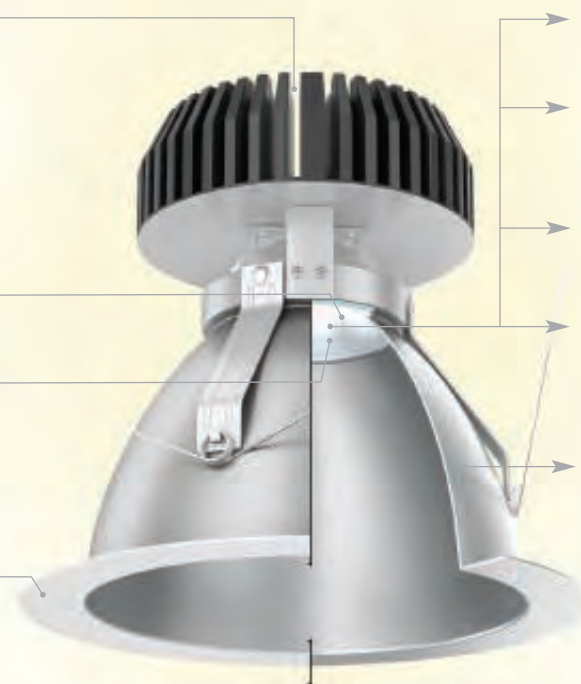

Lumen packages of 900Lm, 1400Lm, 2000Lm & 3400Lm

3000K Color Temperature is standard

2700K, 4000K and 5000K are available as special order. Extended lead times may apply

80 CRI is Standard, High 90CRI Option is available

Heavy gauge aluminum reflectors resist damage during installation and servicing

ALL LITON ARCHITECTURAL LED PRODUCTS ARE ASSEMBLED IN THE USA & INCLUDE A 5-YEAR LIMITED WARRANTY

# unidim™

UNIVERSAL DIMMING

"A **REVOLUTIONARY** UNIVERSAL  
DIMMING OPTION FOR **LITON GEN2**  
ARCHITECTURAL LED DOWNLIGHTS"

*One of the obstacles to getting LED products correctly specified on projects is the incompatibility between existing or planned dimming systems and a desired LED product.*

*Very often this incompatibility can result in unexpected rewiring costs or replacement of existing dimmers, a costly proposition.*

*Liton's UniDim™ LED Dimming Technology eliminates the costs and guesswork involved in matching LED luminaires with dimming systems.*

*Available on Liton's New Generation 2 Architectural Recessed LED Downlights, UniDim is compatible with most 2-Wire Incandescent/Triac, 0-10V and ELV dimmers!*

## Industry Leading Dimmer Compatibility

Considering the endless variety of dimmers on the market today and the vast number of installed dimmers, UniDim™ simplifies the job for manufacturers, specifiers and installers by providing wider dimmer compatibility and eliminating time consuming guesswork. This Ultra-Compatible Driver not only works with a large number of dimmer types, it also works with every major dimmer brand, including Lutron and Leviton. Please check out our up-to-date list of factory-qualified dimmers that UniDim™ drivers have been tested with.

Stock or specify just one LED housing to handle all LED dimmers.

## Avoid Expensive Rewiring ►

A big limitation when retrofitting inefficient lighting to LED is that existing dimming control systems may not be compatible with the new technology. For example, common Triac or Incandescent controls use only two wires while ELV/Trailing Edge or 0-10V dimmers use more than two wires and therefore require additional wiring. This incompatibility can cause a significant increase in material and labor costs.



UniDim™ Lighting Control Technology eliminates these potential costs by providing flicker-free dimming performance across all standard control inputs, regardless of dimmer type. With UniDim™ there is no expensive rewiring required because UniDim™ drivers are compatible with all dimmer types.



**unidim™**  
UNIVERSAL DIMMING

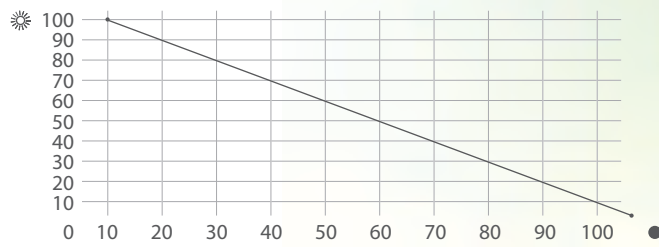

## Smooth Flicker-Free Dimmer Compatibility

UniDim™ intelligent lighting technology eliminates the gaps, jumps and sections of inconsistency that are typical when controlling LED products with Triac/Incandescent controls. UniDim™ provides the same smooth, uniform response when dimming LED that you would expect when dimming an incandescent product.

## Reduce Inventory & Fixture Variety

Distributors supplying new construction projects can now purchase and warehouse just one product to accommodate several different projects. Specifiers can now use just one product to satisfy all the needs of a project regardless of existing or planned wiring or lighting control systems.

# All-In-One Universal LED Driver

- Universal Dimming (ELV, Incandescent, 0-10V)
- Universal Voltage (120V/277V)
- Multi-Watt Compatible (19W/25W)
- Multi-Lumen Compatible (1400Lm/2000Lm)

## Dimmer Wiring Diagrams

### Electronic Low Voltage Dimming (120-277VAC)

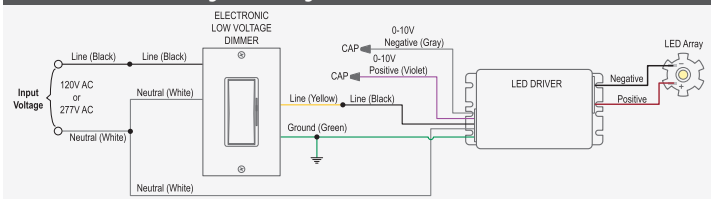

### 0-10V Fluorescent Dimming (120-277VAC)

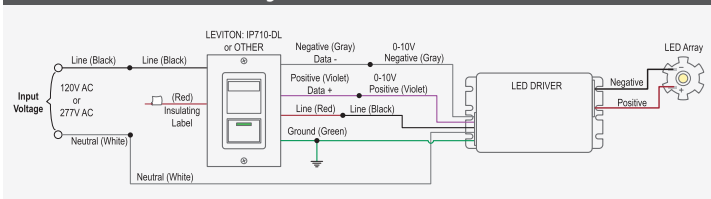

### Line Voltage/Incandescent Dimming (120-277VAC)

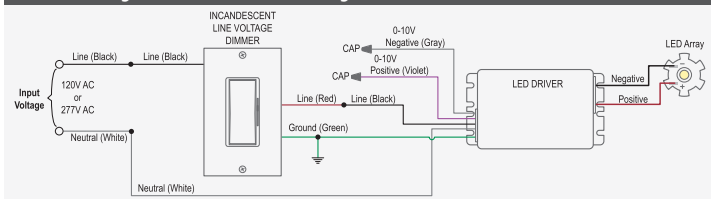

## Four Great Reasons to choose UniDim™

1. Avoid Expensive Rewiring or Dimmer Replacement
  - UniDim™ works with Incandescent/Triac, 0-10V and ELV Dimmers.
2. Avoid Dimmer Compatibility Issues
  - UniDim is compatible with Lutron, Leviton and most popular dimmer systems.
3. Smooth flicker-Free Dimmer Compatibility
  - UniDim delivers smooth, incandescent-like dimming performance from ELV, 0-10V, and 120V dimming systems.
4. Reduce Inventory and Fixture Variety
  - UniDim™ is available on all Liton Gen2 Architectural LED Housings

Stock or specify just one LED housing to handle all LED dimmers.

4  
INCH

## ARCHITECTURAL LED DOWNLIGHT SERIES

## LHALD425 / LRALD4

LED 4" DOWNLIGHT | 1400 LUMEN | 2000 LUMEN

## APPLICATIONS

Architectural-grade recessed LED downlight for medium to high ceiling heights. Perfect for commercial, retail, municipal and similar applications where powerful lumen output, critical color control are essential and dimming, as well as emergency options are desired.

## ARCHITECTURAL SPECIFICATIONS

LED	Bridgelux
LUMEN PACKAGES	19W (1400 Lumen), 25W (2000 Lumen)
CCT	3000K Standard, Binned to 3-Step MacAdam Ellipses (SDCM) 2700K, 3500K and 4000K Optional, Binned to ANSI Standard
CRI	80+ Standard, 90+ Option
GLARE CUT-OFF	50°
LED LAMP LIFE	50,000 Hours (L70)
DIMMING OPTIONS	0-10V 10%, ELV 5%, HiLume 1%, Incandescent 5%
EMERGENCY OPTIONS	EM2-10W, EM3-20W, Generator Transfer Device (GTD)
INPUT	120V/277V
LED TRIM CONNECTOR	Heavy Duty Quick Connector

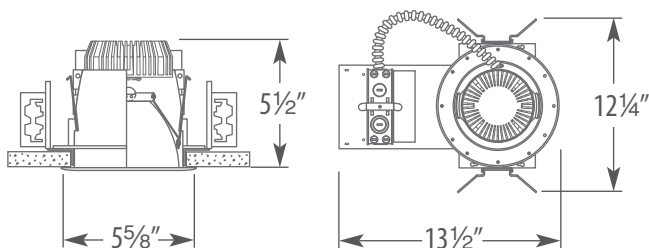

## PHOTOMETRY

TEST DATA
<b>4" LED DOWNLIGHT LUMINAIRE</b>
Color Rendering Index (CRI): 83
Report File# 27120
By: Lighting Sciences, Inc.

FIXTURE DATA		
LED LUMEN	FIXTURE LUMEN	INPUT WATT.
1400 Lm	937 Lm	23W
2000 Lm	1592 Lm	28W

MULTIPLIERS			
FINISHES		LED LUMENS	
Satin Haze	1.0	2000 Lm	1.70
White	0.9	1400 Lm	1.00

INTENSITY SUMMARY	
ANGLE	MEAN CP
0	3940
5	3067
10	1929
15	1332
20	907
25	582
30	250
35	45

ZONAL LUMEN SUMMARY		
ZONE	LUMENS	%LUMINAIRE
0-30	882	94.15
0-40	928	98.99
0-60	937	99.95
0-180	937	100.00

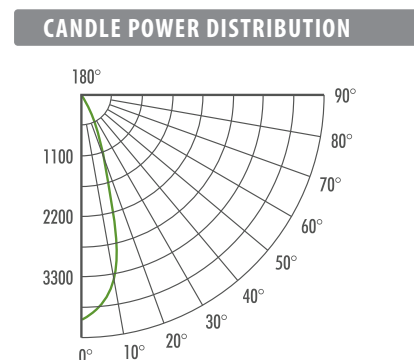

## ORDERING

Example: **LHALD425C070UE-DUN** / **LRALD4SWF101**

HOUSING	DRIVER TYPE (120V/277V)	OPTION
<b>LHALD425</b> NEW CONSTRUCTION	<b>C070UE</b> : Non Dimming	<b>Blank</b> : None
	<b>C070UE-D10</b> : 0-10V (10% Dimming)	<b>-EM2</b> : Emergency (10W)
	<b>C070UE-DHL</b> : HiLume (1% Dimming)	<b>-EM3</b> : Emergency (20W)
	<b>C070UE-DIN</b> : 2-Wire 120V Dimming*	<b>-GTD</b> : Generator Transfer Device
	<b>C070UE-DLV</b> : ELV (5% Dimming)*	
	<b>C070UE-DUN</b> : UniDim™ (Universal)	

TRIM	REFLECTOR/FLANGE FINISH	LUMEN PACKAGE	CRI
<b>LRALD4</b>	<b>SWF</b> : Satin Haze / White	<b>101</b> : 19W / 1400Lm	<b>Blank</b> : 80+
	<b>WWF</b> : White / White	<b>150</b> : 25W / 2000Lm	<b>C90</b> : 90+

\* Dimmable in 120V operation only.

# LHALD425 / LRALD471

LED 4" WALL WASH | 1400 LUMEN | 2000 LUMEN

4  
INCH

## APPLICATIONS

Architectural-grade recessed LED downlight utilizes a lens-controlled redirection of the beamspread to light walls, art, signs and graphics. Reduces glare in hallways and corridors when used to illuminate walls instead of ceilings, an ideal application for hospitals, clinics and convalescent facilities. Perfect for retail, commercial, municipal applications where powerful lumen output and critical color control are essential in a wall wash luminaire.



4" HOUSING WITH WALL WASH TRIM

## ARCHITECTURAL SPECIFICATIONS

LED	Bridgelux
LUMEN PACKAGES	19W (1400 Lumen), 25W (2000 Lumen)
CCT	3000K Standard, Binned to 3-Step MacAdam Ellipses (SDCM) 2700K, 3500K and 4000K Optional, Binned to ANSI Standard
CRI	80+ Standard, 90+ Option
LED LAMP LIFE	50,000 Hours (L70)
DIMMING OPTIONS	0-10V 10%, ELV 5%, HiLume 1%, Incandescent 5%
EMERGENCY OPTIONS	EM2-10W, EM3-20W, Generator Transfer Device (GTD)
INPUT	120V/277V
LED TRIM CONNECTOR	Heavy Duty Quick Connector

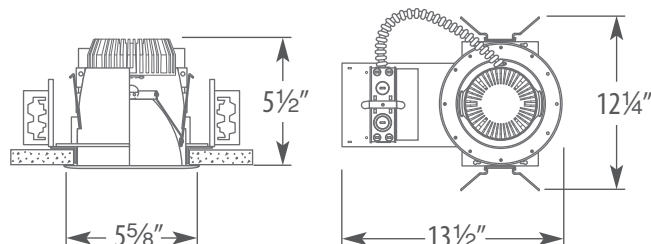

## ORDERING

Example: **LHALD425C070UE-DUN** / **LRALD471SWF100**

HOUSING	DRIVER TYPE (120V/277V)	OPTION
<b>LHALD425</b> NEW CONSTRUCTION	<b>C070UE</b> : Non Dimming	<b>Blank</b> : None
	<b>C070UE-D10</b> : 0-10V (10% Dimming)	<b>-EM2</b> : Emergency (10W)
	<b>C070UE-DHL</b> : HiLume (1% Dimming)	<b>-EM3</b> : Emergency (20W)
	<b>C070UE-DIN</b> : 2-Wire Dimming *	<b>-GTD</b> : Generator Transfer Device
	<b>C070UE-DLV</b> : ELV 5% Dimming *	
	<b>C070UE-DUN</b> : UniDim™ (Universal)	

TRIM	REFLECTOR/FLANGE FINISH	LUMEN PACKAGE	CRI
<b>LRALD471</b>	<b>SWF</b> : Satin Haze / White	<b>100</b> : 19W / 1400Lm	<b>Blank</b> : 80+
	<b>WWF</b> : White / White	<b>150</b> : 25W / 2000Lm	<b>C90</b> : 90+

\* Dimmable in 120V operation only.



6  
INCH

6" HOUSING WITH REFLECTOR TRIM

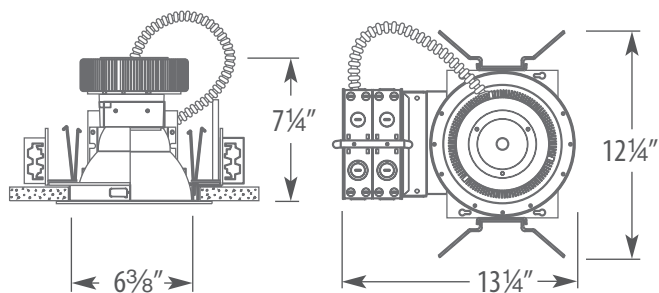

## PHOTOMETRY

### TEST DATA

#### 6" LED DOWNLIGHT LUMINAIRE

Color Rendering Index (CRI): 83.54  
Report File#  
By: Lighting Sciences, Inc.

### FIXTURE DATA

LED LUMEN	FIXTURE LUMEN	INPUT WATT.
1400 Lm	1136 Lm	23W
2000 Lm	1623 Lm	28W

### MULTIPLIERS

FINISHES		LED LUMENS	
Satin Haze	1.0	2000 Lm	1.00
White	0.9	1400 Lm	0.70

### INTENSITY SUMMARY

ANGLE	MEAN CP
0	4315.35
5	3695.49
10	2571.99
15	1911.24
20	1418.36
25	990.06
30	391.72
35	195.86

### ZONAL LUMEN SUMMARY

ZONE	LUMENS	%LUMINAIRE
0-30	1260.75	65.00
0-40	1303.65	93.50
0-60	1348.23	96.60
0-180	1395.02	100.00

### CANDLE POWER DISTRIBUTION

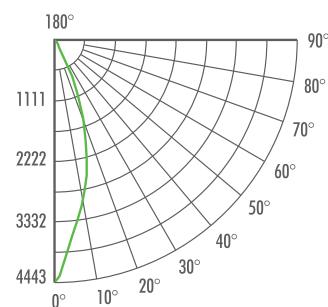

## ORDERING

Example: **LHALD625C071UE-DUN** / **LRALD6SWF101**

HOUSING	DRIVER TYPE (120V/277V)	OPTION
<b>LHALD625</b> NEW CONSTRUCTION	<b>C071UE</b> : Non Dimming	<b>Blank</b> : None
	<b>C071UE-D10</b> : 0-10V (10% Dimming)	<b>-EM2</b> : Emergency (10W)
<b>LHALD6R25</b> REMODEL	<b>C071UE-DHL</b> : HiLume (1% Dimming)	<b>-EM3</b> : Emergency (20W)
	<b>C071UE-DIN</b> : 2-Wire Dimming *	<b>-GTD</b> : Generator Transfer Device
	<b>C071UE-DLV</b> : ELV 5% Dimming *	
	<b>C071UE-DUN</b> : UniDim™ (Universal)	

TRIM	REFLECTOR/FLANGE FINISH	LUMEN PACKAGE	CRI
<b>LRALD6</b>	<b>SWF</b> : Satin Haze / White	<b>101</b> : 19W / 1400Lm	<b>Blank</b> : 80+
	<b>WWF</b> : White / White	<b>151</b> : 25W / 2000Lm	<b>C90</b> : 90+

\* Dimmable in 120V operation only.

# LHALD625 / LRALD671

LED 6" FIXED WALL WASH

## APPLICATIONS

Architectural-grade recessed LED downlight utilizes a lens-controlled redirection of the beams spread to light walls, art, signs and graphics. Reduces glare in hallways and corridors when used to illuminate walls instead of floors, an ideal application for hospitals, clinics and convalescent facilities. Perfect for retail, commercial, municipal applications where powerful lumen output and critical color control are essential in a wall wash luminaire.

## ARCHITECTURAL SPECIFICATIONS

LED	Bridgelux
LUMEN PACKAGES	19W (1400 Lumen), 25W (2000 Lumen)
CCT	3000K Standard, Binned to 3-Step MacAdam Ellipses (SDCM) 2700K, 3500K and 4000K Optional, Binned to ANSI Standard
CRI	80+ Standard, 90+ Option
LED LAMP LIFE	50,000 Hours (L70)
DIMMING OPTIONS	0-10V 10%, ELV 5%, HiLume 1%, Incandescent 5%
EMERGENCY OPTIONS	EM2-10W, EM3-20W, Generator Transfer Device (GTD)
INPUT	120V/277V
LED TRIM CONNECTOR	Heavy Duty Aluminum Connector

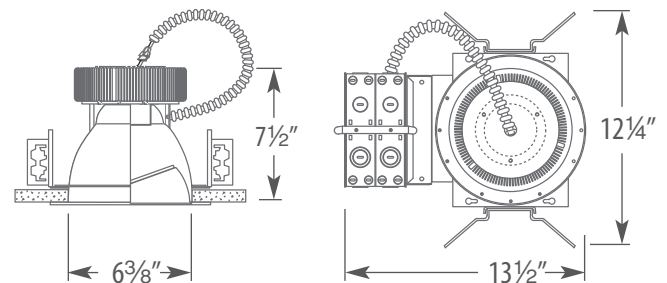

## ORDERING

Example: **LHALD625C070UE-DUN / LRALD671SWF101**

HOUSING	DRIVER TYPE (120V/277V)	OPTION
<b>LHALD625</b> NEW CONSTRUCTION	<b>C070UE</b> : Non Dimming	<b>Blank</b> : None
	<b>C070UE-D10</b> : 0-10V (10% Dimming)	<b>-EM2</b> : Emergency (10W)
<b>LHALD6R25</b> REMODEL	<b>C070UE-DHL</b> : HiLume (1% Dimming)	<b>-EM3</b> : Emergency (20W)
	<b>C070UE-DIN</b> : 2-Wire Dimming *	<b>-GTD</b> : Generator Transfer Device
	<b>C070UE-DLV</b> : ELV 5% Dimming *	
	<b>C070UE-DUN</b> : UniDim™ (Universal)	

TRIM	REFLECTOR/FLANGE FINISH	LUMEN PACKAGE	CRI
<b>LRALD671</b>	<b>SWF</b> : Satin Haze / White	<b>101</b> : 19W / 1400Lm	<b>Blank</b> : 80+
	<b>WWF</b> : White / White	<b>150</b> : 25W / 2000Lm	<b>C90</b> : 90+

\* Dimmable in 120V operation only.

6  
INCH

6" HOUSING WITH DECO TRIM

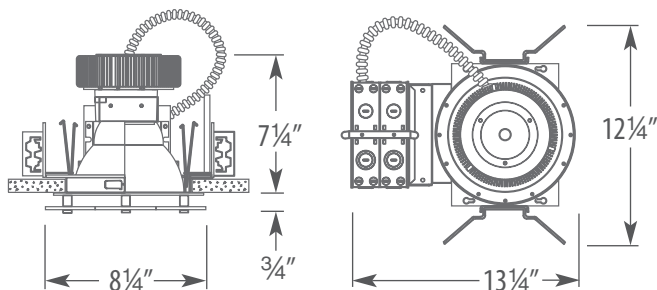

## PHOTOMETRY

### TEST DATA

#### 6" LED DOWNLIGHT LUMINAIRE

Color Rendering Index (CRI): 83.54

Report File#

By: Lighting Sciences, Inc.

### FIXTURE DATA

LED LUMEN	FIXTURE LUMEN	INPUT WATT.
1400 Lm	1136 Lm	23W
2000 Lm	1623 Lm	28W

### MULTIPLIERS

FINISHES		LED LUMENS	
Satin Haze	1.0	2000 Lm	1.00
White	0.9	1400 Lm	0.70

### INTENSITY SUMMARY

ANGLE	MEAN CP
0	4315.35
5	3695.49
10	2571.99
15	1911.24
20	1418.36
25	990.06
30	391.72
35	195.86

### ZONAL LUMEN SUMMARY

ZONE	LUMENS	%LUMINAIRE
0-30	1260.75	65.00
0-40	1303.65	93.50
0-60	1348.23	96.60
0-180	1395.02	100.00

### CANDLE POWER DISTRIBUTION

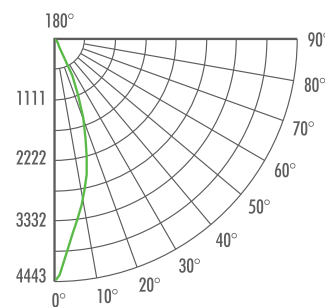

## ORDERING

Example: **LHALD625C071UE-DUN / LRALD6021SWF100-BL**

HOUSING	DRIVER TYPE (120V/277V)	OPTION	TRIM	REFLECTOR/FLANGE	LUMEN PACKAGE	CRI	GLASS
<b>LHALD625</b> NEW CONSTRUCTION	<b>C071UE</b> : Non Dimming	<b>Blank</b> : None	<b>LRALD6021</b>	<b>SWF</b> : Satin Haze / White	<b>100</b> : 19W/1400Lm	<b>Blank</b> : 80+	<b>-BL</b> : Blue
	<b>C071UE-D10</b> : 0-10V (10% Dimming)	<b>-EM2</b> : Emergency (10W)		<b>WWF</b> : White / White	<b>150</b> : 25W/2000Lm	<b>C90</b> : 90+	<b>-FR</b> : Frosted
<b>LHALD6R25</b> REMODEL	<b>C071UE-DHL</b> : HiLume (1% Dimming)	<b>-EM3</b> : Emergency (20W)					
	<b>C071UE-DIN</b> : 2-Wire Dimming *	<b>-GTD</b> : Generator Transfer Device					
	<b>C071UE-DLV</b> : ELV 5% Dimming *						
	<b>C071UE-DUN</b> : UniDim™ (Universal)						

\* Dimmable in 120V operation only.



# LHALD640 / LRALD6

LED 6" HIGH LUMEN DOWNLIGHT | 3400 LUMEN

3400 Lm

## APPLICATIONS

High Lumen architectural-grade recessed LED downlight for applications in high ceilings. Perfect for commercial, retail, municipal and similar applications with ceilings up to 25', where maximum footcandles to the task area are required. Options include 120V/277V input, dimming and emergency options are available.



6" HIGH LUMEN HOUSING WITH REFLECTOR TRIM

## ARCHITECTURAL SPECIFICATIONS

LED	Bridgelux
LUMEN PACKAGES	40W (3400 Lumen)
CCT	3000K Standard, Binned to 3-Step MacAdam Ellipses (SDCM) 2700K, 3500K and 4000K Optional, Binned to ANSI Standard
CRI	80+ Standard, 90+ Option
GLARE CUT-OFF	50°
LED LAMP LIFE	50,000 Hours (L70)
DIMMING OPTIONS	0-10V 10%, ELV 5%, Hilume 1%, Incandescent 5%
EMERGENCY OPTIONS	EM2-10W, EM3-20W, Generator Transfer Device (GTD)
INPUT	120V/277V
LED TRIM CONNECTOR	Heavy Duty Aluminum Connector

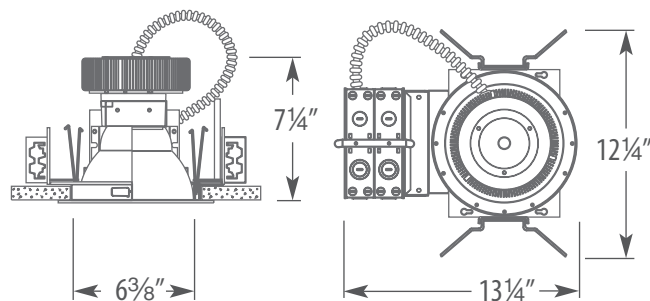

## PHOTOMETRY

### TEST DATA

#### 6" LED DOWNLIGHT LUMINAIRE

Color Rendering Index (CRI): 83.10  
Report File# L01131902  
By: Light Laboratory, Inc.

### FIXTURE DATA

LED LUMEN	FIXTURE LUMEN	INPUT WATT.
3000 Lm	2609 Lm	43W

### MULTIPLIERS

FINISHES		LED LUMENS	
Satin Haze	1.0	3000 Lm	1.00
White	0.9		

### INTENSITY SUMMARY

ANGLE	MEAN CP
0	4018
4	4040
8	4087
12	4080
16	3935
20	3322
24	2294
28	1058

### ZONAL LUMEN SUMMARY

ZONE	LUMENS	%LUMINAIRE
0-20	1482.17	56.80
0-30	2351.31	90.10
0-40	2466.09	94.50
0-60	2581.12	98.90
0-80	2606.23	99.90
0-90	2609.05	100.00

### CANDLE POWER DISTRIBUTION

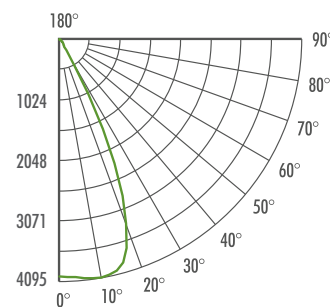

## ORDERING

Example: **LHALD640C165UE / LRALD6SWF320**

HOUSING	DRIVER TYPE (120V/277V)	OPTION	TRIM	REFLECTOR/FLANGE FINISH	LUMEN PACKAGE	CRI
<b>LHALD640</b> NEW CONSTRUCTION	<b>C165UE</b> : Non Dimming	<b>Blank</b> : None	<b>LRALD6</b>	<b>SWF</b> : Satin Haze / White	<b>320</b> : 40W / 3400Lm	<b>Blank</b> : 80+
	<b>C165UE-D10</b> : 0-10V (10% Dimming)	<b>-EM2</b> : Emergency (10W)		<b>SSF</b> : Satin Haze/Satin		<b>C90</b> : 90+
<b>LHALD640</b> REMODEL				<b>WWF</b> : White / White		

\* Dimmable in 120V operation only.

8  
INCH

8" HOUSING WITH REFLECTOR TRIM

## ARCHITECTURAL LED DOWNLIGHT SERIES

## LHALD825 / LRALD8

LED 8" DOWNLIGHT | 1400 LUMEN | 2000 LUMEN

## APPLICATIONS

Architectural-grade recessed LED downlight for medium to high ceiling heights. Perfect for commercial, retail, municipal and similar applications where powerful lumen output, critical color control are essential and dimming, as well as emergency options are desired.

## ARCHITECTURAL SPECIFICATIONS

LED	Bridgelux
LUMEN PACKAGES	19W (1400 Lumen), 25W (2000 Lumen)
CCT	3000K Standard, Binned to 3-Step MacAdam Ellipses (SDCM) 2700K, 3500K and 4000K Optional, Binned to ANSI Standard
CRI	80+ Standard, 90+ Option
GLARE CUT-OFF	50°
LED LAMP LIFE	50,000 Hours (L70)
DIMMING OPTIONS	0-10V 10%, ELV 5%, HiLume 1%, Incandescent 5%
EMERGENCY OPTIONS	EM2-10W, EM3-20W, Generator Transfer Device (GTD)
INPUT	120V/277V
LED TRIM CONNECTOR	Heavy Duty Quick Connector

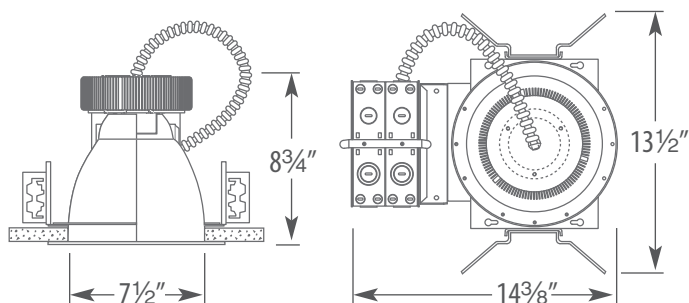

## PHOTOMETRY

TEST DATA
<b>8" LED DOWNLIGHT LUMINAIRE</b>
Color Rendering Index (CRI): 83.54
Report File#
By: Lighting Sciences, Inc.

FIXTURE DATA		
LED LUMEN	FIXTURE LUMEN	INPUT WATT.
1400 Lm	1136 Lm	23W
2000 Lm	1623 Lm	28W

MULTIPLIERS			
FINISHES		LED LUMENS	
Satin Haze	1.0	2000 Lm	1.00
White	0.9	1400 Lm	0.70

INTENSITY SUMMARY	
ANGLE	MEAN CP
0	4315.35
5	3695.49
10	2571.99
15	1911.24
20	1418.36
25	990.06
30	391.72
35	195.86

ZONAL LUMEN SUMMARY		
ZONE	LUMENS	%LUMINAIRE
0-30	1260.75	65.00
0-40	1303.65	93.50
0-60	1348.23	96.60
0-180	1395.02	100.00

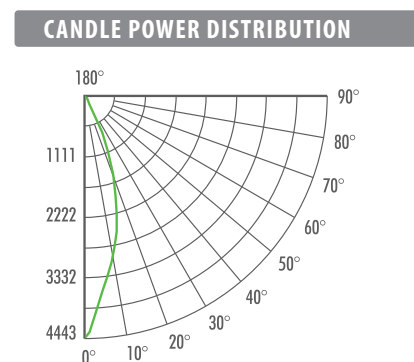

## ORDERING

Example: **LHALD825C070UE-DUN** / **LRALD8SWF101**

HOUSING	DRIVER TYPE (120V/277V)	OPTION
<b>LHALD825</b> NEW CONSTRUCTION	<b>C070UE</b> : Non Dimming	<b>Blank</b> : None
	<b>C070UE-D10</b> : 0-10V (10% Dimming)	<b>-EM2</b> : Emergency (10W)
<b>LHALD8R25</b> REMODEL	<b>C070UE-DHL</b> : HiLume (1% Dimming)	<b>-EM3</b> : Emergency (20W)
	<b>C070UE-DIN</b> : 2-Wire Dimming *	<b>-GTD</b> : Generator Transfer Device
	<b>C070UE-DLV</b> : ELV 5% Dimming *	
	<b>C070UE-DUN</b> : UniDim™ (Universal)	

TRIM	REFLECTOR/FLANGE FINISH	LUMEN PACKAGE	CRI
<b>LRALD8</b>	<b>SWF</b> : Satin Haze / White	<b>101</b> : 19W / 1400Lm	<b>Blank</b> : 80+
	<b>WWF</b> : White / White	<b>150</b> : 25W / 2000Lm	<b>C90</b> : 90+

\* Dimmable in 120V operation only.

# LHALD825 / LRALD8021

LED 8" DECO DOWNLIGHT | 1400 LUMEN | 2000 LUMEN

## APPLICATIONS

Architectural-grade recessed LED downlight reflector for medium to high ceilings in commercial and architectural installations. Reflector is designed for minimal glare from LED without sacrificing lumen output. Decorative glass accent brings style and elegance to any decor. Reduces lamp image while adding a subtle decorative element to architecture. Great for hospitality and retail venues where a standard reflector design might be too plain.

## ARCHITECTURAL SPECIFICATIONS

LED	Bridgelux
LUMEN PACKAGES	19W (1400 Lumen), 25W (2000 Lumen)
CCT	3000K Standard, Binned to 3-Step MacAdam Ellipses (SDCM) 2700K, 3500K and 4000K Optional, Binned to ANSI Standard
CRI	80+ Standard, 90+ Option
GLARE CUT-OFF	50°
LED LAMP LIFE	50,000 Hours (L70)
DIMMING OPTIONS	0-10V 10%, ELV 5%, HiLume 1%, Incandescent 5%
EMERGENCY OPTIONS	EM2-10W, EM3-20W, Generator Transfer Device (GTD)
INPUT	120V/277V
LED TRIM CONNECTOR	Heavy Duty Quick Connector

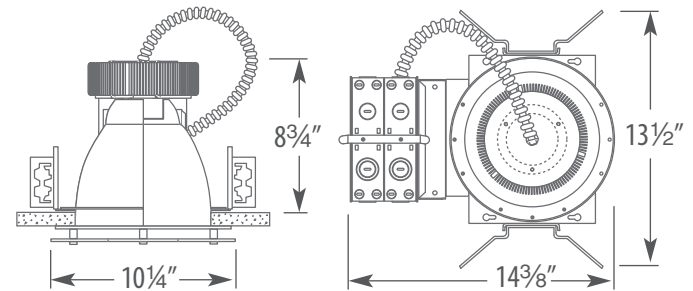

## PHOTOMETRY

### TEST DATA

#### 8" LED DOWNLIGHT LUMINAIRE

Color Rendering Index (CRI): 83.54

Report File#

By: Lighting Sciences, Inc.

### FIXTURE DATA

LED LUMEN	FIXTURE LUMEN	INPUT WATT.
1400 Lm	1136 Lm	23W
2000 Lm	1623 Lm	28W

### MULTIPLIERS

FINISHES		LED LUMENS	
Satin Haze	1.0	2000 Lm	1.00
White	0.9	1400 Lm	0.70

### INTENSITY SUMMARY

ANGLE	MEAN CP
0	4315.35
5	3695.49
10	2571.99
15	1911.24
20	1418.36
25	990.06
30	391.72
35	195.86

### ZONAL LUMEN SUMMARY

ZONE	LUMENS	%LUMINAIRE
0-30	1260.75	65.00
0-40	1303.65	93.50
0-60	1348.23	96.60
0-180	1395.02	100.00

### CANDLE POWER DISTRIBUTION

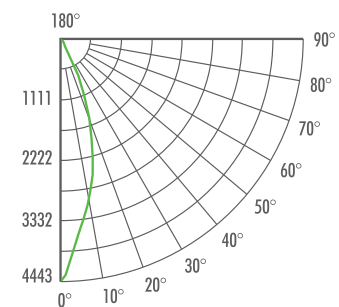

## ORDERING

Example: **LHALD825C070UE-DUN / LRALD8021SWF100-BL**

HOUSING	DRIVER TYPE (120V/277V)	OPTION	TRIM	REFLECTOR/FLANGE	LUMEN PACKAGE	CRI	GLASS
<b>LHALD825</b> NEW CONSTRUCTION	<b>C070UE</b> : Non Dimming	<b>Blank</b> : None	<b>LRALD8021</b>	<b>SWF</b> : Satin Haze / White	<b>100</b> : 19W/1400Lm	<b>Blank</b> : 80+	<b>-BL</b> : Blue
	<b>C070UE-D10</b> : 0-10V (10% Dimming)	<b>-EM2</b> : Emergency (10W)		<b>WWF</b> : White / White	<b>150</b> : 25W/2000Lm	<b>C90</b> : 90+	<b>-FR</b> : Frosted
<b>LHALD825</b> REMODEL	<b>C070UE-DHL</b> : HiLume (1% Dimming)	<b>-EM3</b> : Emergency (20W)					
	<b>C070UE-DIN</b> : 2-Wire Dimming *	<b>-GTD</b> : Generator Transfer Device					
	<b>C070UE-DLV</b> : ELV 5% Dimming *						
	<b>C070UE-DUN</b> : UniDim™ (Universal)						

\* Dimmable in 120V operation only.





REMOTE PHOSPHOR DOWNLIGHT

## REMOTE PHOSPHOR ARCHITECTURAL LED

# LHFLD636 / LRFLD6

LED 6" REMOTE PHOSPHOR DOWNLIGHT | FORTIMO

## ARCHITECTURAL REMOTE PHOSPHOR LED

A cool blend of superior heat management, consistent color quality, and longer lifespan make this LED housing the sustainable choice for architects, engineers, and lighting designers.

Features Philips Fortimo™ LED Module. Remote Phosphor produces high lumen output with no visible LEDs, longer product life due to superior heat management, improved energy efficiency and equivalent lumen output across all available color temperatures.

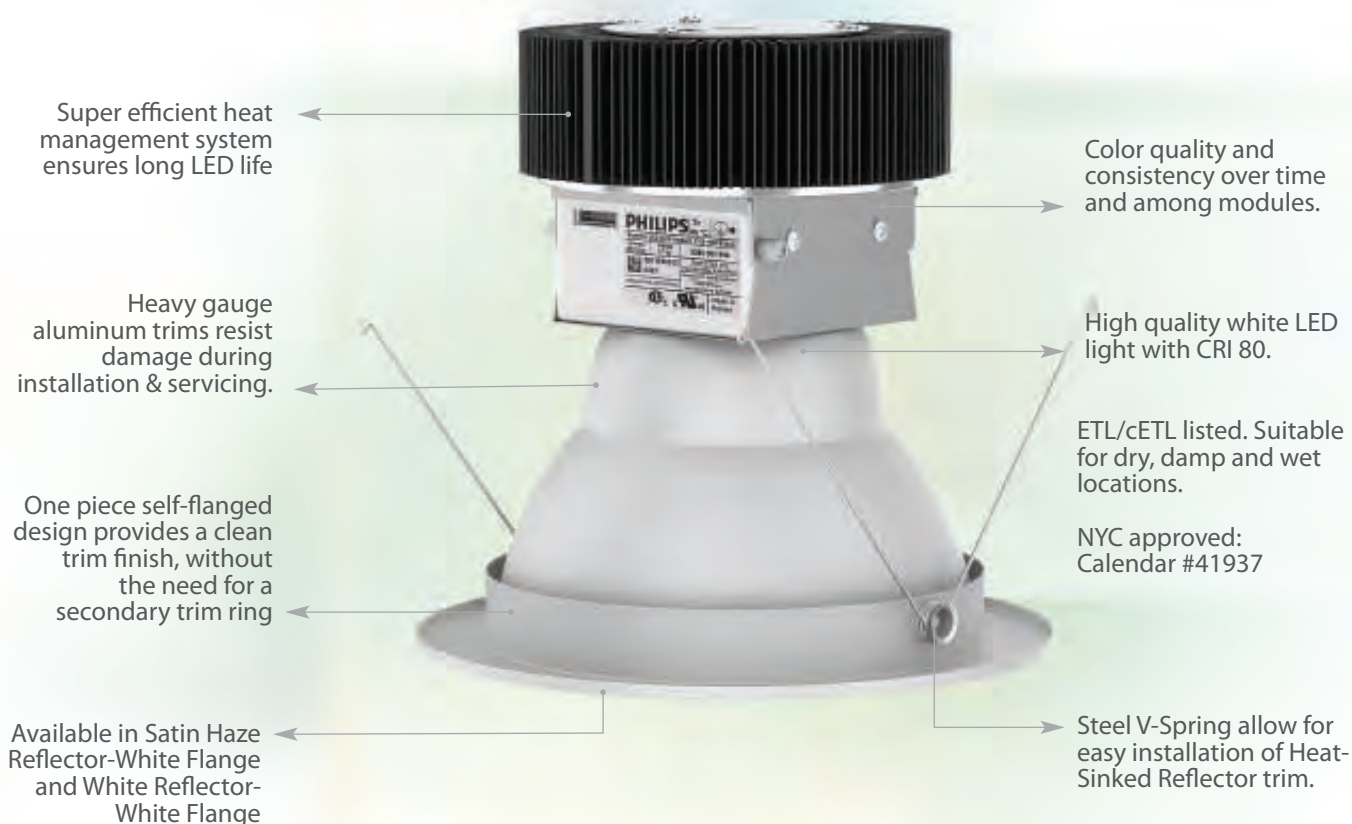

• V-Spring for Easy Installation



• Quick Connect Flex Conduit



• Remote Phosphor Downlight



• Triple Slot Hanger Bar Brackets



• 64 Cubic-Inch Double J-box

ALL LITON ARCHITECTURAL LED PRODUCTS ARE MADE IN THE USA AND INCLUDE A 5-YEAR LIMITED WARRANTY

# LHFLD636 / LRFLD6

LED 6" REMOTE PHOSPHOR DOWNLIGHT | FORTIMO

Remote  
Phosphor

## APPLICATIONS

Architectural-grade recessed LED new construction downlight housing for medium to high ceilings in commercial and architectural spaces. Deeply recessed reflector design eliminates glare. Remote Phosphor LED design eliminates visible LEDs.



6" HOUSING WITH REFLECTOR TRIM

## ARCHITECTURAL SPECIFICATIONS

LED	Philips Fortimo
LUMEN PACKAGES	20W (1100 Lumen), 36W (2000 Lumen)
CCT	3000K Standard, Binned to 3-Step MacAdam Ellipses (SDCM) 3500K and 4000K Optional, Binned to ANSI Standard
CRI	80+ Standard
GLARE CUT-OFF	50°
DIMMING OPTIONS	0-10V 10%
EMERGENCY OPTIONS	EM-10W
INPUT	120V/277V
LED TRIM CONNECTOR	Heavy Duty Quick Connector

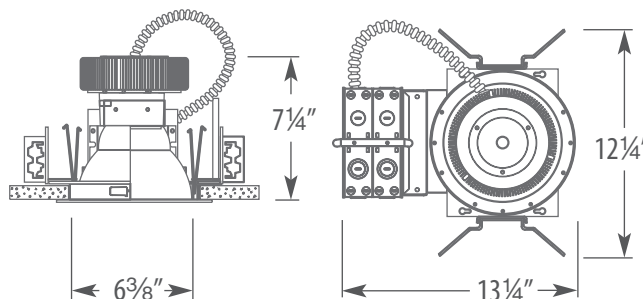

## PHOTOMETRY

TEST DATA
<b>6" LED DOWNLIGHT LUMINAIRE</b>
Color Rendering Index (CRI): 79.01
Report File#
By: Lighting Sciences, Inc.

FIXTURE DATA		
LED LUMEN	FIXTURE LUMEN	INPUT WATT.
1100 Lm	800 Lm	18W
2000 Lm	1400 Lm	36W

MULTIPLIERS			
FINISHES		LED LUMENS	
Satin Haze	1.0	2000 Lm	1.00
White	0.9	1100 Lm	0.55

INTENSITY SUMMARY	
ANGLE	LUMINANCE
0.0	1075
5.0	1060
11.0	1020
15.0	979
22.0	893
25.5	836
33.0	577
37.5	401

ZONAL LUMEN SUMMARY		
ZONE	LUMENS	%LUMINAIRE
0-30	718.78	52.50
0-40	1005.18	73.40
0-60	1265.86	92.50
0-90	1368.53	100.00

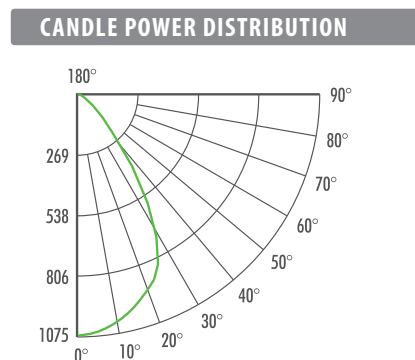

## ORDERING

Example: **LHFLD636C070UE / LRFLD6SWF110-T30**

HOUSING	DRIVER TYPE (120V/277V)	OPTION
<b>LHFLD636</b> NEW CONSTRUCTION	<b>C070UE</b> : Non Dimming	<b>Blank</b> : None
	<b>C070UE-D10</b> : 0-10V (10% Dimming)	<b>-EM</b> : Emergency Battery Pack
		<b>/L270</b> : Linear Hanger Bars
		<b>/C260</b> : C-Channel Hanger Bars

TRIM	REFLECTOR/FLANGE FINISH	LUMEN PACKAGE	COLOR TEMP
<b>LRFLD6</b>	<b>SWF</b> : Satin Haze / White	<b>110</b> : 20W / 1100Lm	<b>T30</b> : 3000K
	<b>WWF</b> : White / White	<b>200</b> : 36W / 2000Lm	<b>T35</b> : 3500K
			<b>T40</b> : 4000K

6  
INCH



6" ADJUSTABLE LED TRIM

## ARCHITECTURAL LED DOWNLIGHT SERIES

# LHBLD625 / LR6L88

LED 6" ADJ. WALL WASH | 1400 LUMEN | 2000 LUMEN

## APPLICATIONS

- Architectural-grade adjustable recessed LED downlight for commercial and architectural applications.
- The high degree of adjustability within the trim allows direction of the beam to almost any task area including floors, walls, fixtures and walkways.

- Perfect for constantly changing retail environments and for accenting artwork, sculptures and any other prominent feature in an inconspicuous way.
- Made of heavy-duty die-cast aluminum for rigid, reliable aiming and long life.



## 6" ADJUSTABLE LED TRIM

Trim is constructed of heavy -duty die-cast aluminum and powder coated for durability.

30°  
ADJUSTABLE

Available in Black (1400 Lumen or 2000 Lumen), and White (1400 Lumen or 2000 Lumen).

358°  
ROTATION

## ADJUSTABILITY

Solid die-cast trim design provides 30 degrees of adjustment in either direction and 358 degrees rotation allowing aiming of the beam in almost any downward direction.

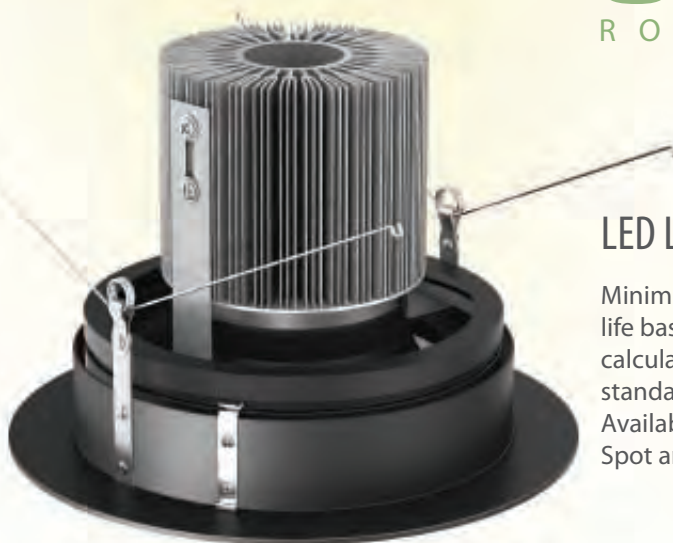

## LED LAMP LIFE

Minimum 50,000 hours L70 life based on ANSI TM-21 calculations from LM80 standardized test results. Available in Narrow Flood, Spot and Wide Flood.



# LHBLD6 / LR6L88

LED 6" ADJ. WALL WASH | 1400 LUMEN | 2000 LUMEN

## APPLICATIONS

- Architectural-grade adjustable recessed LED downlight for commercial and architectural applications.
- The high degree of adjustability within the trim allows direction of the beam to almost any task area including floors, walls, fixtures and walkways.

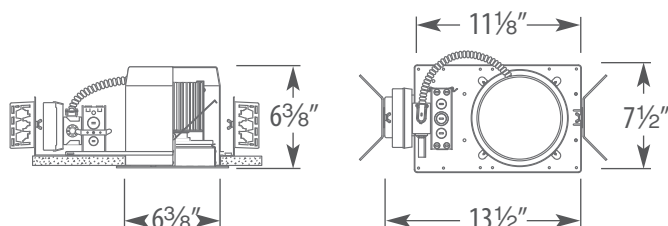

6" ADJUSTABLE LED HOUSING AND TRIM

## ARCHITECTURAL SPECIFICATIONS

LED	Bridgelux
LUMEN PACKAGES	19W (1400 Lumen), 25W (2000 Lumen)
CCT	3000K Standard, Binned to 3-Step MacAdam Ellipses (SDCM) 2700K, 3500K and 4000K Optional, Binned to ANSI Standard
CRI	80+ Standard, 90+ Option
GLARE CUT-OFF	50°
LED LAMP LIFE	50,000 Hours (L70)
DIMMING OPTIONS	0-10V 10%, ELV 5%, HiLume 1%, Incandescent 5%
EMERGENCY OPTIONS	EM2-10W, EM3-20W, Generator Transfer Device (GTD)
INPUT	120V/277V
LED TRIM CONNECTOR	Heavy Duty Quick Connector

## PHOTOMETRY

TEST DATA
<b>6" LED DOWNLIGHT LUMINAIRE</b>
Color Rendering Index (CRI): 83
Report File# 27120
By: Lighting Sciences, Inc.

FIXTURE DATA		
LED LUMEN	FIXTURE LUMEN	INPUT WATT.
1400 Lm	1136 Lm	23W
2000 Lm	1592 Lm	28W

MULTIPLIERS	
LED LUMENS	
2000 Lm	1.70
1400 Lm	1.00

INTENSITY SUMMARY	
ANGLE	MEAN CP
0	3940
5	3067
10	1929
15	1332
20	907
25	582
30	250
35	45

ZONAL LUMEN SUMMARY		
ZONE	LUMENS	%LUMINAIRE
0-30	882	94.15
0-40	928	98.99
0-60	937	99.95
0-180	937	100.00

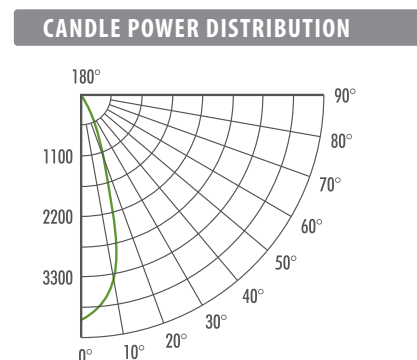

## ORDERING

Example: **LHBLD625C070UE-DUN / LR6L88B101**

HOUSING	DRIVER TYPE (120V/277V)	OPTION	TRIM	FINISH	LUMEN PACKAGE	CRI
<b>LHBLD625</b> NEW CONSTRUCTION	<b>C070UE</b> : Non Dimming	<b>Blank</b> : None	<b>LR6L88</b>	<b>B</b> : All Black	<b>101</b> : 19W / 1400Lm	<b>Blank</b> : 80+
	<b>C070UE-D10</b> : 0-10V (10% Dimming)	<b>-EM2</b> : Emergency (10W)		<b>W</b> : All White	<b>150</b> : 25W / 2000Lm	<b>-C90</b> : 90+
	<b>C070UE-DHL</b> : HiLume (1% Dimming)	<b>-EM3</b> : Emergency (20W)				
	<b>C070UE-DIN</b> : 2-Wire Dimming *	<b>-GTD</b> : Generator Transfer Device				
	<b>C070UE-DLV</b> : ELV 5% Dimming *					
	<b>C070UE-DUN</b> : UniDim™ (Universal)					

\* Dimmable in 120V operation only.

**LRALD6 LRALD8 & LRALD9**

LED RETROFIT 6" RECESSED | 8" RECESSED | 10" RECESSED

6", 8", AND 10" RETROFIT ARCHITECTURAL LED

**APPLICATIONS**

Architectural-grade recessed LED retrofit for low to high ceilings in architectural, hospitality and commercial installations. Easily converts inefficient Incandescent, Fluorescent and HID architectural fixtures to energy saving, low maintenance LED technology. Simply bypass existing power source, connect the retrofit in its place and install the trim into existing plaster frame.

- Easily replace old inefficient Incandescent, CFL and HID lighting with just a few easy steps:

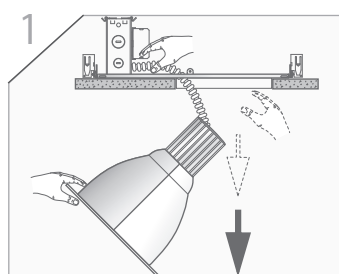

1 Remove the existing trim from the plaster frame.

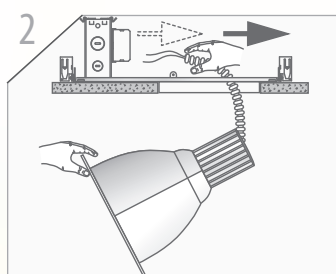

2 Disconnect the existing socket cap from the j-box and discard.

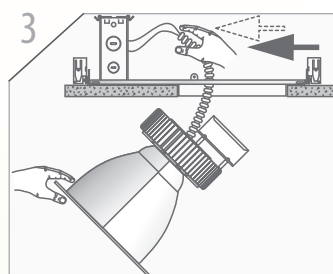

3 Connect the Liton LED Retrofit heavy duty conduit to the power supply.

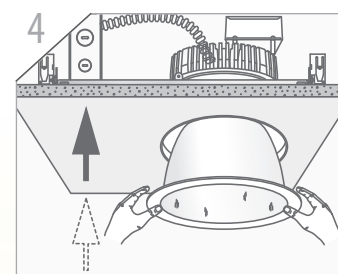

4 Install the Retrofit LED trim into the plaster frame.

Large integral heat sink cools LED and maintains long LED life

LED is available in 25 watt

Deeply recessed LED Module provides over 50° of visual cutoff for glare-free comfort

One Piece Self-flanged trim allows hassle free installation



Lumen package of 2000Lm

3000K Color Temperature is standard

2700K, 4000K and 5000K are available as special order. Extended lead times may apply

80 CRI is Standard, High 90CRI Option is available

Heavy gauge aluminum reflectors resist damage during installation & servicing

**ORDERING**Example: **LRALD6SWF150-R25UE**

TRIM	REFLECTOR/FLANGE FINISH	DRIVER TYPE
<b>LRALD6</b> 6¾" cut-out diameter	<b>SWF150-R25UE</b> : Satin Reflector/White Flange	<b>Blank</b> : 120V/277V
<b>LRALD8</b> 8½" cut-out diameter	<b>WWF150-R25UE</b> : White Reflector/White Flange	<b>-D10</b> : 0-10V Dimming
<b>LRALD9</b> 9½" cut-out diameter		

# LRCLD678

LED SHALLOW RETROFIT | 6" ADJUSTABLE DOWNLIGHT

Retrofit

## APPLICATIONS

Shallow Architectural Adjustable LED Retrofit for low to high ceilings in architectural, hospitality and commercial installations. Easily converts inefficient Incandescent, Fluorescent and HID architectural fixtures to energy saving, low maintenance LED technology. Simply bypass existing power source, connect the units' electrical conduit in its place and install the trim into existing plaster frame. Provides horizontal and vertical adjustability for wall wash applications and a low profile for areas with a shallow plenum.

## ARCHITECTURAL SPECIFICATIONS

LED	Bridgelux
LUMEN PACKAGES	16W (1200 Lumen)
CCT	3000K Standard, Binned to 3-Step MacAdam Ellipses (SDCM) 2700K, 3500K and 4000K Optional, Binned to ANSI Standard
CRI	80+ Standard, 90+ Option
DIMMING OPTIONS	ELV 5%, Incandescent 5%
INPUT	120V, 120V/277V
LED TRIM CONNECTOR	Heavy Duty Quick Connector



6" SHALLOW RETROFIT ADJUSTABLE LED

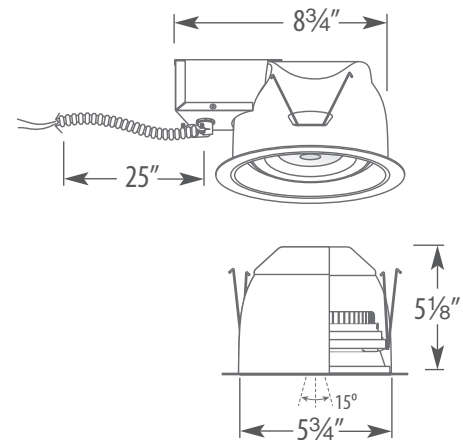

## PHOTOMETRY

TEST DATA
<b>6" LED SHALLOW RETROFIT ARCHITECTURAL</b>
Color Rendering Index (CRI): 88
Test Procedure LM-79-08
By: Light Laboratory, Inc.

FIXTURE DATA	
FIXTURE LUMEN	INPUT WATT.
1153 Lm	15.47W

### CANDLE POWER DISTRIBUTION

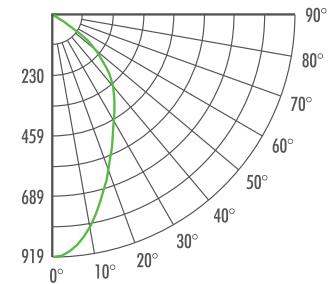

INTENSITY SUMMARY	
ANGLE	MEAN CP
0	918.88
5	3695.49
10	2571.99
15	1911.24
20	1418.36
25	990.06
30	391.72
35	195.86

ZONAL LUMEN SUMMARY		
ZONE	LUMENS	%LUMINAIRE
0-30	526.98	24.50
0-40	780.51	67.70
0-60	1124.32	97.50
0-90	1152.69	100.00

## ORDERING

Example: **LRCLD678W-B25-R16**

TRIM	FINISH	BEAM SPREAD	DRIVER TYPE
<b>LRCLD678</b>	<b>W</b> : All White	<b>-B25</b> : Narrow Flood	<b>-R16</b> : 120V
	<b>B</b> : All Black	<b>-B45</b> : Flood	<b>-R16UE</b> : 120V/277V
		<b>-B60</b> : Wide Flood	<b>-R16UE-DIN</b> : ELV/Incandescent Dimming
		<b>-B120</b> : Superwide Flood	



# Liton®

LED ARCHITECTURAL

# ARCHITECTURAL



©2013 Liton Lighting  
"The Complete Lighting Solution"  
Liton Lighting is a division of  
EEMA Lighting Group

5461 West Jefferson Boulevard  
Los Angeles, CA 90016  
Phone: 1.800.515.4880  
Visit us on the web: [www.liton.com](http://www.liton.com)

**eema**  
LIGHTING GROUP

quality  
lighting  
even better

ES

ENERGY  
STAR  
PARTNER