

LCALDJ : CYLOPRO ADJUSTABLE ACCENT

SURFACE/WALL/PENDANT/TRACK 700LM - 4500LM (10W - 45W)

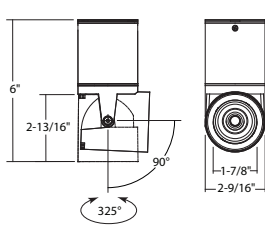

LCALDJ2

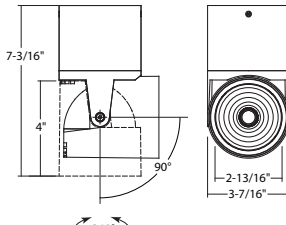

LCALDJ3

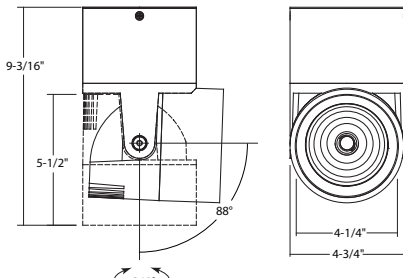

LCALDJ5

ORDERING : LCALDJ2W-L07-B25UE-DUN-T27-STM24-FR

Fixture	Finish	Lumens	Beam Spread	Control	Color Temperature	Mounting	Accessories
Fixture	Finish	Lumens	Beam Spread	Control	Color Temperature	Mounting	Accessories
2.5" (700lm or 1000lm)	LCALDJ2	White	W	LCALDJ2 - 700lm (10W)	-L07	40° Flood	Blank
3.5" (1500lm or 2000lm)	LCALDJ3	Black	B	LCALDJ2 - 1000lm (15W)	-L09	15° Narrow Spot	-B15
5" (2000lm - 4500lm)	LCALDJ5			LCALDJ3 - 1500lm (20W)	-L15	25° Narrow Flood	-B25
				LCALDJ3 - 2000lm (30W)	-L20	60° Wide Flood	-B60²
				LCALDJ5 - 2000lm (20W)	-L21		
				LCALDJ5 - 2500lm (30W)	-L25		
				LCALDJ5 - 3500lm (40W)	-L35		
				LCALDJ5 - 4500lm (45W)	-L45		
Control	Color Temperature	Mounting	Accessories				
Non-Dimming (120V)	Blank	3000K (90 CRI)	Blank	Surface Mount	-40	None	Blank
TRIAC/ELV Dimming (120V)	-DIN⁸	3000K (97 CRI)	-T30-C97	(4" Octagonal Jbox)		Frosted Lens	-FR
0-10V Dimming (120V/277V)	UE-D10	2700K (90 CRI)	-T27	12" Stem Pendant	-STM12	Louver	-LVR²
UniDim™ 0-10V, TRIAC/ELV Dimming (120V/277V)	UE-DUN	2700K (97 CRI)	-T27-C97	24" Stem Pendant	-STM24	Integral Emergency Back Pack	-EMA¹
Dali Dimming (120V/277V)	UE-DL1^{3,4,8}	3500K (90 CRI)	-T35	36" Stem Pendant	-STM36		
Athena Wireless Node (120V)	-AWN⁵	4000K (90 CRI)	-T40	48" Stem Pendant	-STM48		
Casambi Wireless Dimming (120V/277V)	-DCSM⁵	1850K-3000K Warm Dimming	-TWD^{2,6}	12" Stem Pendant (Sloped Ceiling)	-STM12J		
BubblyNet Wireless System (120V/277V)	-DBNT⁵			24" Stem Pendant (Sloped Ceiling)	-STM24J		
				36" Stem Pendant (Sloped Ceiling)	-STM36J		
				48" Stem Pendant (Sloped Ceiling)	-STM48J		
				72" 5-Wire Cord Mount	-CRD72		
				1CCT/1NT Connector	-1C1N^{2,7}		
				2CCT/2NT Connector	-2C2N^{2,7}		
				3CCT/1NT Connector	-3C1N^{2,7}		

¹ Only available for LCALDJ2.

² Only available for LCALDJ2 and LCALDJ3.

³ Only available for LCALDJ3 and LCALDJ5.

⁴ (LCALDJ5) Special Order.

⁵ Special Order. Must be ordered with LCMPD7-EMA-BLANK.

⁶ (-L15, -L25, and -L35) not available with Warm Dimming.

⁷ (UE-DL1, -AWN, and -DBNT) option not available for track mounting.

⁸ (LCALDJ3) Special Order. Extended lead time may apply. Consult Factory.

SPECIFICATION

Application

Architectural-grade surface, pendant and track mount adjustable accent LED provides you the flexibility to put the light where and how you want it, whether into tight corners or accenting your favorite collection.

Housing

Extruded aluminum with die-cast aluminum swivel and one piece combination heat sink and reflector enclosure. Luminaire is adjustable with maximum swivel angle to 85° off center, and a 325° rotation.

Optics

LED Light Engine :

COB (Chip on Board) Meets CA Title 24 Requirements and other standards restricting the use of Medium Base or Bi-Pin Sockets.

Color Temperature:

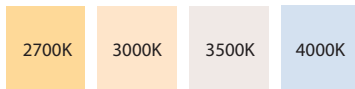

Available in 3000K (90 CRI) standard. Optional (90 CRI) 3500K and 4000K and (97 CRI) 2700K and 3000K are also available.

Beam Spread:

Multifaceted glare reducing anodized reflector held in place with die-cast aluminum holder. Available in Standard 40° Flood (Blank). Also available in 15° Narrow Spot (B15), 25° Narrow Flood (B25), and 60° Wide Flood (B60).

Lumen Maintenance:

Minimum 50,000 hours L70 life based on ANSI TM-21 calculations from LM80 standardized test results.

Reflector

Multifaceted polycarbonate Total Internal Reflection (TIR) optic.

Thermal Management

Heat dissipation facilitated by exposed integral aluminum heat sink to maximize heat rejection in an open air environment. Recommended ambient temperature is below 35°C to achieve minimum L70 life of 50,000 hours according to LM80 standard.

Driver

120V/277V AC 50/60Hz Electronic Direct Current Class 2 driver integrally mounted on large access Junction Box. Power Factor > 0.90. Operating Temperature: -10°C to +80°C.

SPECIFICATION (Continued)**Control**

Options include 120V Triac/ELV (-DIN); 120V/277V 0-10V (UE-D10), and 120V/277V TRIAC/ELV 0-10V (UE-DUN).

CASAMBI WIRELESS FIXTURE DIMMING CONTROL (-DCSM)

- Wireless technology with (BLE) Bluetooth Low Energy
- Mesh network connectivity and control
- Signal can be boosted by enabling openings near the module. Consult Factory.

**Finish**

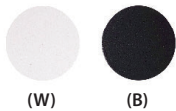

High quality powder coat finish for maximum durability. Available in White (W), and Black (B). Consult factory for Custom Color.

Safety Labels

ETL/cETL listed to UL1598 and UL8750. Suitable for dry and damp locations. NYC approved: Calendar #41937. Assembled in USA.

Caution

Fixtures must be grounded in accordance with national, state and/or local electrical codes. Failure to do so may result in serious personal injury.

Warranty

Covered by a 5-Year Warranty to be free of defects in materials and craftsmanship. Recommended for applications where ambient temperatures do not exceed 60°C, installations exceeding this temperature will result in reduced LED lamp life and a voided warranty.