

Remodel Housing w/ T4 Pull Down

LH1399 SERIES - 3" LOW VOLTAGE RECESSED LIGHTING

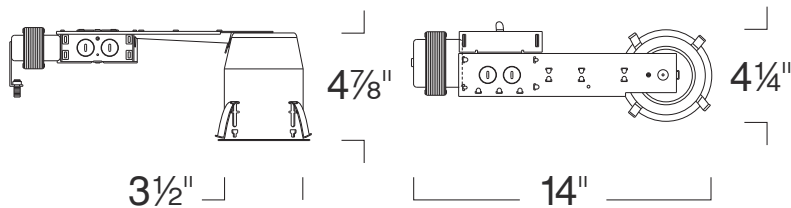

SPECIFICATION

Ceiling cut-out: 3 3/4"

Application: General purpose recessed downlight housing for low to medium height ceilings for residential and light commercial applications. A variety of trims, compatible styles and finishes are available to achieve the desired décor and illumination.

Housing: Pre-wired housing adjusts up to a 1 1/4" ceiling thickness. Integral thermal protector to guard against improper lamping and installation. Trim is secured with torsion wing springs.

Mounting: Housing suitable for new construction installations only, supplied with (2) 24" adjustable hanger bars with 90 degrees repositioning ability. Hanger bars equipped with nail-less install 3/4" serrated barbed studs and with captive nails, for faster and easier secure mounting in wood joists. Set-screws lock into position and prevent shifting after installation. Earthquake structural cable compatible for drop panel ceiling or any other mounting that requires direct support from structural ceilings.

Transformer: High quality insulated transformer installed adjacent to Junction Box, bottom and top accessible. Thermally protected rated for 90° C. Available in magnetic or "noise-free" electronic.

Socket: 2-pin porcelain socket with aluminum heat sink plate. Lamp clips to trim to ensure proper and consistent positioning.

Junction Box : 16 gauge pre-wired galvanized steel Junction Box, 32 cubic-inch for a maximum of (8) #12 AWG wires. Furnished with (7) 3/4" and (4) Romex knock-outs. Strain clamps to install or remove covers for easy access and ground wire. Equipped with safety standard fitting for flex-conduit.

Insulation Contact: Non-IC rated housing must be kept 3" from insulation.

Airflow: Airtight option is designed to restrict air flow from room into plenums in compliance to the WSEC - Washington State Energy Code, (Less than 2.0 CFM -Cubic Feet per Minute). Complies to Title24 air flow requirements (Air-tight).

Safety Labels: UL/CUL listed for through-branch wiring (8) No.12 AWG 90°C and suitable for damp locations. NYC approved: Calendar #41937.

Label: cETL Listed

FEATURE:



Application: Provides flexibility and versatility by doubling as both a downlight and as an accent light. This trim has a larger degree of rotation resulting in both visual style and practical ergonomics.

Socket: 2 pin porcelain socket included with trim. Some wiring required.

Gasket: Supplied with gasket to prevent light leakage and unsightly heat streaks on ceiling surface.

Lens Inclusion: Clear glass protective safety lens included in packaging.

Mounting: Steel pressure springs mounted on trim to ensure positive retention inside housing.

Adjustability Lamp can be tilted 85° degrees vertically and rotated 358° degrees horizontally.

Label: UL Listed, cETL Listed

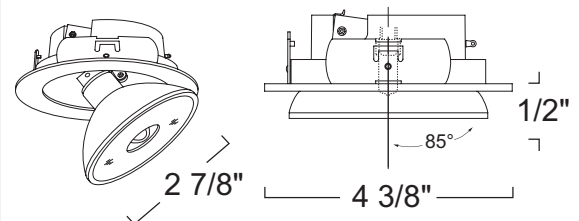

REMODEL HOUSING
LH1399R 12V Out 50W Max MR16

RATING	WATTAGE
LH1399RA: Airtight	Blank :50W

T4 PULL DOWN
LR1396 12V 50W Max T4/T3

FINISH
LR1396B :Black
LR1396C :Chrome
LR1396G :Gold

Ordering example: LH1399RA/LR1396C