

Standard E26 Housing w/ Deco Glass Open Dome Baffle LH7 SERIES - 6" LINE VOLTAGE RECESSED LIGHTING

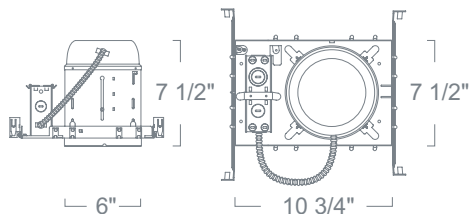

SPECIFICATION

Ceiling cut-out: 6 1/2"

Application: General purpose recessed downlight housing for medium to high ceilings for residential and light commercial applications. A variety of trims, compatible styles and finishes are available to achieve the proper décor and illumination.

Housing: Pre-wired housing adjusts up to a 1 1/2" ceiling thickness. Integral thermal protector to guard against improper lamping and installation. Housing provides an adjustable socket plate which allows for use of different lamp types. Trim is secured with torsion wing springs/standard coil springs or serrated clips.

Mounting: Housing suitable for new construction installations only, supplied with (2) 24" adjustable hanger bars with 90 degrees repositioning ability. Hanger bars equipped with nail-less install 3/4" serrated barbed studs and with captive nails, for faster and easier secure mounting in wood joists. Set-screws lock into position and prevent shifting after installation. Earthquake structural cable compatible for drop panel ceiling or any other mounting that requires direct support from structural ceilings.

Socket: Standard porcelain medium screw base socket with high temperature leads.

Junction Box : 16 gauge pre-wired galvanized steel Junction Box, 32 cubic-inch for a maximum of (8) #12 AWG wires. Furnished with (7) 3/4" and (4) Romex knock-outs. Strain clamps to install or remove covers for easy access and ground wire. Equipped with safety standard fitting for flex-conduit.

Insulation Contact: Non-IC rated housing must be kept 3" from insulation.

Airflow: Airtight option is designed to restrict air flow from room into plenums in compliance to the WSEC - Washington State Energy Code, (Less than 2.0 CFM -Cubic Feet per Minute). Complies to Title24 air flow requirements (Air-tight).

Safety Labels: UL/CUL listed for through-branch wiring (8) No.12 AWG 90°C and suitable for damp locations. NYC approved: Calendar #41937.

Label: UL Listed

FEATURE:



Application: Decorative glass trims add a unique architectural dimension to your lighting design. These attractive glass trims that emit a warm and glowing illumination are available in various colors. Each glass trim and color combination will create an artful illumination that compliments any interior environment.

Mounting: Steel pressure springs mounted on trim to ensure positive retention inside housing.

Label: UL Listed, cETL Listed

Limitation: Not for use w/Shallow Housings.

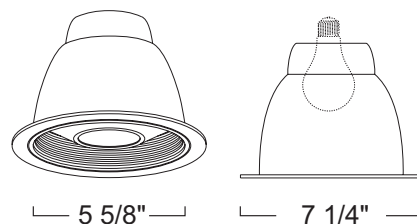

STANDARD E26 HOUSING LH7 120V 150W Max R30/PAR30/PAR38/A19 MED E26

RATING	
LH7	:Standard
LH7A	:Airtight
LH7ICA	:IC-Airtight

DECO GLASS OPEN DOME BAFFLE LR470 120V/CFL 100W Max A19/PAR20

BAFFLE FINISH	RING FINISH	GLASS
LR470W :White	Blank :White	-AM :Amber
LR470B :Black	B :Black	-BL :Blue
LR470N :All Natural*	N :Natural	-FR :Frosted
LR470CO :All Copper*	CO :Copper	
LR470MO :All Mocha*	MO :Mocha	

* Comes standard with a matching ring finish. Use "W" for White Ring.

Ordering example: LH7/LR470W-AM