

## LHABSHLD4 : 4" SUPER SHALLOW LUMENBLAST

OPEN DOWNLIGHTS, ROUND, 1200LM - 3000LM (10W-30W)

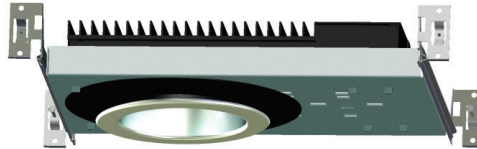
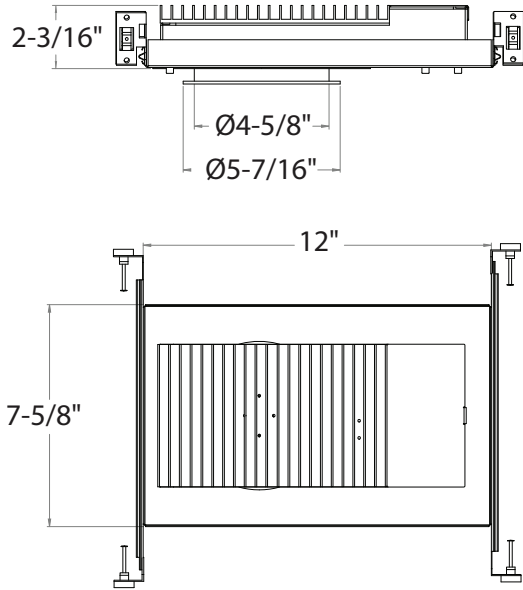

- Low Glare Design
- Highly efficient COB (Chip on Board) LED
- For Super Shallow 2-3/16" ceiling
- Small 4" aperture
- Fits Round Trims

### ORDERING : LHABSHLD410C025-DIN-B15-T27/LRBSHL4SSF

#### LHABSHLD4

Fixture	Lumens	Control	Beam Spread	Color Temperature	Trim
<b>Lumens</b>	<b>Control</b>	<b>Beam Spread</b>	<b>Color Temperature</b>	<b>Trim</b>	
1200lm (10W) <b>12C025</b>	Non-Dimming (120V)	<b>Blank</b>	15° Spot	<b>-B15</b> 2700K (80 CRI) <b>-T27</b>	All Satin <b>LRBSHL4SSF</b>
1200lm (10W) (IC RATED) <b>12C025-IC</b>	TRIAC/ELV Dimming (120V)	<b>-DIN</b>	25° Narrow Flood	<b>-B25</b> 2700K (97 CRI) <b>-T27-C97<sup>1</sup></b>	Satin Haze/White <b>LRBSHL4SWF</b>
1800lm (15W) <b>18C035</b>	0-10V Dimming (120V/277V)	<b>UE-D10</b>	35° Flood	<b>-B35</b> 3000K (80 CRI) <b>-T30</b>	All White <b>LRBSHL4WWF</b>
1800lm (15W) (IC RATED) <b>18C035-IC</b>	1%, 0-10V Dimming (120V/277V)	<b>UE-D10P1</b>	50° Wide Flood	<b>-B50</b> 3000K (97 CRI) <b>-T30-C97<sup>1</sup></b>	All Black <b>LRBSHL4BBF</b>
2400lm (20W) <b>24C050</b>	UniDim™ 0-10V, ELV, Triac Dimming (120V/277V)	<b>UE-DUN</b>		3500K (90 CRI) <b>-T35</b>	
3000lm (30W) <b>30C070</b>				4000K (90 CRI) <b>-T40</b>	

2026.02.16

<sup>1</sup> Special order. Minimum Order. Extended lead time may apply. Consult Factory.

## SPECIFICATION

### Application

---

The 4" LumenBlast Shallow housing is designed for low to medium ceiling heights and is available as a fixed downlight with multiple beam spreads. With four trim finishes, the luminaire is perfect for ambient and task down-lighting in residential and commercial applications with shallow plenums.

### Housing

---

Constructed with 0.05" aluminum housing with baked enamel finish, suitable for new construction installations. Designed to secure to existing sheet rock or panel ceilings up to 3/4" thick.

### Mounting

---

Housing suitable for new construction, supplied with (2) 24" adjustable hanger bars. Hanger bars equipped with nail-less install 3/4" serrated barbed studs and with captive nails, for faster and easier secure mounting in wood joists. Set-screws lock into position and prevent shifting after installation. Earthquake structural cable compatible for drop panel ceiling or any other mounting that requires direct support from structural ceiling.

### Trim Ring

---

Friction clips hold Round trim secure to Housing Frame. Open trims are available in All Satin Haze (LRBSHL4SSF), Satin Haze/White (LRBSHL4SWF), All White (LRBSHL4WWF), and All Black (LRBSHL4BBF).

### Certifications and Listings:

---



ETL / cETL Listed to UL1598 and UL8750 standards.

Suitable for dry and damp locations.

NYC approved: Calendar #41937.

### Insulation Contact

---

IC-Rated options (-IC) is for direct contact with low to medium density loose fill blown and rolled insulation.

### Warranty

---

Covered by a 5-Year Warranty to be free of defects in materials and craftsmanship. Fixture should not be installed in applications with ambient temperature above 35°C. Doing so will result in reduced lamp life and voided warranty.

## SPECIFICATION (Continued)

### Light Source

LED Light Engine:

COB (Chip on Board) LED is replaceable via quick disconnect terminal. Meets CA Title 24 Requirements and other standards restricting the use of Medium Base or Bi-Pin Sockets.

Color Temperature:

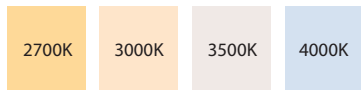

Available LEDs binned to 3-step MacAdam ellipses within the ANSI C78 377A standard for color temperature and chromaticity ranges light binning allowance.

Consult factory for availability and lead time for 2 SDCM.

Color temperatures available include 2700K, 3000K, 3500K, and 4000K.

90 CRI standard.

2700K and 3000K also available in 97 CRI.

Beam Spread:

Available in 15° Spot (-B15), 25° Narrow Flood (-B25), 35° Flood (-B35), and 50° Wide Flood (-B50).

Lumen Maintenance:

Lumen Maintenance is minimum 72,000 hours L70 life based on ANSI TM-21 calculations from LM80 standardized test results.

### Control Options

#### ELV and TRIAC Driver 120V (-DIN):

Compatible with electronic low voltage, and 2-Wire incandescent dimmers. Also known as leading edge, Reverse Phase, Forward Phase dimming. Allows smooth dimming down to 5% depending upon the dimmer's limitations.

#### 0-10V Driver 120V/277V (UE-D10):

Compatible with most existing 0-10V systems. Also known as fluorescent or 5-Wire dimming. Allows smooth dimming down to 5% depending upon the dimmer's limitations. Compatible with daylight harvesting controls.

#### UniDim™ Driver 120V/277V (UE-DUN):

All in one ELV and TRIAC phase dimming (120V only), and 0-10V dimming (120V/277V). Works with most 3-Wire ELV, 2-Wire incandescent and 120V/277V 5-Wire 0-10V fluorescent dimmers.

Incandescent/Phase Wiring  
ELV

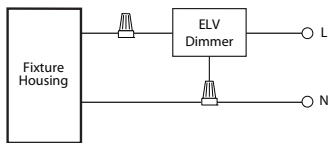

TRIAC

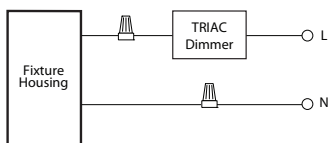

0 - 10V Wiring

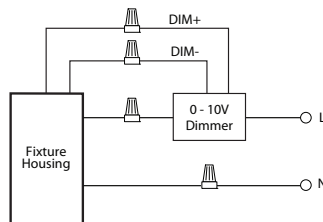

Incandescent/Phase Wiring  
ELV

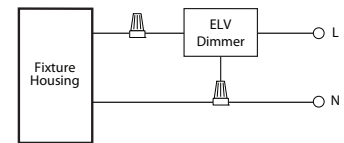

TRIAC

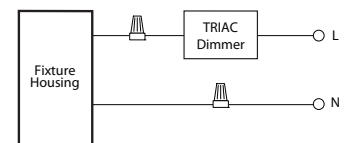

0 - 10V Wiring

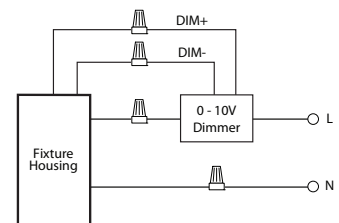

## PHOTOMETRY

### LHABSHLD440C070UE-D10-B25-T30/LRBSHL4WWF (3000lm, 30W, 25°, 3000K)

System Power:	29.5 W	MULTIPLIERS
Test Date:	01/2026	LUMENS
Beam Angle 50%:	27.6°	12C025: 0.37
Field Angle 10%:	48.7°	18C035: 0.51
Color Temperature:	3009 K	24C050: 0.77
CRI:	91.6	<b>30C070: 1.00</b>
Lumens Delivered:	2312	CCT
CBCP:	9003	2700K: 0.80
Power Factor:	0.99	<b>3000K: 1.00</b>
		3500K: 1.02
		4000K: 1.03
		5000K: 1.05

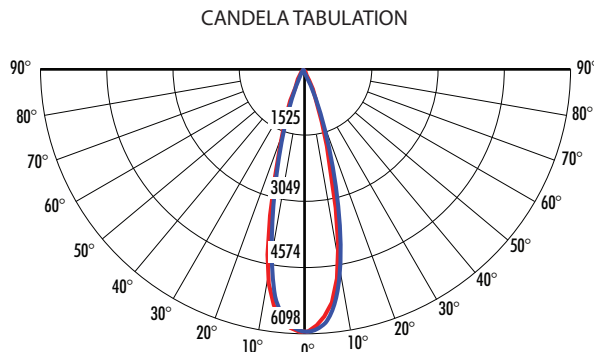

FOOTCANDLE DISTRIBUTION		
Height	Beam Diameter	FC
8.0'	3.9'	140.7
15.0'	7.3'	40.0
25.0'	12.2'	14.4
30.0'	14.7'	10.0
42.0'	20.6'	5.1

### LHABSHLD440C070UE-D10-B35-T30/LRBSHL4WWF (3000lm, 30W, 35°, 3000K)

System Power:	29.5 W	MULTIPLIERS
Test Date:	01/2026	LUMENS
Beam Angle 50%:	38.1°	12C025: 0.37
Field Angle 10%:	57.6°	18C035: 0.51
Color Temperature:	3009 K	24C050: 0.77
CRI:	91.6	<b>30C070: 1.00</b>
Lumens Delivered:	2516	CCT
CBCP:	6307	2700K: 0.80
Power Factor:	0.99	<b>3000K: 1.00</b>
		3500K: 1.02
		4000K: 1.03
		5000K: 1.05

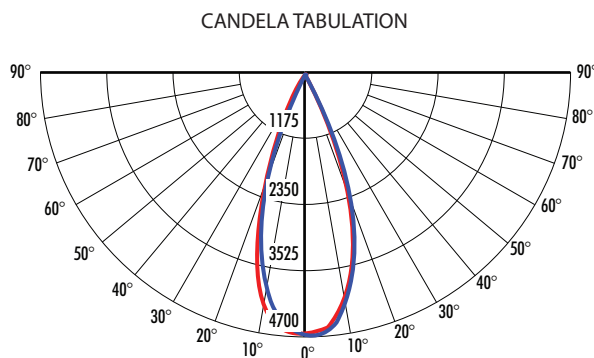

FOOTCANDLE DISTRIBUTION		
Height	Beam Diameter	FC
8.0'	5.5'	98.5
15.0'	10.3'	28.0
20.0'	13.8'	15.8
30.0'	20.7'	7.0
35.0'	24.1'	5.1

### LHABSHLD440C070UE-D10-B45-T30/LRBSHL4WWF (3000lm, 30W, 45°, 3000K)

System Power:	29.5 W	MULTIPLIERS
Test Date:	01/2026	LUMENS
Beam Angle 50%:	46.5°	12C025: 0.37
Field Angle 10%:	66.9°	18C035: 0.51
Color Temperature:	3009 K	24C050: 0.77
CRI:	91.6	<b>30C070: 1.00</b>
Lumens Delivered:	2659	CCT
CBCP:	4855	2700K: 0.80
Power Factor:	0.99	<b>3000K: 1.00</b>
		3500K: 1.02
		4000K: 1.03
		5000K: 1.05

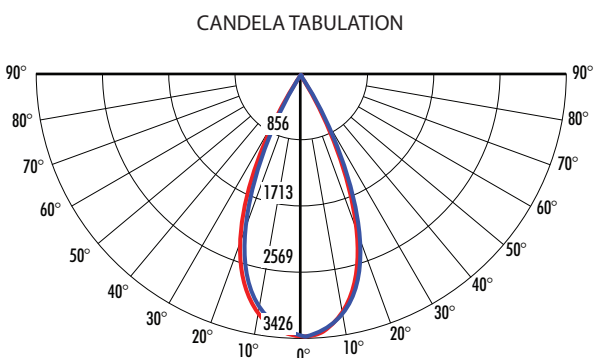

FOOTCANDLE DISTRIBUTION		
Height	Beam Diameter	FC
8.0'	6.9'	75.9
15.0'	12.9'	21.6
20.0'	17.2'	12.1
25.0'	21.0'	7.8
31.0'	26.7'	5.1

### LHABSHLD440C070UE-D10-B55-T30/LRBSHL4WWF (3000lm, 30W, 55°, 3000K)

System Power:	29.5 W	MULTIPLIERS
Test Date:	01/2026	LUMENS
Beam Angle 50%:	54.0°	12C025: 0.37
Field Angle 10%:	76.6°	18C035: 0.51
Color Temperature:	3009 K	24C050: 0.77
CRI:	91.6	<b>30C070: 1.00</b>
Lumens Delivered:	2796	CCT
CBCP:	3593	2700K: 0.80
Power Factor:	0.99	<b>3000K: 1.00</b>
		3500K: 1.02
		4000K: 1.03
		5000K: 1.05

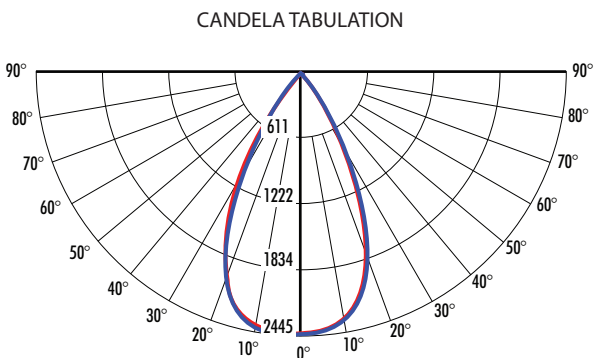

FOOTCANDLE DISTRIBUTION		
Height	Beam Diameter	FC
8.0'	8.2'	56.1
12.0'	12.3'	25.0
16.0'	13.6'	18.3
20.0'	20.4'	9.0
26.0'	26.5'	5.3