

LHAJLD4 : 4" LUMENBLAST

ADJUSTABLE ACCENT & LENSED WALL WASH, ROUND (1500LM - 5000LM)

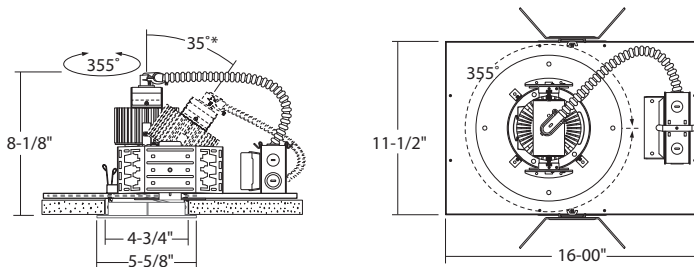

Ceiling Cut-out: 4-3/4" Dia.

*Maximum angle, Adjustable Accent only.

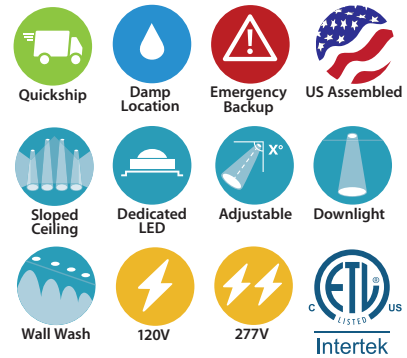

- Illuminate up to 70' ceilings
- Adjustable to 35° angle and 355° of rotation
- Wall Wash to provide uniform, even illumination
- Highly efficient COB (Chip on Board) LED

ORDERING : LHAJLD420C050UE-DUN-B45-T30-FS/LRA471S

LHAJLD4

Fixture	Lumens	Dimming	Beam Spread	Color Temperature	Frame Options	Trim
Adjustable Downlight	LHAJLD4	Non-Dimming Remote Driver UniDim™ 0-10V, ELV, Triac Dimming (5%)	Blank -RMT UE-DUN	15° Narrow Spot 25° Narrow Flood 45° Flood 60° Wide Flood	-B15 -B25 -B45 -B60	None Generator Transfer Device Single Fuse Remote Emergency Backup (12W) Remote Emergency Inverter (up to 28W)
Lumens (Nominal Delivered)		Wireless Enocean Adapter (10%)	UE-DEN	Color Temperature		C-Channel Hanger Bar Set
1500lm (9W)	12C025	DMX Dimming (0%)	UE-DMX	2700K, 80 CRI	-T27	Adjustable C-Channel Hanger Bar Set
2000lm (11W)	15C035	0-10V Dimming (1%)	UE-D10P1	2700K, 90 CRI	-T27-C90	
2500lm (19W)	20C050	347V 0-10V Dimming (5%)	-347-D10	3000K, 80 CRI	-T30	
3000lm (28W)	25C070	Lutron Hilume/ Ecoystem Dimming (1%)	UE-DHL	3000K, 90CRI	-T30-C90	
3500lm (39W)	30C085	120V 2-Wire Incandescent (1%)	DINP1	3500K, 80 CRI	-T35	
4500lm (44W)	35C105			4000K, 80 CRI	-T40	
5000lm (60W)	50C140			Warm dimming	-TWD ²	
				1850K-3000K		
				Tunable White	-TTW ³	
				2700K-6500K		
						Trim (Open Adjustable)
						All White
						All Black
						All Satin Haze
						Satin Haze/White
						Trim (Frosted Lens Wall Wash)
						All White
						All Black
						All Satin Haze
						Satin Haze/White

¹ All drivers are 120V/277V unless otherwise noted.

² Warm Dimming only available for 1500lm, 2000lm & 2500lm options.

³ Tunable White only available with 0-10V signal via "UE-D10P" option or DMX signal via "UE-DMX" option for 2000lm, 3000lm & 3500lm option only.

OPTIONS

/C260
C-Channel Hanger Bar Set



/C260-J
Adjustable C-Channel Hanger
Bar Set



SPECIFICATION

Application

The 4" LumenBlast housing is designed for medium to high ceiling heights and is available as an adjustable accent with 35° angle and 355° of rotation or wall wash to provide uniform, even illumination. With four trim options and four trim finishes, the luminaire offers the versatility and high lumen output that is ideal for classrooms, office lobbies and retail applications.

Housing Frame

16 gauge galvanized plaster ring with powder coat finish, six friction clips secure trim to housing for ceilings up to 2 1/4" thick.

Mounting

Housing suitable for new construction installations only, Bat-Wing bar hanger brackets adjust vertically 3 1/4" for multiple ceiling types and accepts 1/2" EMT. 26"C Channel Strut for T-bar ceilings and 27" adjustable linear hanger bars for plaster ceilings or wood/metal joists. Heavy duty 16-gauge, die-formed galvanized steel.
Bar hangers optional.

Optics

LED Light Engine

COB (Chip on Board) LED is replaceable via quick disconnect terminal. Meets CA Title 24 Requirements and other standards restricting the use of Medium Base or Bi-Pin Sockets.

Beam Spread

Available in 15° Narrow Spot (B15), 25° Narrow Flood (B25), 45° Flood (B45), 60° Wide Flood (B60).

Color Temperature

Comes standard with 3000K Warm White LEDs binned to 3-step MacAdam ellipses within the ANSI C78 377A standard for color temperature and chromaticity ranges light binning allowance. Also available in 2700K, 3500K and 4000K.

Color Rendering Index

Comes standard with 80 CRI. 90 CRI and 97 CRI (C97) option also available with 2700K and 3000K.

Warm Dimming

Optional from 1850K to 3500K. Only available for 1500lm, 2000lm & 2500lm options.

Tunable White

Optional with correlated color temperature range from 2700K to 5500K. Only available with 0-10V signal via "UE-D10P1" option or DMX signal via "UE-DMX" option for 2000lm, 3000lm & 3500lm option only.

Lumen Maintenance

Minimum 50,000 hours L70 life based on ANSI TM-21 calculations from LM80 standardized test results.

Thermal Management

Effective thermal dissipation facilitated by integral cast-aluminum, heat sink design for maximum heat rejection to provide long LED life.

SPECIFICATION (Continued)

Trims

Open adjustable trims are available in all White (LRA471W), all Black (LRA471B), all Satin Haze (LRA471B), and Satin Haze/White (LRA471SW). Frosted lens wall wash trims are available in all White (LRA472W), all Black (LRA472B), all Satin Haze (LRA472B), and Satin Haze/White (LRA472SW).

Certifications and Listings

ETL/cETL listed to UL1598 and UL8750.
Suitable for dry and damp locations.

Caution

Fixtures must be grounded in accordance with national, state and/or local electrical codes.
Failure to do so may result in serious personal injury.

Warranty

Covered by an 5-Year warranty for other driver options to be free of defects in materials and craftsmanship. Recommended for applications where ambient temperatures do not exceed 35°C. Installations exceeding this temperature will result in reduced LED lamp life and a voided warranty.