

LHLD26-FRM : 2.5" GEN2 P-SERIES NEW CONSTRUCTION FRAME ROUND/SQUARE

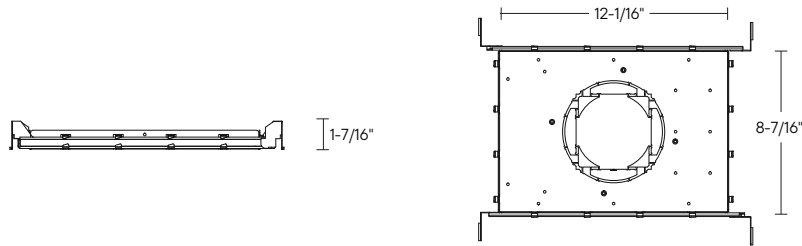

- New Construction Frame for new construction applications
- Lightweight-Durable, Galvanized Steel Frames
- Frame includes (x2) 24" Adjustable Hanger Bars
- Hanger bars equipped with 3/4" serrated barbed studs

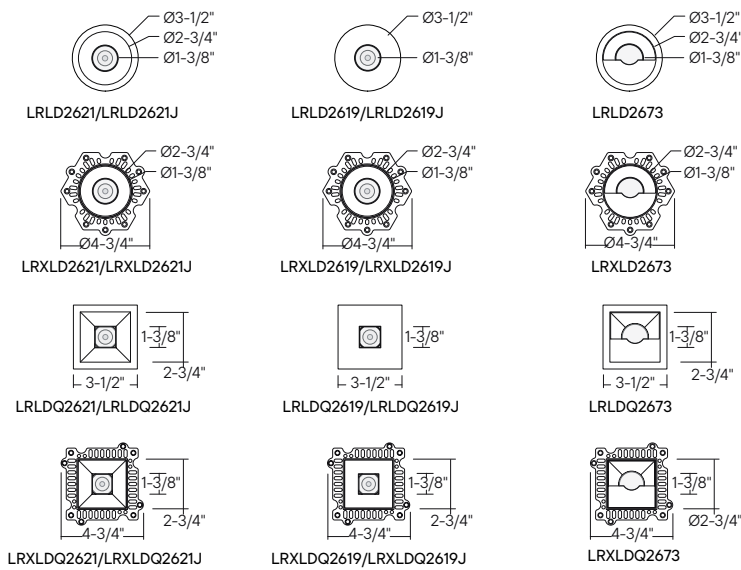
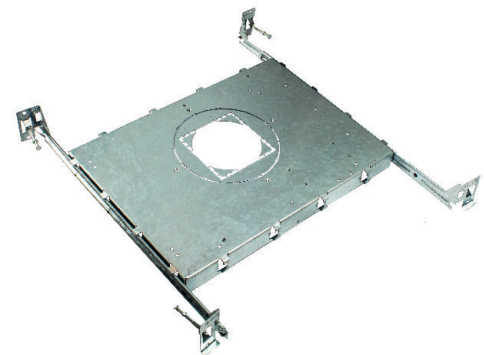

ORDERING : /LHLD26-FRM

/LHLD26-FRM

Housing

Housing

2.5" New Construction Frame **/LHLD26-FRM**

2025.11.17

SPECIFICATION

COMPATIBILITY

**LRLD2621/
LRXLD2621**

2.5" Gen 2 P-Series
Round Flanged or Trimless
Downlight
1,000lm - 2,400lm
(15 - 22W)

**LRLD2621J/
LRXLD2621J**

2.5" Gen 2 P-Series
Round Flanged or Trimless
Adjustable Downlight
1,000lm - 2,400lm
(15 - 22W)

**LRLD2619/
LRXLD2619**

2.5" Gen 2 P-Series
Round Flanged or Trimless
Downlight Pinhole
1,000lm - 2,400lm
(15 - 22W)

**LRLD2619J/
LRXLD2619J**

2.5" Gen 2 P-Series
Round Flanged or Trimless
Adjustable Pinhole
1,000lm - 2,400lm
(15 - 22W)

**LRLD2673/
LRXLD2673**

2.5" Gen 2 P-Series
Round Flanged or Trimless
Wall Wash
1,000lm - 2,400lm
(15 - 22W)

**LRLDQ2621/
LRXLDQ2621**

2.5" Gen 2 P-Series
Square Flanged or Trimless
Downlight
1,000lm - 2,400lm
(15 - 22W)

**LRLDQ2621J/
LRXLDQ2621J**

2.5" Gen 2 P-Series
Square Flanged or Trimless
Adjustable Downlight
1,000lm - 2,400lm
(15 - 22W)

**LRLDQ2619/
LRXLDQ2619**

2.5" Gen 2 P-Series
Square Flanged or Trimless
Downlight Pinhole
1,000lm - 2,400lm
(15 - 22W)

**LRLDQ2619J/
LRXLDQ2619J**

2.5" Gen 2 P-Series
Square Flanged or Trimless
Adjustable Pinhole
1,000lm - 2,400lm
(15 - 22W)

**LRLDQ2673/
LRXLDQ2673**

2.5" Gen 2 P-Series
Square Flanged or Trimless
Wall Wash
1,000lm - 2,400lm
(15 - 22W)

Application

Although not required, the frame allows for support for the downlight in weak ceilings such as tiles and locations where a rough-in frame is desired for new construction applications.

Mounting

Housing suitable for new construction installations. Adjusts up to 3/4" ceiling thickness. Supplied with (2) 24" adjustable hanger bars. Hanger bars equipped with nail-less install 3/4" serrated barbed studs and with captive nails, for faster and easier secure mounting in wood joists. Set-screws lock into position and prevent shifting after installation. Trim is secured via positive retention friction clips.