

## 5" IC LED Standard Housing w/ 5" 16W LED Reflector

### 5" 14W/16W LED LIGHTING

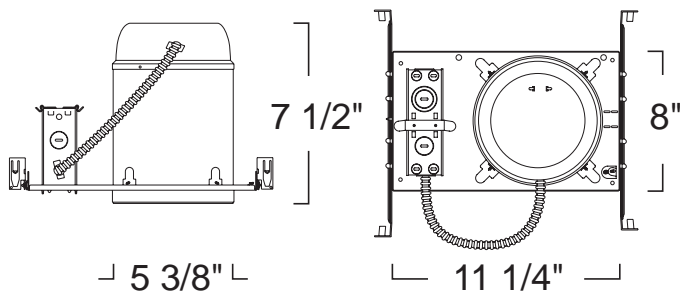

### SPECIFICATION

Ceiling cut-out: 5 3/4"

**Application:** This energy efficient General Purpose recessed LED housing is perfect for low to medium height ceilings in residential and light commercial applications. A variety of trim styles, finishes, beam spreads and wattages are available to achieve a desired look and lumen output.

**Housing:** Pre-wired housing adjusts up to a 1 1/4" ceiling thickness. Integral thermal protector to guard against improper lamping and installation. Trim is secured via positive retention friction clips.

**Mounting:** Housing suitable for new construction installations only, supplied with (2) 24" adjustable hanger bars with 90 degrees repositioning ability. Hanger bars equipped with nail-less install 3/4" serrated barbed studs and with captive nails, for faster and easier secure mounting in wood joists. Set-screws lock into position and prevent shifting after installation. Earthquake structural cable compatible for drop panel ceiling or any other mounting that requires direct support from structural ceilings.

**Driver:** Electronic Direct Current U.L. Listed driver mounted away from LED Array for cool operation and end-of-life modularity. Comes standard with 120VAC input and available with optional 120V/277V universal voltage input.

**Dimming:** 'DIN' dimming option smoothly dims down to 5% of initial light output with flicker-free performance. Works with standard incandescent dimmers. Factory qualified for use with Lutron brand dimmers: S600PR, DVSCCL-153P & DV600PR as well as Leviton IP106-600W. Works with standard electronic low voltage (ELV) dimmers. Factory qualified for use with Lutron brand dimmers: SELV300P, DVELV-300P, MAELV-600 and NELV-450.

**Power Connection:** LED heat sinked lamp module is replaceable via onboard quick exclusionary disconnect terminal. No tools required. Meets CA Title 24 Requirements and other standards restricting the use of Medium Base or Bi-Pin Sockets.

**Lumen Maintenance:** Minimum 35,000 hours L70 life based on ANSI TM-21 calculations from LM80 standardized test results.

**Thermal Management:** Effective thermal dissipation facilitated by integral cast-aluminum, finned heat sink design for maximum heat rejection to provide long LED life.

**Emergency Option:** Emergency LED Battery Back-up available, remotely mounted adjacent to housing by installer. When AC power fails, the device immediately switches to the emergency mode, operating the LEDs for a minimum of 90 minutes. Remote test switch, plate cover and junction box included. Optional Generator Transfer Device switches the driver to auxiliary generator power during the loss of normal AC power, (recommended for applications requiring individual circuit switching).

**Junction Box:** 16 gauge pre-wired galvanized steel Junction Box, 32 cubic-inch for a maximum of (8) #12 AWG wires. Furnished with (7) 3/4" and (4) Romex knock-outs. Strain clamps to install or remove covers for easy access and ground wire. Equipped with safety standard fitting for flex-conduit.



### FEATURE:



**Application:** This energy efficient LED trim is perfect for low to medium height ceilings in residential and light commercial applications. A variety of finishes, and beam spreads are available to achieve a desired look and lumen output.

**Power Connection:** LED heat sinked lamp module is replaceable via onboard quick exclusionary disconnect terminal. No tools required. Meets CA Title 24 Requirements and other standards restricting the use of Medium Base or Bi-Pin Sockets.

**Lumen Maintenance:** Minimum 35,000 hours L70 life based on ANSI TM-21 calculations from LM80 standardized test results.

**Thermal Management:** Effective thermal dissipation facilitated by integral cast-aluminum, finned heat sink design for maximum heat rejection to provide long LED life.

**Mounting:** Steel pressure springs mounted on trim to ensure positive retention inside housing.

**Color Temperature:** Comes standard with 3,000K Warm White LED's binned according to ANSI C78 377A for color temperature and chromaticity ranges. Available with other color temperatures with ANSI binning of 2,700K, 3,500K & 4,000K. To order use "-T" Suffix followed by color temperature. Example 4000K= T40. Consult factory as extended lead times apply.

**Warranty:** Covered by a 3 Year Warranty to be free of defects in materials and craftsmanship. Recommended for applications where ambient temperatures do not exceed 35°C, installations exceeding this temperature will result in reduced LED lamp life and a voided warranty.

**Certification:** This LED product is certified as compliant with California's Title 24 Energy Code by the California Energy Commission.

**Label:** cETL Listed

**Assembled in USA**

### 5" IC LED STANDARD HOUSING

#### LRLDH516C35 14W/16W LED

DRIVER TYPE	OPTIONS
LRLDH516C35 :120V Non-Dimming	Blank :None
LRLDH516C35-DIN :Incandescent Dimming	-EM :Emergency Back-Up (6W)
LRLDH516C35UE :120V/277V	
LRLDH516C35UE-D10 :120V-277V (0-10V Dimming)	
LRLDH516C35UE-DHL:(120V/277V) Hilume	

### 5" 16W LED REFLECTOR

#### LRLDH521 16W LED

REFLECTOR FINISH	RING FINISH	BEAM SPREAD
LRLDH521S :Satin Haze	Blank :White	-B25:Narrow Flood
	B :Black	-B45:Flood
	C :Chrome	-B61:Wide Flood
	CO :Copper	
	N :Natural	

Ordering example: LRLDH516C35-DIN/LRLDH521SB-B61