

Line Voltage Housing w/ Slot MINI-ARC PHANTOM TRIMLESS

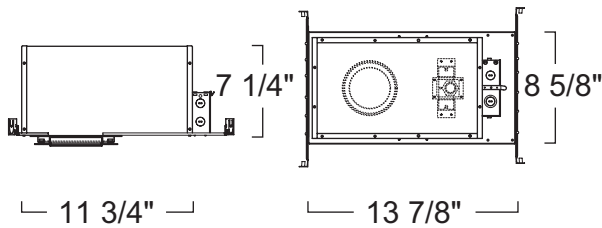

SPECIFICATION

Ceiling cut-out: 5 7/8"

Application: Architectural-grade recessed "Trimless" downlight for low to medium height ceilings for residential commercial installations. Trimless design provides a clean unobstructed "zero-sight" line ceiling. Die-Cast aluminum plaster frame disc installed on housing for easy installation. A variety of trims compatible styles and finishes are available to achieve the proper décor and illumination.

Housing: Pre-wired housing with Die-Cast adjustment plate with pre-set ceiling thickness for easy installation in 1/2", 5/8", 3/4" and 1 inch ceilings. Integral thermal protector to guard against improper lamping and installation. Housing provides an adjustable socket plate which allows for use of different lamp types. Trim is secured with QuickLok mounting mechanism for an easy scratch free installation.

Mounting: Housing suitable for new construction installations only, supplied with (2) 24" adjustable hanger bars with 90 degrees repositioning ability. Hanger bars equipped with nail-less install 3/4" serrated barbed studs and with captive nails, for faster and easier secure mounting in wood joists. Set-screws lock into position and prevent shifting after installation. Earthquake structural cable compatible for drop panel ceiling or any other mounting that requires direct support from structural ceilings.

Socket: Standard porcelain GU10 "Twist & Lock" socket with high temperature leads.

Junction Box: 16 gauge pre-wired galvanized steel Junction Box, 32 cubic-inch for a maximum of (8) #12 AWG wires. Furnished with 3/4", 1" and Romex knock-outs. Strain clamps to install or remove covers for easy access and ground wire. Equipped with safety standard fitting for flex-conduit.

Insulation Contact: Non-IC rated housing must be kept 3" from insulation.

Safety Labels: ETL/CETL listed. Suitable for damp locations. NYC approved: Calendar #41937.

Label: cETL Listed

Assembled in USA

FEATURE:



Applications: Mini-Arc 'Trimless' trims provide a flat, unobstructed 'zero-sight line' view of the ceiling. Trims easily install into a die-cast aluminum adjustment plate that mounts onto the housing. This miniature Slot trim is perfect for commercial and high-end residential applications. Its narrow slot aperture and high degree of adjustability makes it ideal for strategic placement where precise beam spread control is required. Ideal for accent lighting such as seating areas in conference room settings.

Accessories: Takes (1) 2" Media.

Label: UL Listed, cETL Listed

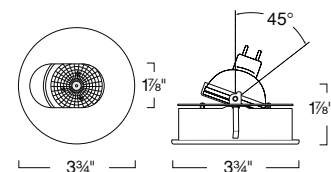

LINE VOLTAGE HOUSING LHX4IN

LIGHT SOURCE

LHX4IN50 :120V 50W GU10 MR16

LHX4IN50-27 :120V 50W GU10MR16 (277V)

SLOT LRX420

12V/120V 50W MR16

FINISH

LRX420W :White

Ordering example: LHX4IN50/LRX420W