

2.5" RECESSED LED

ROUND FLANGED, 1000LM TO 1400LM

- 1000lm (15W) and 1400lm (22W) lumen packages
- Equivalent to 75W MR16 Output
- Ideal where space is limited and energy savings is important

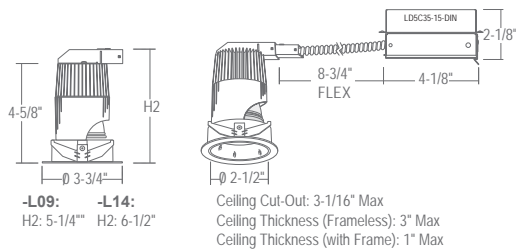

LRLD2521
Downlight



LRLD2521J
25° Adj. Accent



LRLD2571
40° Adj. Accent

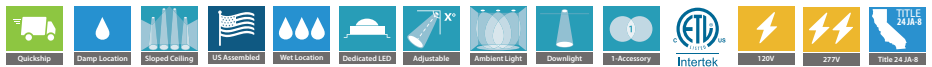

ORDERING – Example: LRLD2521SW-L09-B25-T27UE-DUN-WL

Fixture	Reflector Finish	Trim Ring Finish	Beam Spread	Lumens	Color Temperature	Driver	Rating	Accessories	Optional Frame
Fixture				Lumens (Nominal Delivered)		Driver		Accessories	
Downlight	LRLD2521			1000lm	-L09	120V, Triac Dimming	Blank⁵	COLOR LENS	
25° Adj. Accent	LRLD2521J			1400lm	-L14⁷	0-10V Dimming	UE-D10	Clear Lens	L38
40° Adj. Accent	LRLD2571			Beam Spread		120V/277V, UniDim™	UE-DUN	Yellow Lens	L40
Reflector Finish				10° Narrow Spot	-B10²	0-10V, ELV, Triac Dimming (5%)		Blue Lens	L41
Matte White	W			25° Narrow Flood	-B25	Lutron EcoSystem Dimming (1%)	-DEC*	Amber Lens	L42
Specular Clear	C			35° Flood	-B35			Green Lens	L43
Specular Black	B			60° Wide Flood	-B60⁸			Daylight Blue Lens	L44
Satin Haze	S			Color Temperature				Red Lens	L39
Specular Graphite	RP			3000K (90 CRI)	Blank			Violet Blue Lens	L46
Matte Gold	MG			3000K (97 CRI)	-C97	Rating		FILTER LENS	
Trim Ring Finish				1700K (90 CRI)	-T17³	None	Blank	Black Hex Cell Louver	LL16-HB-B
White	W			2500K (90 CRI)	-T25³	Airtight Lensed (Wet Location)	-WL⁶	Frosted Soft Focus	L49
Black	B			2700K (90 CRI)	-T27	4" J-box (Chicago Plenum)	-JB-CHP	Micro - Prismatic Spread Lens	L53
				2700K (97 CRI)	-T27-C97			Linear Spread Lens	L55
				3500K (90 CRI)	-T35			Ultra Violet Filter	L50UV
				4000K (90 CRI)	-T40			Micro - Prismatic Spread Lens (Light Diffuse)	L54
				3000K - 1800K Warm Dimming	-TWD^{4,7}				

² Not field changeable.

³ Extended lead time may apply. Consult factory.

⁴ Warm Dimming (-TWD) only available for 1000lm (-L09) lumen package.

⁵ 0.5% dimming for 1000lm (-L09), 5% dimming for 1400lm (-L14).

⁶ Airtight Lensed (Wet Location) (-WL) not available for LRLD2571.

⁷ (-TWD) Warming Dimming and (-L14) 1400lm options are not available for both LHLD25IC-FRM (IC) and LHFRD25 (Fire-Rated) frame.

⁸ Achieved through a filter at aperture level.

* Special order, minimum order. Lead times apply. Consult factory for emergency battery options.

NOTE: For commercial applications with 1/2" Pipe or Flex-Conduit (**LITON# PCT031**) Fitting Adaptor should be used. Consult Factory.

OPTIONAL FRAMES & ACCESSORIES

LHLD25-FRM

New Construction Frame (Round)

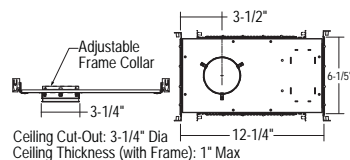

LHLD25IC-FRM

New Construction IC (Insulation Contact) Frame (Round)

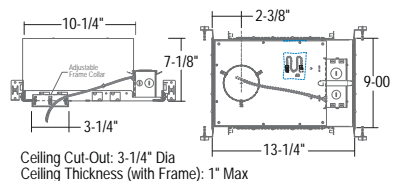

LHFRD25

2.5" Fire-Rated Frame (Round)

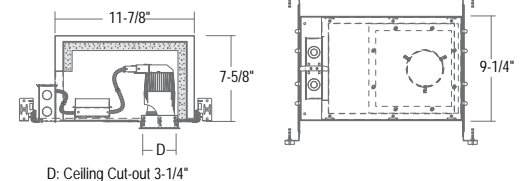

SPECIFICATION

Applications

Perfect for ambient and task downlighting in low to medium height ceilings and high-end residential and commercial applications.

LRLD2521 - Standard Downlight.

LRLD2521J - Adjustable accent tilts up to 25°, rotates up to 357°, and hot aiming to accent architectural features.

LRLD2571 - Adjustable accent tilts up to 40°, rotates up to 357°, and hot aiming to accent architectural features.

LRLD2572 - Features a symmetrical lens that bends light to wash the wall.

Housing

Suitable for remodel or new construction installations. Designed to secure to existing sheet rock or panel ceilings up to 3" thick. For added support in weak ceilings, LHLD25 Frames can be used.

Lens

Airtight lens available for wet locations. Specify "WL" when ordering.

Junction Box

(L09 - 120V Triac Option) - 24 gauge pre-wired galvanized steel Junction Box. 7 cubic-inch for a maximum of (4) #12 AWG wires. (2) 1/4" Romex knock-outs. Remove covers for easy access and ground wire. For 1/2" Pipe or Flex-Conduit (LITON# PCT031) Fitting Adaptor should be used. Consult Factory.

Alternate Junction Box: 18 gauge pre-wired aluminum Junction Box. 7 cubic-inch for a maximum of (4) #12 AWG wires. (2) 1/2" knock-outs. Remove covers for easy access and ground wire.

Trim Ring

Friction clips hold Round trim and LED Light Engine secure to sheet rock ceiling or Housing Frame.

Reflector

Multifaceted Specular Reflector locks into place on LED Light Engine.

Optics

LED Light Engine - COB (Chip on Board) LED is replaceable via quick disconnect terminal. Meets CA Title 24 Requirements and other standards restricting the use of Medium Base or Bi-Pin Sockets.

Color Temperature - Comes standard with 3000K (90 CRI) Warm White LEDs binned to 3-step MacAdam ellipses within the ANSI C78 377A standard for color temperature

and chromaticity ranges light binning allowance. Also available in 1700K, 2500K, 2700K, 3500K, 4000K, (90 CRI), and 2700K, 3000K, (97 CRI). Also available with 3000K-1800K Warm Dimming.

Beam Spread - Available in 10° (-B10), 25° (-B25), 35° (-B35), and 60° (-B60).

Lumen Maintenance - Minimum 50,000 hours L70 life based on ANSI TM-21 calculations from LM80 standardized test results.

Thermal Management

Effective thermal dissipation facilitated by integral cast-aluminum, heat sink design for maximum heat rejection to provide long LED life.

Electrical Components

Dimming - Standard driver is 120V, triac dimming to 0.5% for 1000lm (-L09), 5% dimming for 1400lm (-L14). Optional 0-10V (UE-D10) dimming works with most 5-wire, 0-10V dimmers. Optional UniDim™ (UE-DUN) for 120V/277V 0-10V, ELV triac dimming (5%). Lutron EcoSystem dimming (1%) is also available, special order, minimum, order, lead times apply.

Finishes

For LRLD2521, LRLD2521J, LRLD2571, LRLD2572; reflector available in W-Matte White, B - Specular Black, C - Specular Clear, RP - Specular Graphite, S - Satin Haze and MG - Matte Gold. Trim ring available in W - White and B - Black.

Certifications and Listings

ETL/cETL listed to UL1598 and UL8750. Suitable for damp and wet locations. NYC approved: Calendar #41937. CCEA (City of Chicago Environmental Air) Certified: Conforms to CCEA-200 with Section 18-27-300.22 and special requirements Section 14-20-210C-4.

Caution

Fixtures must be grounded in accordance with national, state and/or local electrical codes. Failure to do so may result in serious personal injury.

Warranty

Covered by a 5 Year Warranty to be free of defects in materials and craftsmanship. Recommended for applications where ambient temperatures do not exceed 35°C. Installations exceeding this temperature will result in reduced LED lamp life and a voided warranty.

Optional Frames & Accessories

LHLD25-FRM - New Construction Frame (Round). Suitable for new construction and remodel installations. Adjusts up to 1" ceiling thickness. Supplied with (2) 24" adjustable hanger bars with nail-less install 3/4" serrated barbed studs for mounting in wood joists.

LHLD25IC-FRM - New Construction IC Frame (Round). Rated for direct contact with low to medium density loosefill blown and rolled insulation. Adjusts up to 1" ceiling thickness. Supplied with (2) 24" adjustable hanger bars with nail-less install 3/4" serrated barbed studs for mounting in wood joists.

LHFRLD25 - 2.5" Fire-Rated Frame (Round). Patented 3-stage fire-resistant technology is IC Rated and airtight with a one-hour fire rating. New construction frame eliminates manually constructed drywall enclosures saving labor, materials and time.

Title 24/JA8 Compliant

LRLD2521_-L09-B_-T27
LRLD2521_-L09-B_-
LRLD2521_-L09-B_-T35
LRLD2521_-L09-B_-T40

LRLD2521J_-L09-B_-T27
LRLD2521J_-L09-B_-
LRLD2521J_-L09-B_-T35
LRLD2521J_-L09-B_-T40

LRLD2571_-L09-B_-T27
LRLD2571_-L09-B_-
LRLD2571_-L09-B_-T35
LRLD2571_-L09-B_-T40

LRLD2521_-L14-B_-T27UE-DUN
LRLD2521_-L14-B_-UE-DUN
LRLD2521_-L14-B_-T35UE-DUN
LRLD2521_-L14-B_-T40UE-DUN

LRLD2521J_-L14-B_-T27UE-DUN
LRLD2521J_-L14-B_-UE-DUN
LRLD2521J_-L14-B_-T35UE-DUN
LRLD2521J_-L14-B_-T40UE-DUN

LRLD2571_-L14-B_-T27UE-DUN
LRLD2571_-L14-B_-UE-DUN
LRLD2571_-L14-B_-T35UE-DUN
LRLD2571_-L14-B_-T40UE-DUN

2.5" RECESSED LED

ROUND FLANGELESS, 1000LM/1400LM

- Equivalent to 75W MR16 Output
- Ideal where space is limited and energy savings is important
- 15W, 1000+lm at 67lm/W, and 22W, 1400+lm at 64lm/W

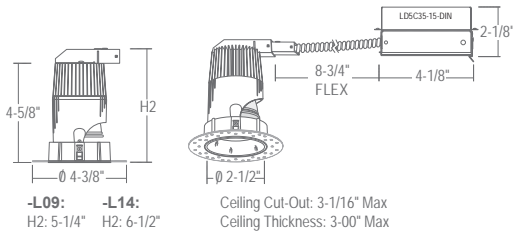

LRXLD2521
Downlight



LRXLD2521J
25° Adj. Accent



LRXLD2571
40° Adj. Accent



ORDERING – Example: LRXLD2521S-L09-B25-T27UE-DUN-WL

Trim Style	Reflector Finish	Beam Spread	Lumens	Color Temperature	Driver	Rating	Accessories	Optional Frame
Trim Style		Beam Spread			Driver		Accessories	
Downlight	LRXLD2521	10° Narrow Spot	B10²		120V, Triac Dimming	Blank⁵	COLOR LENS	
25° Adj. Accent	LRXLD2521J	25° Narrow Flood	B25		0-10V Dimming	UE-D10	Clear Lens	L38
40° Adj. Accent	LRXLD2571	35° Flood	B35		120V/277V, UniDim™	UE-DUN	Yellow Lens	L40
		60° Wide Flood	B60⁸		0-10V, ELV, Triac Dimming (5%) ::"		Blue Lens	L41
Reflector Finish		Color Temperature			Lutron EcoSystem Dimming (1%)	-DEC*	Amber Lens	L42
Matte White	W	3000K (90 CRI)	Blank		Rating		Green Lens	L43
Specular Clear	C	3000K (97 CRI)	-C97		None	Blank	Daylight Blue Lens	L44
Specular Black	B	1700K (90 CRI)	-T17³		Airtight Lensed (Wet Location)	-WL⁶	Red Lens	L39
Satin Haze	S	2500K (90 CRI)	-T25³		4" Jbox (Chicago Plenum)	-JB-CHP	Violet Blue Lens	L46
Specular Graphite	RP	2700K (90 CRI)	-T27				FILTER LENS	
Matte Gold	MG	2700K (97 CRI)	-T27-C97				Black Hex Cell Louver	LL16-HB-B
Lumens (Nominal Delivered)		3500K (90 CRI)	T35				Frosted Soft Focus	L49
1000lm	-L09	4000K (90 CRI)	-T40				Micro - Prismatic Spread Lens	L53
1400lm	-L14⁷	3000K - 1800K Warm Dimming	-TWD^{4,7}				Linear Spread Lens	L55

² Not field changeable.

³ Extended lead time may apply. Consult factory.

⁴ Warm Dimming (-TWD) only available for 1000lm (-L09) lumen package.

⁵ 0.5% dimming for 1000lm (-L09), 5% dimming for 1400lm (-L14).

⁶ Airtight Lensed (Wet Location) (-WL) not available for LRXLD2571.

⁷ (-TWD) Warming Dimming and (-L14) 1400lm options are not available for both LHLD25IC-FRM (IC) and LHFRD25 (Fire-Rated) frame.

⁸ Achieved through a filter at aperture level.

* Special order, minimum order. Lead times apply. Consult factory for emergency battery options.

NOTE: For commercial applications with 1/2" Pipe or Flex-Conduit (**LITON# PCT031**) Fitting Adaptor should be used. Consult Factory.

OPTIONAL FRAMES & ACCESSORIES

LHLD25-FRM

New Construction Frame (Round)

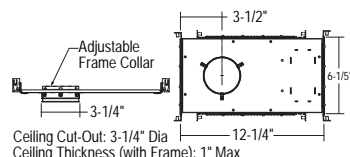

LHLD25IC-FRM

New Construction IC (Insulation Contact) Frame (Round)

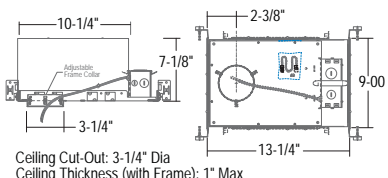

LHFRD25

2.5" Fire-Rated Frame (Round)

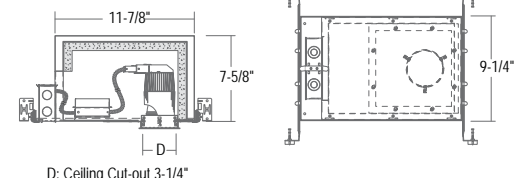

SPECIFICATION

Applications

Perfect for ambient and task downlighting in low to medium height ceilings and high-end residential and commercial applications where clean unobtrusive ceilings are desired.

LRXLD2521 - Standard Downlight.

LRXLD2521J - Adjustable accent tilts up to 25°, rotates up to 357°, and hot aiming to accent architectural features.

LRXLD2571 - Adjustable accent with 40° tilt, rotation up to 357° and hot aiming to accent architectural features.

Housing

Suitable for remodel or new construction installations. Designed to secure to existing sheet rock or panel ceilings up to 3" thick. For added support in weak ceilings, LHLD25 Frames can be used.

Lens

Airtight lens available for wet locations. Specify "WL" when ordering.

Junction Box

(L09 - 120V Triac Option) - 24 gauge pre-wired galvanized steel Junction Box. 7 cubic-inch for a maximum of (4) #12 AWG wires. (2) 1/4" Romex knock-outs. Remove covers for easy access and ground wire. For 1/2" Pipe or Flex-Conduit (LITON# PCT031) Fitting Adaptor should be used. Consult Factory.

Alternate Junction Box: 18 gauge pre-wired aluminum Junction Box. 7 cubic-inch for a maximum of (4) #12 AWG wires. (2) 1/2" knock-outs. Remove covers for easy access and ground wire.

Trim Ring

Reflector and die-cast aluminum trim secure to sheet rock ceiling or Housing Frame with drywall screws secured to trim ring.

Reflector

Multifaceted Specular Reflector locks into place on LED Light Engine.

Optics

LED Light Engine - COB (Chip on Board) LED is replaceable via quick disconnect terminal. Meets CA Title 24 Requirements and other standards restricting the use of Medium Base or Bi-Pin Sockets.

Color Temperature - Comes standard with 3000K (90 CRI) Warm White LEDs binned to 3-step MacAdam ellipses within the ANSI C78 377A standard for color temperature

and chromaticity ranges light binning allowance. Also available in 1700K, 2500K, 2700K, 3500K, 4000K, (90 CRI), and 2700K, 3000K, (97 CRI). Also available with 3000K-1800K Warm Dimming.

Beam Spread - Available in 10° (-B10), 25° (-B25), 35° (-B35), and 60° (-B60).

Lumen Maintenance - Minimum 50,000 hours L70 life based on ANSI TM-21 calculations from LM80 standardized test results.

Thermal Management

Effective thermal dissipation facilitated by integral cast-aluminum, heat sink design for maximum heat rejection to provide long LED life.

Electrical Components

Dimming - Standard driver is 120V, triac dimming to 0.5% for 1000lm (-L09), 5% dimming for 1400lm (-L14). Optional 0-10V (UE-D10) dimming works with most 5-wire, 0-10V dimmers. Optional UniDim™ (UE-DUN) for 120V/277V 0-10V, ELV triac dimming (5%). Lutron EcoSystem dimming (1%) is also available, special order, minimum, order, lead times apply.

Finishes

Reflector available in W-Matte White, B - Specular Black, C - Specular Clear, RP - Specular Graphite, S - Satin Haze and MG - Matte Gold.

Certifications and Listings

ETL/cETL listed to UL1598 and UL8750. Suitable for damp and wet locations. NYC approved: Calendar #41937.CCEA (City of Chicago Environmental Air) Certified: Conforms to CCEA-200 with Section 18-27-300.22 and special requirements Section 14-20-210C-4.

Caution

Fixtures must be grounded in accordance with national, state and/or local electrical codes. Failure to do so may result in serious personal injury.

Warranty

Covered by a 5 Year Warranty to be free of defects in materials and craftsmanship. Recommended for applications where ambient temperatures do not exceed 35°C. Installations exceeding this temperature will result in reduced LED lamp life and a voided warranty.

Optional Frames & Accessories

LHLD25-FRM - New Construction Frame (Round). Suitable for new construction and remodel installations. Adjusts up to 1" ceiling thickness. Supplied with (2) 24" adjustable hanger bars with nail-less install 3/4" serrated barbed studs for mounting in wood joists.

LHLD25IC-FRM - New Construction IC Frame (Round). Rated for direct contact with low to medium density loosefill blown and rolled insulation. Adjusts up to 1" ceiling thickness. Supplied with (2) 24" adjustable hanger bars with nail-less install 3/4" serrated barbed studs for mounting in wood joists.

LHFRLD25 - 2.5" Fire-Rated Frame (Round). Patented 3-stage fire-resistant technology is IC Rated and airtight with a one-hour fire rating. New construction frame eliminates manually constructed drywall enclosures saving labor, materials and time.

Title 24/JA8 Compliant

LRXLD2521_-L09-B_-T27
LRXLD2521_-L09-B_-
LRXLD2521_-L09-B_-T35
LRXLD2521_-L09-B_-T40

LRXLD2521J_-L09-B_-T27
LRXLD2521J_-L09-B_-
LRXLD2521J_-L09-B_-T35
LRXLD2521J_-L09-B_-T40

LRXLD2571_-L09-B_-T27
LRXLD2571_-L09-B_-
LRXLD2571_-L09-B_-T35
LRXLD2571_-L09-B_-T40

LRXLD2521_-L14-B_-T27UE-DUN
LRXLD2521_-L14-B_-UE-DUN
LRXLD2521_-L14-B_-T35UE-DUN
LRXLD2521_-L14-B_-T40UE-DUN

LRXLD2521J_-L14-B_-T27UE-DUN
LRXLD2521J_-L14-B_-UE-DUN
LRXLD2521J_-L14-B_-T35UE-DUN
LRXLD2521J_-L14-B_-T40UE-DUN

LRXLD2571_-L14-B_-T27UE-DUN
LRXLD2571_-L14-B_-UE-DUN
LRXLD2571_-L14-B_-T35UE-DUN
LRXLD2571_-L14-B_-T40UE-DUN