

6" Shallow Housing (10W/15W) w/ 6" Regressed Deco LED Cone 6" (10W/15W) (6 LED SERIES)

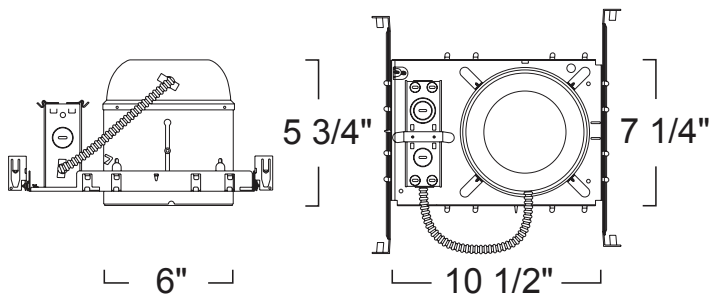

SPECIFICATION

Ceiling cut-out: 6 1/2"

Application: This energy efficient General Purpose recessed LED housing is perfect for low to high height ceilings in residential and light commercial applications where shallow plenums or fixture height restrictions exist. A variety of trim styles, finishes, beam spreads and wattages are available to achieve a desired look and lumen output.

Housing: Pre-wired housing adjusts up to a 1 1/4" ceiling thickness. Integral thermal protector to guard against improper lamping and installation. Housing provides an adjustable socket plate which allows for use of different lamp types. Trim is secured with torsion wing springs.

Mounting: Housing suitable for new construction installations only, supplied with (2) 24" adjustable hanger bars with 90 degrees repositioning ability. Hanger bars equipped with nail-less install 3/4" serrated barbed studs and with captive nails, for faster and easier secure mounting in wood joists. Set-screws lock into position and prevent shifting after installation. Earthquake structural cable compatible for drop panel ceiling or any other mounting that requires direct support from structural ceilings.

Power Connection: LED heat sinked lamp module is replaceable via onboard quick exclusionary disconnect terminal. No tools required. Meets CA Title 24 Requirements and other standards restricting the use of Medium Base or Bi-Pin Sockets.

Driver: Electronic Direct Current LED driver integrally mounted in electric junction box.

Emergency Option: Emergency LED Battery Back-up available, remotely mounted adjacent to housing by installer. When AC power fails, the device immediately switches to the emergency mode, operating the LEDs for a minimum of 90 minutes. Remote test switch, plate cover and junction box included. Optional Generator Transfer Device switches the driver to auxiliary generator power during the loss of normal AC power, (recommended for applications requiring individual circuit switching).

Junction Box : 16 gauge pre-wired galvanized steel Junction Box, 32 cubic-inch for a maximum of (8) #12 AWG wires. Furnished with (7) 3/4" and (4) Romex knock-outs. Strain clamps to install or remove covers for easy access and ground wire. Equipped with safety standard fitting for flex-conduit.

Insulation Contact: Energy Efficient LED housing comes standard with IC rating for direct contact with loosefill blown and rolled insulation.

Safety Labels: ETL/CETL listed. Suitable for damp locations. NYC approved: Calendar #41937.

Caution: LITON recommends use of surge protectors on the power entering LED Housings. Surge damage is not covered by warranty.

Ceiling Type: Suitable for flat and sloped ceilings.

Label: cETL Listed

Assembled in USA

6" SHALLOW HOUSING (10W/15W)

LSHLD6 15W Max LED

WATTAGE	DRIVER TYPE	OPTIONS
LSHLD610C50 :10W	Blank :120V	Blank :None
LSHLD615C70 :15W	-DLV :ELV Dimming UE :120V/277V*	-EM :Emergency Back-Up (6W) -EM2 :Emergency Back-Up (10W)
	UE-D10 :(120V/277V) 0-10V Dimming*	
	UE-DUN :UniDim™ (120V/277V)	

* Not available for 10W option

FEATURE:



Application: This energy efficient LED trim is perfect for low to high height ceilings in residential and light commercial applications. Decorative glass trims add warmth and dimension to lighting designs. Each finish and glass color combination creates a unique atmosphere.

Mounting: Steel pressure springs mounted on trim to ensure positive retention inside housing.

Power Connection: LED heat sinked lamp module is replaceable via onboard quick exclusionary disconnect terminal. No tools required. Meets CA Title 24 Requirements and other standards restricting the use of Medium Base or Bi-Pin Sockets.

Lumen Maintenance: Minimum 35,000 hours L70 life based on ANSI TM-21 calculations from LM80 standardized test results.

Thermal Management: Effective thermal dissipation facilitated by integral cast-aluminum, finned heat sink design for maximum heat rejection to provide long LED life.

Color Temperature: Comes standard with 3,000K Warm White LED's binned according to ANSI C78 377A for color temperature and chromaticity ranges. Available with other color temperatures with ANSI binning of 2,700K, 3,500K & 4,000K. To order use "-T" Suffix followed by color temperature. Example 4000K= T40. Consult factory as extended lead times and minimum order quantities apply.

Warranty: Covered by a 3 Year Warranty to be free of defects in materials and craftsmanship. Recommended for applications where ambient temperatures do not exceed 35°C, installations exceeding this temperature will result in reduced LED lamp life and a voided warranty.

Label: cETL Listed

Assembled in USA

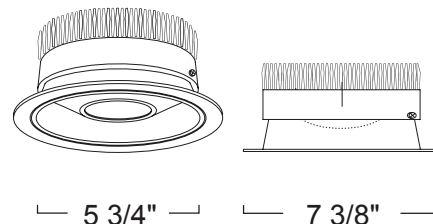

6" REGRESSED DECO LED CONE

LRLD649 10W/15W LED

Ordering example: LSHLD610C50-DLV-EM2/LRLD649W-BL

FINISH	GLASS COLOR	COLOR TEMP
LRLD649BB :All Black	-AM :Amber	Blank :3000K
LRLD649SN :Satin Reflector/ Natural Ring	-BL :Blue	
LRLD649W :All White	-FR :Frosted	