

## 6" Shallow Housing (10W/15W) w/ 6" Open Heat Sink LED Gimbal 6" (10W/15W) (6 LED SERIES)

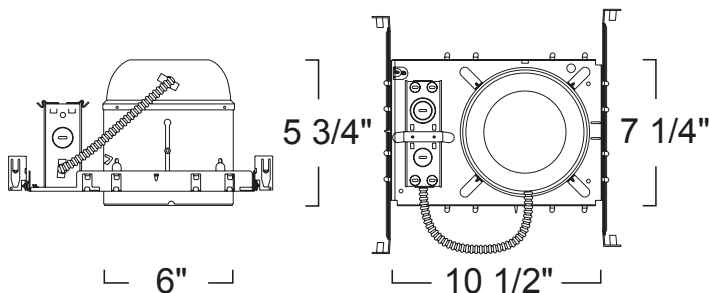

### SPECIFICATION

Ceiling cut-out: 6 1/2"

**Application:** This energy efficient General Purpose recessed LED housing is perfect for low to high height ceilings in residential and light commercial applications where shallow plenums or fixture height restrictions exist. A variety of trim styles, finishes, beam spreads and wattages are available to achieve a desired look and lumen output.

**Housing:** Pre-wired housing adjusts up to a 1 1/4" ceiling thickness. Integral thermal protector to guard against improper lamping and installation. Housing provides an adjustable socket plate which allows for use of different lamp types. Trim is secured with torsion wing springs.

**Mounting:** Housing suitable for new construction installations only, supplied with (2) 24" adjustable hanger bars with 90 degrees repositioning ability. Hanger bars equipped with nail-less install 3/4" serrated barbed studs and with captive nails, for faster and easier secure mounting in wood joists. Set-screws lock into position and prevent shifting after installation. Earthquake structural cable compatible for drop panel ceiling or any other mounting that requires direct support from structural ceilings.

**Power Connection:** LED heat sinked lamp module is replaceable via onboard quick exclusionary disconnect terminal. No tools required. Meets CA Title 24 Requirements and other standards restricting the use of Medium Base or Bi-Pin Sockets.

**Driver:** Electronic Direct Current LED driver integrally mounted in electric junction box.

**Emergency Option:** Emergency LED Battery Back-up available, remotely mounted adjacent to housing by installer. When AC power fails, the device immediately switches to the emergency mode, operating the LEDs for a minimum of 90 minutes. Remote test switch, plate cover and junction box included. Optional Generator Transfer Device switches the driver to auxiliary generator power during the loss of normal AC power, (recommended for applications requiring individual circuit switching).

**Junction Box :** 16 gauge pre-wired galvanized steel Junction Box, 32 cubic-inch for a maximum of (8) #12 AWG wires. Furnished with (7) 3/4" and (4) Romex knock-outs. Strain clamps to install or remove covers for easy access and ground wire. Equipped with safety standard fitting for flex-conduit.

**Insulation Contact:** Energy Efficient LED housing comes standard with IC rating for direct contact with loosefill blown and rolled insulation.

**Safety Labels:** ETL/CETL listed. Suitable for damp locations. NYC approved: Calendar #41937.

**Caution:** LITON recommends use of surge protectors on the power entering LED Housings. Surge damage is not covered by warranty.

**Ceiling Type:** Suitable for flat and sloped ceilings.

**Label:** cETL Listed

**Assembled in USA**

### 6" SHALLOW HOUSING (10W/15W)

**LSHLD6** 15W Max LED

WATTAGE	DRIVER TYPE	OPTIONS
LSHLD610C50 :10W	Blank :120V	Blank :None
LSHLD615C70 :15W	-DLV :ELV Dimming UE :120V/277V*	-EM :Emergency Back-Up (6W) -EM2 :Emergency Back-Up (10W)
	UE-D10 :(120V/277V) 0-10V Dimming*	
	UE-DUN :UniDim™ (120V/277V)	

\* Not available for 10W option

### 6" OPEN HEAT SINK LED GIMBAL

**LRLD677** 10W/15W LED

Ordering example: LSHLD610C50-DLV-EM2/LRLD677BMO-B120

REFLECTOR FINISH	RING FINISH	BEAM SPREAD	COLOR TEMP
LRLD677W :White	Blank :White	-B61 :Wide Flood	Blank :3000K
LRLD677B :Black	B :Black	-B120 :Super Wide Flood (SOL Lens)	
LRLD677N :All Natural	N :Natural	-B25 :Narrow Flood	
	MO :Mocha	-B45 :Flood	

### FEATURE:



**Application:** This adjustable LED trim is perfect for low to high height ceilings in residential and light commercial applications. This LED trim provides directional adjustability not commonly found in LED fixtures, allowing it to function as both a downlight and an accent light. A variety of finishes and beam spreads are available to achieve a desired look and lumen output.

**Mounting:** Steel pressure springs mounted on trim to ensure positive retention inside housing.

**Power Connection:** LED heat sinked lamp module is replaceable via onboard quick exclusionary disconnect terminal. No tools required. Meets CA Title 24 Requirements and other standards restricting the use of Medium Base or Bi-Pin Sockets.

**Lumen Maintenance:** Minimum 35,000 hours L70 life based on ANSI TM-21 calculations from LM80 standardized test results.

**Thermal Management:** Effective thermal dissipation facilitated by integral cast-aluminum, finned heat sink design for maximum heat rejection to provide long LED life.

**Color Temperature:** Comes standard with 3,000K Warm White LED's binned according to ANSI C78 377A for color temperature and chromaticity ranges. Available with other color temperatures with ANSI binning of 2,700K, 3,500K & 4,000K. To order use "-T" Suffix followed by color temperature. Example 4000K= T40. Consult factory as extended lead times and minimum order quantities apply.

**Warranty:** Covered by a 3 Year Warranty to be free of defects in materials and craftsmanship. Recommended for applications where ambient temperatures do not exceed 35°C, installations exceeding this temperature will result in reduced LED lamp life and a voided warranty.

**Certification:** This LED product is certified as compliant with California's Title 24 Energy Code by the California Energy Commission.

**Ceiling Type:** Suitable for flat and sloped ceilings.

**Adjustability** Lamp can be tilted 35° degrees vertically and rotated 90° degrees horizontally.

**Label:** cETL Listed

**Assembled in USA**

2019.11.15

File Located online www.litron.com/spec

ID#: 2150\_2106

Lamp: (6)LED w/40° Optics Lens  
 Total Rated Fixture Lumen :490.85  
 Total Luminaire Efficacy :44.10 Lm/W  
 Luminous Diameter :2.76"  
 Input Power (W) :11.13  
 Input Current (Amp) :0.10  
 Color Rendering Index (CRI) :83.77  
 Color Temperature :2,933K

6" LED Downlight  
 Luminaire  
 IESNA Standard  
 LM-79-2008  
 Test # LO9111703  
 By:  
 Light Laboratory, Inc.  
 10W LRLD6

Lamp: (6)LED w/60° Optics Lens  
 Total Rated Fixture Lumen :493.28  
 Total Luminaire Efficacy :41.70 Lm/W  
 Luminous Diameter :2.76"  
 Input Power (W) :11.83  
 Input Current (Amp) :0.11  
 Color Rendering Index (CRI) :85.35  
 Color Temperature :2,820K

6" LED Downlight  
 Luminaire  
 IESNA Standard  
 LM-79-2008  
 Test # LO9111704  
 By:  
 Light Laboratory, Inc.  
 10W LRLD6

## ZONAL LUMEN SUMMARY

Zone	Lumens Beam Spread	
	40°	60°
0 - 10	174.15	90.10
10 - 20	182.76	201.40
20 - 30	48.04	107.24
30 - 40	19.42	36.12
40 - 50	17.32	18.90
50 - 60	12.18	10.90
60 - 70	15.18	12.33
70 - 80	12.35	9.26
80 - 90	9.46	7.03

Zone	Beam Spread: 40°		Beam Spread: 60°	
	Lumens	% Fixt	Lumens	% Fixt
0 - 30	404.95	82.50	398.74	80.80
0 - 40	424.37	86.50	434.86	88.20
0 - 60	453.86	92.50	464.66	94.20
0 - 90	490.85	100.00	493.28	100.00

## HORIZONTAL FOOT CANDLES: FC VALUES

Distance	Beam Spread		Beam Spread		Beam Spread	
	FC 25°	∅	FC 40°	∅	FC 60°	∅
3.0'	305.9	1.3'	154.0	2.2'	144.0	3.3'
6.0'	76.3	2.7'	58.0	4.4'	36.0	6.6'
9.0'	34.3	4.0'	29.0	6.6'	16.0	9.9'
12.0'	18.9	5.3'	11.0	8.7'	9.0	13.2'
19.0'	10.0	6.5'				

## CANDELA TABULATION

Zone	Luminance (CD) Beam Spread	
	40°	60°
0.0	3370	1293
1.0	3301	1286
3.0	2974	1253
5.0	2501	1204
7.0	1992	1139
9.0	1518	1056
11.0	1115	946
13.0	790	821
15.0	546	698
17.0	373	581
19.5	232	445
22.5	134	307
25.5	83	204
29.0	53	123
33.0	37	67
37.5	28	36
42.5	23	24
47.5	20	19
55.0	18	15
65.0	14	11
75.0	10	7
85.0	5	4
90.0	0	0

## LUMINANCE DATA (CD./SQ.M.)

Angle	Beam Spread: 40°		
	Avg. 0-Deg	Avg. 45-Deg	Avg. 90-Deg
45	7870	7870	7870
55	8123	8123	8123
65	8574	8574	8574
75	10000	10000	10000
85	14849	14849	14849

Angle	Beam Spread: 60°		
	Avg. 0-Deg	Avg. 45-Deg	Avg. 90-Deg
45	7870	7870	7870
55	6769	6769	6769
65	6737	6737	6737
75	7000	7000	7000
85	11879	11879	11879

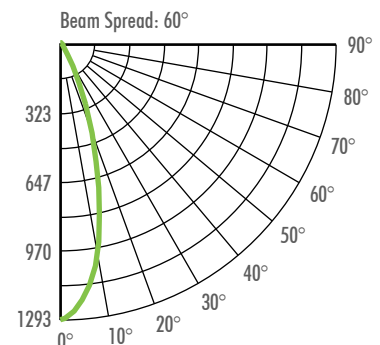
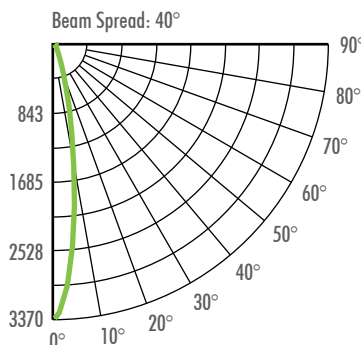

Lamp: (6)LED w/40° Optics Lens	6" LED Downlight Luminaire
Total Rated Fixture Lumen :614.52	IESNA Standard LM-79-2008
Total Luminaire Efficacy :36.06 Lm/W	Test # L09111701
Luminous Diameter :2.76"	By: Light Laboratory, Inc.
Input Power (W) :17.04	15W LRLD6
Input Current (Amp) :0.15	
Color Rendering Index (CRI) :85.20	
Color Temperature :2,870K	

Lamp: (6)LED w/60° Optics Lens	6" LED Downlight Luminaire
Total Rated Fixture Lumen :634.80	IESNA Standard LM-79-2008
Total Luminaire Efficacy :36.38 Lm/W	Test # L09111702
Luminous Diameter :2.76"	By: Light Laboratory, Inc.
Input Power (W) :17.34	15W LRLD6
Input Current (Amp) :0.15	
Color Rendering Index (CRI) :85.13	
Color Temperature :2,854K	

## ZONAL LUMEN SUMMARY

Zone	Lumens Beam Spread	
	40°	60°
0 - 10	218.91	115.61
10 - 20	224.39	260.89
20 - 30	61.56	137.08
30 - 40	25.80	45.24
40 - 50	22.66	23.11
50 - 60	15.38	13.14
60 - 70	18.50	14.70
70 - 80	15.44	11.32
80 - 90	11.89	9.73

Zone	Beam Spread: 40°		Beam Spread: 60°	
	Lumens	% Fixt	Lumens	% Fixt
0 - 30	504.86	82.20	513.58	81.40
0 - 40	530.66	86.40	558.83	88.60
0 - 60	568.70	92.50	595.08	94.30
0 - 90	614.52	100.00	630.84	100.00

## HORIZONTAL FOOT CANDLES: FC VALUES

Distance	Beam Spread FC 25°		Beam Spread FC 40°		Beam Spread FC 60°	
	FC 25°	∅	FC 40°	∅	FC 60°	∅
3.0'	527.1	1.3'	328.0	2.2'	184.0	3.3'
6.0'	131.6	2.7'	70.0	4.4'	46.0	6.5'
9.0'	58.8	4.0'	30.1	6.6'	20.0	9.8'
12.0'	32.9	5.3'	16.8	8.7'	12.0	13.1'
14.0'	20.0	5.5'				
14.0'	10.0	5.9'				

## CANDELA TABULATION

Zone	Luminance (CD) Beam Spread	
	40°	60°
0.0	4318	1656
1.0	4218	1647
3.0	3783	1608
5.0	3157	1544
7.0	2481	1461
9.0	1876	1358
11.0	1368	1224
13.0	964	1067
15.0	667	906
17.0	459	753
19.5	290	575
22.5	171	394
25.5	108	259
29.0	71	154
33.0	49	84
37.5	37	45
42.5	30	29
47.5	26	23
55.0	22	18
65.0	17	13
75.0	13	9
85.0	6	6
90.0	0	0

## LUMINANCE DATA (CD./SQ.M.)

Angle	Beam Spread: 40°		
	Avg. 0-Deg	Avg. 45-Deg	Avg. 90-Deg
45	10249	10249	10249
55	9928	9928	9928
65	10412	10412	10412
75	13001	13001	13001
85	17819	17819	17819

Angle	Beam Spread: 60°		
	Avg. 0-Deg	Avg. 45-Deg	Avg. 90-Deg
45	9517	9517	9517
55	8123	8123	8123
65	7962	7962	7962
75	9000	9000	9000
85	17819	17819	17819

