

## PCT402-D10-ELV - 0-10V TO ELV DIMMING POWER PACK POWER PACK

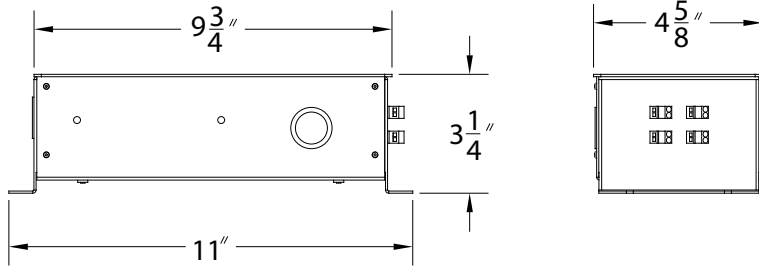

### SPECIFICATION

- 1,200W Total Wattage (300W x 4-Circuits)
- Can control up to 4-circuits at 300W Max Each (4 x 2.5 Amp. loads)
- Compatible with 0-10V analog lighting controllers and Energy Management systems.
- Compact size: 11.25" H x 4.5" W x 3.75" D
- Wall-Mount Aluminum Enclosure

**Application:** Remote Wall/Ceiling mounted power pack for use with 0-10V dimmers.

**Warranty:** Two Year Limited Warranty on Parts and Labor.

### COMPATIBILITY

 <a href="#">LTD7460</a> <b>APOLLO 60</b>	 <a href="#">LTD7450</a> <b>APOLLO 50</b>	 <a href="#">LTD7430</a> <b>APOLLO 30</b>
 <a href="#">LTD7415</a> <b>APOLLO 15</b>	 <a href="#">LTD7410</a> <b>APOLLO 10</b>	 <a href="#">LREBLD402</a> <b>REFLECTOR FLAT LENS (DIMMABLE)</b>
 <a href="#">LH99RICA-QC</a> <b>4" REMODEL HOUSING (QC)</b>	 <a href="#">LH7RICA-QC</a> <b>6" REMODEL HOUSING (QC)</b>	 <a href="#">LH7ICA-QC</a> <b>6" NEW CONSTRUCTION HOUSING (QC)</b>
 <a href="#">LH99ICA-QC</a> <b>4" NEW CONSTRUCTION HOUSING (QC)</b>		

Note: Wattage limitations on compatible items must be met.