

CH6IC : C-SERIES

6" TYPE IC DOWNLIGHT NEW CONSTRUCTION 1000LM - 3600LM (8W-39W)

- IC rated housing
- Twist and lock reflector for quick access to LED lamp array
- Heavy-duty self-flanged reflector
- Soft even lumen distribution
- No visible screws or hardware

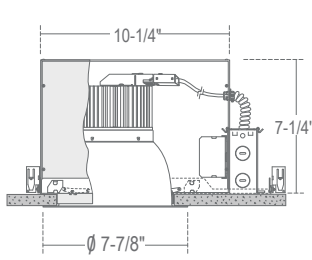

Ceiling Cut-Out: 6-3/8"
Ceiling Thickness: 1-1/4" Max.

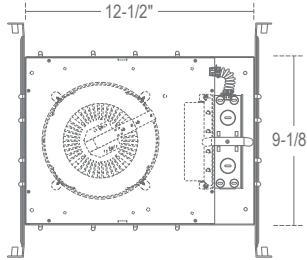

ORDERING – CH610ICUE-D10-EMAC/CR6L22SW-EMA-T30

[Click for Full Specification Details](#)

CH6xxIC
Housing Control Emergency Options J-Box / Reflector Reflector Finish Reflector Option CCT Options

Housing ¹	Reflector ¹	Reflector Finish	Reflector Option	CCT	Options
1000lm (8W) CH608IC [Options]	/CR6L22	Satin Haze Reflector/ White Finish	None Blank	2700K (84 CRI) -T27	None Blank
1800lm (16W) CH610IC [Options]	/CR6L22	White Finish	Integral EM -EMA³	3000K (84 CRI) -T30	4.5" Ceiling Thickness -CT4
2200lm (22W) CH618IC [Options]	/CR6L22	White Reflector/ White Finish	Switch	3500K (84 CRI) -T35	
2600lm (27W) CH628IC [Options]	/CR6L22			4000K (84 CRI) -T40	
3000lm (30W) CH629IC [Options]	/CR6L30	All Black		5000K (84 CRI) -T50	
3600lm (39W) CH639IC [Options]	/CR6L30	Clear Specular Reflector/White Finish			
		All Satin Haze Reflector Finish	SS		

Options

Control ²	Emergency Options ⁸	J-Box
0-10V Dimming	None	None Blank
UniDim™ 0-10V, TRIAC/ELV Dimming	10W Emergency Battery	Junction Box -CHP
TRIAC/ELV Dimming (120V)	Full Power	(Chicago Plenum)
Lutron Hi-Lume	Emergency Inverter	
Lutron EcoSystem		
0-10V Dimming (347V)	Full Power	
1%, 0-10V Dimming	Emergency Inverter (347V)	
0-10V Dimming with 10W Integral Emergency Battery Backup	GTD Device	
DMX Dimming with input via XLR5		
DMX Dimming with input via RJ45		
Athena Wireless Node (120V)		
Athena Wireless Node Occupancy Sensor (120V)		
UniSense - Remotely Mounted Motion/Photosensor (120V)		
UniSense - Remotely Mounted Motion/Photosensor		
Casambi Wireless Dimming		
BubblyNet Wireless System		
Lutron Vive Wireless Dimming Module		

¹ Housing must match corresponding Reflector in column to right.
² All drivers are 120V/277V unless otherwise noted.
³ (UE-D10-EMA) must be ordered with Integral EM Switch Option (-EMA).
⁴ Special Order.
⁵ (-SUN-RMT) sensor sent with mounting clips for existing ceiling applications.
⁶ (-347-D10) not available for CH608IC.
⁷ Check Wiring Diagrams.
⁸ All EM/EMAC/EMAC347/GTD must have access above ceiling.
⁹ UE-D10-EMA is not compatible with -EM or -EMAC or -EMAC347 or -GTD.

COMPATABILITY

VR800

Outdoor Vandal Resistant Ceiling/Wall Kit



P-CR672SW

Wall Wash for 6"



CR6-GSKT

6" Commercial Self-Adhesive Gasket

