

# WD1472 : 8" x 4" SCOOP

1-DIRECTIONAL WALL MOUNT (IP65) 850LM (15W)

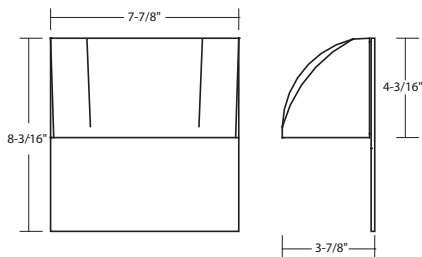

Shown with Signage Plate (-PL)

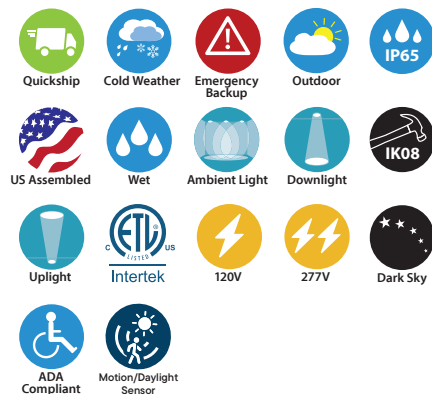

- Now with Integral Emergency Option!
- Sleek architectural design
- Durable, corrosion resistant finish
- Emergency back up available
- 5-year limited warranty
- IK08 Rated

## ORDERING : WD1472B-FRUE-D10-T30-BWW-EMB-FC-SDL

[Click for Full Specification Details](#)

### WD1472

Fixture	Finish	Lens	Control	LED	Optics	Emergency Options	Options
<b>Finish</b>			<b>Control</b>	<b>LED</b>		<b>Emergency Options</b>	
White (RAL 9003) <b>W</b>			Non-Dimming (120V)	4000K (90 CRI)		None	<b>Blank</b>
Silver (RAL 7037) <b>S</b>			ELV and Triac Dimming (120V)	3000K (90 CRI)		Remote Emergency	<b>-EMAC</b>
Bronze (RAL 8019) <b>BZ</b>			0-10V Dimming (120V/277V)	3500K (80 CRI)		BackPack (Side Mount)	<b>-EMB-SD</b>
Black (RAL 9005) <b>B</b>			UniDim™ 0-10V, ELV, Triac Dimming (120V/277V)			BackPack (Face Mount)	<b>-EMB-FC</b>
Light Silver (RAL 7036) <b>LS<sup>2</sup></b>			0-10V 1% Dimming (120V/277V)	<b>Optics</b>		BackPack (Empty, Side Mount)	<b>-EMB-BLANK-SD<sup>3</sup></b>
Dark Grey (RAL 7015) <b>DG<sup>2</sup></b>			0-10V Dimming (347V)	None		BackPack (Empty, Face Mount)	<b>-EMB-BLANK-FC<sup>3</sup></b>
Metallic Gold (RAL 1001) <b>MG<sup>2</sup></b>			UniSense - Integral Motion/Photosensor (120V)	Forward Throw (Type IV)			
Metallic Black (RAL 7021) <b>MB<sup>2</sup></b>			UniSense - Integral Motion/Photosensor (120V/277V)	Wall Wash			
			Casambi Wireless Dimming				
<b>Lens</b>			BubblyNet Wireless System			<b>Options</b>	
Clear			SimplySnap Wireless System			None	<b>Blank</b>
Frosted						Photocell Sensor	<b>-SDL</b>
						Color Changing	<b>-RGBW<sup>1</sup></b>
						Signage Plate	<b>-PL<sup>1</sup></b>
						Cold Weather	<b>-CW<sup>5</sup></b>
						Marine Grade Finish	<b>-MGD</b>

<sup>1</sup> Special order. Minimum order quantity, extended lead time, and setup fee may apply. Consult factory.  
<sup>2</sup> Special Order Finish. Minimum order quantity (MOQ) applies. Orders less than MOQ are subject to a special paint set-up fee for the quantity ordered. Extended lead times may apply. Consult Factory.  
<sup>3</sup> Blank EM enclosure available for Non-EM units to provide a seamless design aesthetic when EM enabled products are installed.  
<sup>4</sup> (-T35) 3500K is not available with (UE-D10P1) or (UE-DUN) dimming options.  
<sup>5</sup> (-CW) is not compatible with (-EMB-SD), (-EMB-FC), (UE-D10P1) for 3000K and 4000K, and (UE-D10) for 3500K.  
<sup>6</sup> (-SUN-INT) sensor integrated into the reflector. Consult Factory for layout assistance or alternate sensor mounting.  
<sup>7</sup> Special Order. Must be ordered with -EMB-BLANK.

Custom RAL Color: Please note that we appreciate custom finishes. Custom finishes are subject to a special paint setup fee for the quantity ordered. Extended lead times may apply. Consult Factory.